

# HSF

## NOTES:

Rated Current:1.0AMP  
Contact Resistance:20mΩ max  
Withstand Voltage:500V AC/DC  
Insulation Resistance:1000MΩ min  
Operation Temperature:-40℃ to +105℃

Contact Material:Brass  
Contact Plating:Au or Sn Over Ni  
Insulator Material:LCP+30%G.F UL94V-0

Recommended P.C.B Layout(Top Side)  
(PCB BOARD TOLERANCE±0.05)

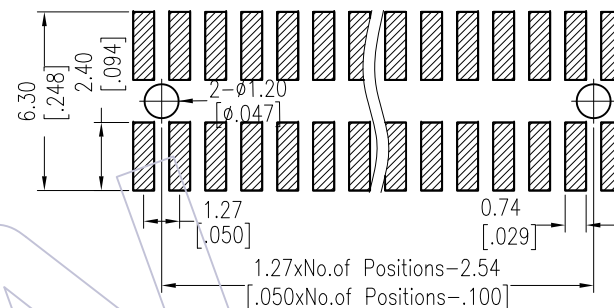
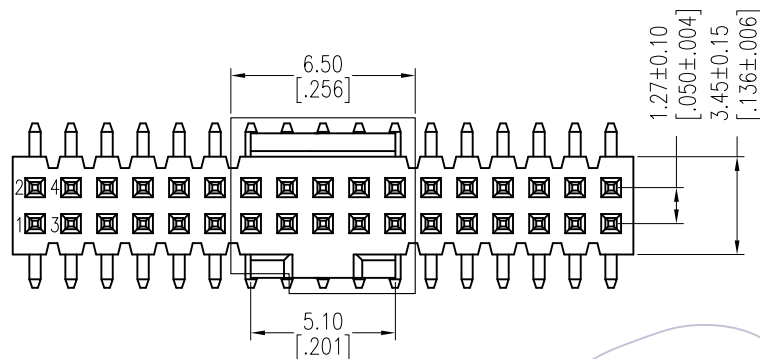

## Ordering Information

### 3132-XX M XX B K00 X X

No.of Pins	Contact Plating	Color Insulator	Packing	Series No.
10 34	G0=Gold Flash	B=Black	T=Tube	1=Type 1
14 40	G3=10u"Gold	W=White	P=Tube+CAP	2=Type 2
16 44	G4=15u"Gold		R=Tape&Reel+CAP	
20 50	G5=30u"Gold			
24 60	S0=Gold Flash/Tin			
26 64	S3=10u"Gold/Tin			
30 80	S4=15u"Gold/Tin			
32 100	S5=30u"Gold/Tin			
	SN=Tin			

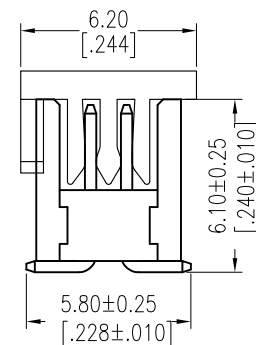
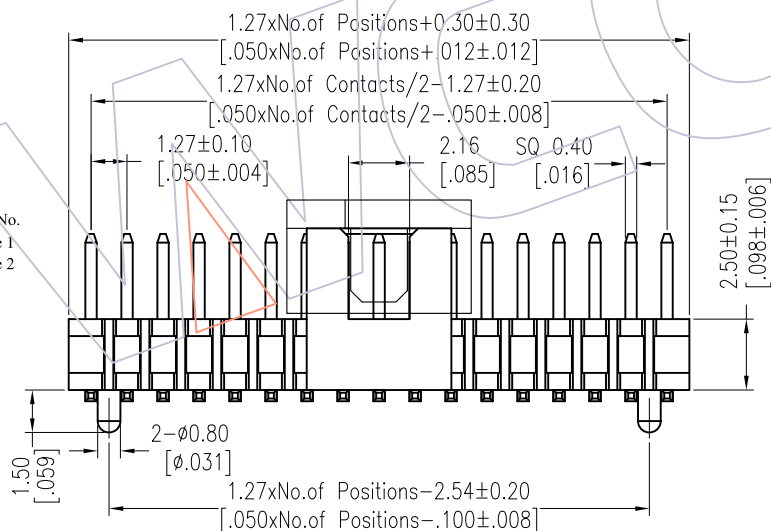

Type 1: W/O Post

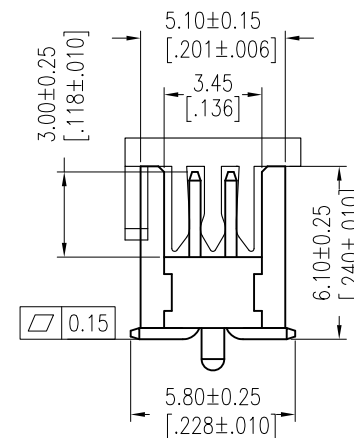

Type 2: With Post

Item	Pitch	Mating
Standard	1.27	5232
Alternate		

				OPERATION	DRAW	DATE	SCALE	FIT	PART NO.
				x.x ±0.40	JYHuang	2012/09/15	UNIT	mm	3132-XXMXXBK00XX
				x.xx ±0.25	CHECK	DATE	SIZE	A4	TITLE:
				x.xxx ±0.15	APPROVE	DATE	SHEET	1/1	1.27mm BOX SMT "S" TYPE H=6.10
AO	2012/09/18	NEW	-----	Angle ± 3'			PROJ.	⌀	Customer NO.
REV	DATE	MODIFICATION DESCRIPTION	CHANGE	DIM TOL					

# WCON

Http: www.wcon.com

WCON-Dongguan  
Tel: +86 769 85358920  
Fax: +86 769 85358915  
E-mail: sales@wcon.com

WCON-Kunshan  
Tel: +86 512 57468408  
Fax: +86 512 57468468  
E-mail: sales@wcon.com

## X-ON Electronics

Largest Supplier of Electrical and Electronic Components

*Click to view similar products for [I/O Connectors](#) category:*

*Click to view products by [Wcon](#) manufacturer:*

Other Similar products are found below :

[571763P](#) [61-168618-12P](#) [D20419-211](#) [72.250.1628.2](#) [72.250.2428.2](#) [76.350.0729.0](#) [76871-1403](#) [PCR-E36PM](#) [PCS-XE26LKA](#) [PCS-XES68MS+](#) [G38A71314B](#) [9776-18-6](#) [1571250010](#) [157-22500-3](#) [MS3471L14-19P L/C](#) [192991-0703](#) [91-644626-35P](#) [172501-6002](#) [FCN-260C008-A/L0](#) [FCN-260C024-AL0](#) [FCN-261Z008](#) [2000314-1](#) [200331-1](#) [PCS-E28FS+](#) [PCS-XE26SLFD+](#) [PCS-XE26SLFDT+](#) [G730VID08BDC24](#) [HDMR-29-01-S-SM-TR](#) [HDRA-E68W1LFDTC-SL+](#) [54182-0605](#) [UE86K842720321](#) [38113800006](#) [DP3AR020WQ1R200](#) [Z4.102.0680.0](#) [500-1040](#) [500-1052](#) [500-1054](#) [ZP-4008-66L](#) [10-565995-597N](#) [10-584459-12P](#) [5554841-1](#) [SM3106F14S-7S-LC](#) [SM3106R18-18S](#) [U90B3054061110](#) [U65-E04-4020](#) [ZPF000000000097891](#) [557-262M2-06C](#) [PCS-96LFD+](#) [60-042222-02S](#) [10099439-003C-TRLF](#)