

1 MATERIAL: LCP+30%G.F, UL94V-0; BLACK.
1.2 CAP: LCP+30%G.F, UL94V-0; BLACK.
1.3 CONTACT: PHOSPHOR BRONZE.

1.4 MOUNTING EAR: PHOSPHOR BRONZE.

2 FINISH:
2.1 CONTACT: 50" OR 50" MIN. GOLD PLATED IN CONTACT AREA
800" MIN. TIN PLATED IN SOLDER AREA
500" MIN. NICKEL UNDERPLATED OVERALL.

2.2 MOUNTING EAR: 1000" MIN. TIN PLATED OVER
500" MIN. NICKEL UNDERPLATED OVERALL.

3 ELECTRICAL CHARACTERISTICS

3.1 CURRENT RATING: 0.5A.

3.2 CONTACT RESISTANCE: 65mΩ MAX.

3.3 INSULATION RESISTANCE: 1000MΩ MIN DC500V.

3.4 DIELECTRIC WITHSTANDING VOLTAGE: 250V AC PER MINUTE.

3.5 OPERATING TEMPERATURE: -40C ~ +105C.

3.6 OPERATING: 100 CYCLES MIN.

3.7 INSERTION FORCE: 90g MAX. PER PIN PAIR.

3.8 WITHDRAWAL FORCE: 10g MIN. PER PIN PAIR.

3.9 CONTACT RETENTION FORCE: 250g MIN. PER CONTACT

3.10 STORAGE TEMPERATURE: -10C ~ +40C.

Flatness: <80Pins The "M" Is 0.10mm MAX

≥80Pins The "M" Is 0.15mm MAX

Ordering Information

3614-SXXX-XXX-XX R 02

No of Pins High "H" Contact Plating Packing
S1=3u"Gold/Tin R=Tape&Reel+CAP
S2=5u"Gold/Tin

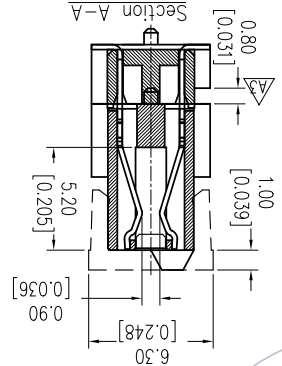
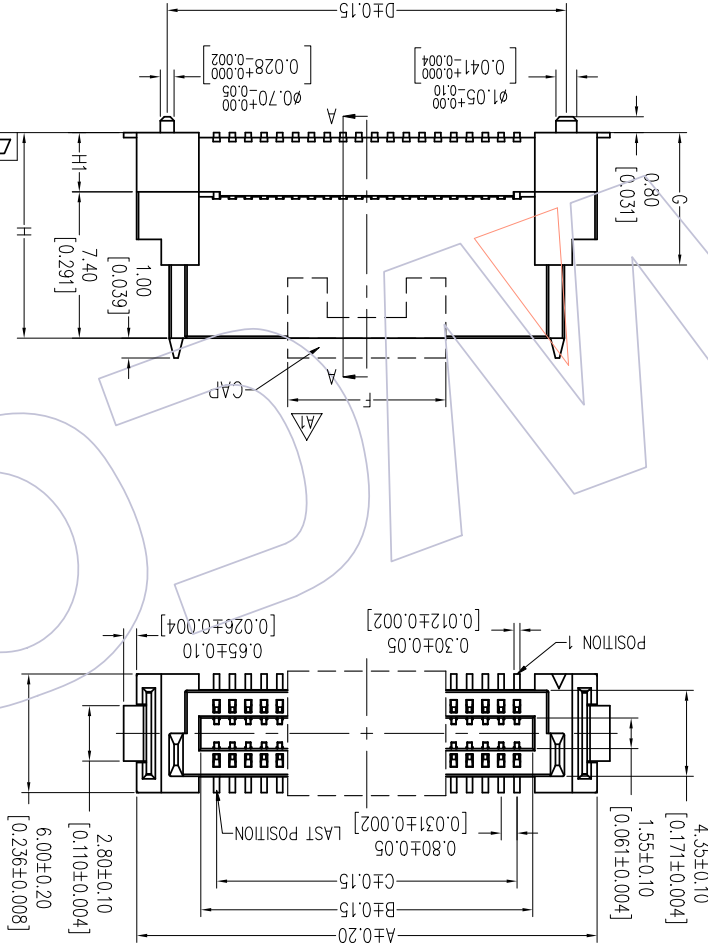

Dim H	Dim G	Dim H1
7.40	4.00	---
10.40	7.00	3.00
11.40	8.00	4.00
12.40	9.00	5.00
13.40	10.00	6.00

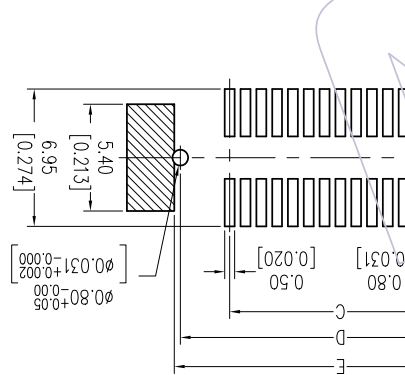

Cap Part No.	Dimension	F	Applicable Pins
CAP3614-G202	8.00		20~30
CAP3614-G203	16.00		40~50
CAP3614-G204	24.00		60~70
CAP3614-G205	32.00		80~90
CAP3614-G206	40.00		100~110~120

No. of Pins	A	B	C	D	E
20	15.30	8.80	7.20	12.20	12.80
30	19.30	12.80	11.20	16.20	16.80
40	23.30	16.80	15.20	20.20	20.80
50	27.30	20.80	19.20	24.20	24.80
60	31.30	24.80	23.20	28.20	28.80
80	39.30	32.80	31.20	36.20	36.80
100	47.30	40.80	39.20	44.20	44.80
120	55.30	48.80	47.20	52.20	52.80
160	71.30	64.80	63.20	68.20	68.80

REV	DATE	MODIFICATION DESCRIPTION	CHANGE	DIM	TOL	APPROVE	DATE	PROJ.	CUSTOMER NO.	Customer NO.	WCON-Dongguan	E-mail: sdies@wcon.com	Fax: +86 769 85358915	TEL: +86 769 85358920	WCON-Kunshan	TEL: +86 512 57468468	Fax: +86 512 57468468	E-mail: sdiesks@wcon.com
A3	2018/05/24	MODIFY	△	X.X	±0.40	Ding	2018/05/24		3614-SXXX-XXXXXR02	3614-SXXX-XXXXXR02	WCON-Dongguan	E-mail: sdies@wcon.com	Fax: +86 769 85358915	TEL: +86 769 85358920	WCON-Kunshan	TEL: +86 512 57468468	Fax: +86 512 57468468	E-mail: sdiesks@wcon.com
A2	2017/02/14	ADD CAP	△	X.XX	±0.25	CHECK												
A1	2016/10/11	更改CAP的长度	△	X.XXX	±0.15	APPROVE												
A0	2014/09/18	NEW	---	Angle	±.3	APPROVE												



Http: www.wcon.com

X-ON Electronics

Largest Supplier of Electrical and Electronic Components

Click to view similar products for [Headers & Wire Housings](#) category:

Click to view products by [Wcon](#) manufacturer:

Other Similar products are found below :

[95000-104TRLF](#) [10135584-644402LF](#) [DF62W-EP2022PCA](#) [95000-106TRLF](#) [DF62W-2022SCA](#) [DF62W-EP2022PC](#) [2203348](#) [DF62W-2022SC](#) [1084018](#) [1029039](#) [1084017](#) [802-10-012-10-002000](#) [1112640](#) [1112639](#) [891-007-9SS-BST1T](#) [000-34000](#) [0008550134](#) [0009482033](#) [0009507031](#) [57102-F02-18ULF](#) [57102-S06-03LF](#) [57202-S52-04LF](#) [PCN6-15S-2.5E](#) [0039019024](#) [58102-G61-06LF](#) [582553-1](#) [0009485154](#) [0009508121](#) [0022285053](#) [0050291907](#) [018731A](#) [LY20-4P-DT1-P1E-BR](#) [02.125.8002.8](#) [60101931](#) [60598-1 \(Cut Strip\)](#) [M1625-3R/100](#) [61062-3](#) [61082-181009](#) [CSU011177004](#) [636-1427](#) [638009-1](#) [641938-9](#) [641991-4](#) [644168-1](#) [644827-2](#) [647662-1](#) [65039-019ELF](#) [65692-001LF](#) [65781-018](#) [65781-047](#)