

# HSF

NOTE:

1.MATERIAL:

1.1 INSULATOR: LCP+30%G.F, UL94V-0; BLACK.

1.2 CAP: LCP+30%G.F, UL94V-0; BLACK.

1.3 CONTACT: PHOSPHOR BRONZE.

1.4 MOUNTING EAR: PHOSPHOR BRONZE.

2.FINISH:

2.1 CONTACT: 3u" OR 5u" MIN. GOLD PLATED IN CONTACT AREA

80u" MIN. TIN PLATED IN SOLDER AREA

50u" MIN. NICKEL UNDERPLATED OVERALL.

2.2 MOUNTING EAR: 100u" MIN. TIN PLATED OVER

50u" MIN. NICKEL UNDERPLATED OVERALL.

3.ELECTRICAL CHARACTERISTICS

3.1 CURRENT RATING: 0.5A.

3.2 CONTACT RESISTANCE: 65mΩ MAX.

3.3 INSULATION RESISTANCE: 1000MΩ MIN DC500V.

3.4 DIELECTRIC WITHSTANDING VOLTAGE: 250V AC PER MINUTE.

3.5 OPERATING TEMPERATURE: -40°C ~ +105°C.

3.6 OPERATING: 100 CYCLES MIN.

3.7 INSERTION FORCE: 90g MAX. Per PIN Pair.

3.8 WITHDRAWAL FORCE: 10g MIN. Per PIN Pair.

3.9 CONTACT RETENTION FORCE: 250g MIN. PER CONTACT

3.10 STORAGE TEMPERATURE: -10°C ~ +40°C.

Flatness: <80Pins The "M" Is 0.10mm MAX

≥80Pins The "M" Is 0.15mm MAX

## Ordering Information

3614- S XXX - XXX XX R 02

No. of Pins    High "H"    Contact Plating    Packing  
 S1=3u"Gold/Tin    R=Tape&Reel+CAP  
 S2=5u"Gold/Tin

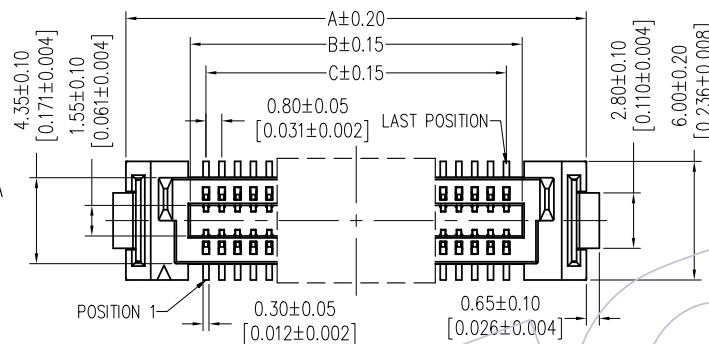

Recommended P.C.B Layout(Top Side)  
 (PCB BOARD TOLERANCE±0.05)

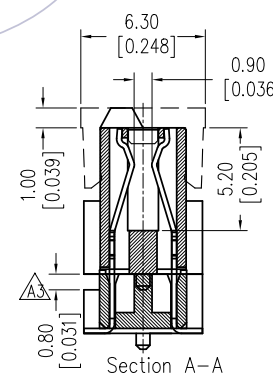
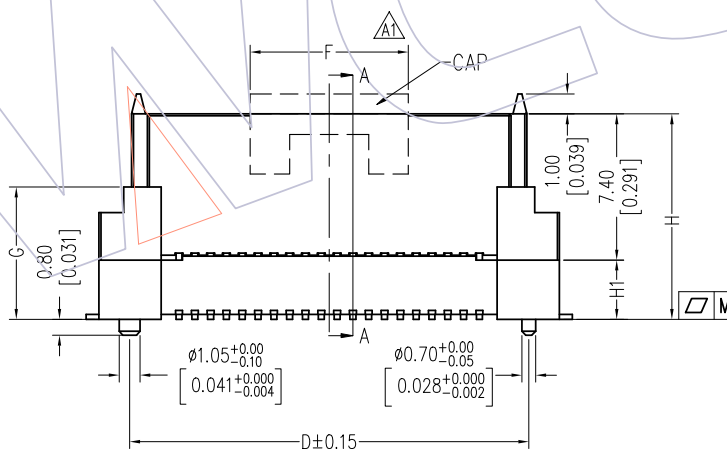
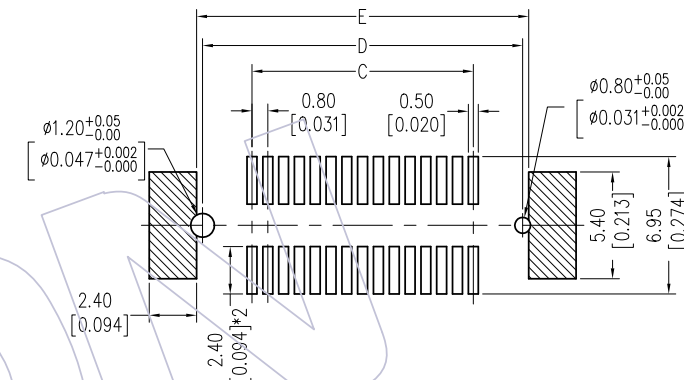

| Dim H | Dim G (+0.0/-0.40) | Dim H1 |
|-------|--------------------|--------|
| 7.40  | 4.00               | ---    |
| 10.40 | 7.00               | 3.00   |
| 11.40 | 8.00               | 4.00   |
| 12.40 | 9.00               | 5.00   |
| 13.40 | 10.00              | 6.00   |

| CAP PART NO. | Dimension |                 |
|--------------|-----------|-----------------|
|              | F         | Applicable Pins |
| CAP3614-G202 | 8.00      | 20~30           |
| CAP3614-G203 | 16.00     | 40~50           |
| CAP3614-G204 | 24.00     | 60~70           |
| CAP3614-G205 | 32.00     | 80~90           |
| CAP3614-G206 | 40.00     | 100~110~120     |

| No. of Pins | Dimension |       |       |       |       |
|-------------|-----------|-------|-------|-------|-------|
|             | A         | B     | C     | D     | E     |
| 20          | 15.30     | 8.80  | 7.20  | 12.20 | 12.80 |
| 30          | 19.30     | 12.80 | 11.20 | 16.20 | 16.80 |
| 40          | 23.30     | 16.80 | 15.20 | 20.20 | 20.80 |
| 50          | 27.30     | 20.80 | 19.20 | 24.20 | 24.80 |
| 60          | 31.30     | 24.80 | 23.20 | 28.20 | 28.80 |
| 80          | 39.30     | 32.80 | 31.20 | 36.20 | 36.80 |
| 100         | 47.30     | 40.80 | 39.20 | 44.20 | 44.80 |
| 120         | 55.30     | 48.80 | 47.20 | 52.20 | 52.80 |
| 160         | 71.30     | 64.80 | 63.20 | 68.20 | 68.80 |

| REV | DATE       | MODIFICATION DESCRIPTION | CHANGE | OPERATION   | DRAW    | DATE       | SCALE | FIT          | PART NO.  |
|-----|------------|--------------------------|--------|-------------|---------|------------|-------|--------------|---|
| A3  | 2018/05/24 | MODIFY                   | △      | OPERATION   | Draw    | 2018/05/24 | SCALE | FIT          | 3614-SXXX-XXXXR02   |
| A2  | 2017/02/14 | ADD CAP                  | △      | x.x ±0.40   | Check   | DATE       | UNIT  | mm           | TITLE:<br>0.80mm BTB FEMALE "D" TYPE<br>180° SMT (W/O BUMP) |
| A1  | 2016/10/11 | 更改CAP的长度                 | △      | x.xx ±0.25  | APPROVE | DATE       | SIZE  | A4           |   |
| A0  | 2014/09/18 | NEW                      | —      | x.xxx ±0.15 | DATE    | DATE       | SHEET | 1/1          |   |
| REV | DATE       | MODIFICATION DESCRIPTION | CHANGE | Angle ± 3'  | DIM     | TOL        | PROJ. | Customer NO. |   |

# WCON

Http: www.wcon.com

WCON-Dongguan    WCON-Kunshan  
 Tel: +86 769 85358920    Tel: +86 512 57468408  
 Fax: +86 769 85358915    Fax: +86 512 57468468  
 E-mail: sales@wcon.com    E-mail: salesks@wcon.com

## X-ON Electronics

Largest Supplier of Electrical and Electronic Components

*Click to view similar products for [Board to Board & Mezzanine Connectors](#) category:*

*Click to view products by [Wcon](#) manufacturer:*

Other Similar products are found below :

[589158040000018](#) [MDF7C-18P-2.54DSA\(55\)](#) [FCN-268F036-G/BD](#) [FCN-268M012-G/0D](#) [FCN-268M024-G/1D](#) [FCN-723J004/1](#) [MIS-048-01-F-D-DP-K](#) [832-10-034-10-001000](#) [FX4C-80S-1.27DSA](#) [93696-330](#) [224393](#) [FCN-235D050-G/C](#) [210-93-314-41-105000](#) [2-22603-0](#) [MDF7-40DP-2.54DSA\(55\)](#) [5031084030](#) [MIT-114-03-F-D-K](#) [55323-1519](#) [45970-4130](#) [YFT-20-05-H-03-SB-K](#) [503308-3040](#) [026-6203-PDB](#) [027-6203-PDB](#) [069159702701000](#) [101A10019X](#) [105061100000861+](#) [55650-0588-C](#) [75140-7012](#) [87471-650](#) [YTW-30-07-H-Q-410-140](#) [YTT-112-01-H-Q](#) [063209](#) [0717420006](#) [FCN-268F024-G0D](#) [10124054-515LF](#) [68685-603](#) [8-1616154-3](#) [MIS-019-01-F-D](#) [YTQ-11201HQ](#) [IL-WX-10PB-HF-B-E1000E](#) [YFT-50-05-H-10-SB-K](#) [FCN-268M024-G/3D](#) [MDF7-16DP-2.54DSA\(55\)](#) [AXE810124](#) [FCN-214J100-G/0](#) [FCN-230C068-E/S](#) [AXE812124](#) [74220-001](#) [354184](#) [P50-028-DDS-TG](#)