

NOTES:
 Voltage Rating: 50V AC/DC
 Current Rating: 0.5AMP
 Contact Resistance: 20mΩ max
 Withstand Voltage: 500V AC/Minute
 Insulation Resistance: 500MΩ min
 Operation Temperature: -40°C to +105°C

Contact Material: Phosphor Bronze
 Contact Plating: 100~200μ" Tin Plated Over
 50~80μ" Nickel
 Insulator Material: PA9T+33%GF UL94V-0 BLACK

Ordering Information

- No. of Pins
- 004: 04 Pin
- 005: 05 Pin
- 006: 06 Pin
- 007: 07 Pin
- 008: 08 Pin
- 010: 10 Pin
- 017: 17 Pin
- 020: 20 Pin
- G0=Gold Flash
- G3=10μ"Gold
- G4=15μ"Gold
- G5=30μ"Gold
- SN=Tin
- Packing
- R=Tape&Reel

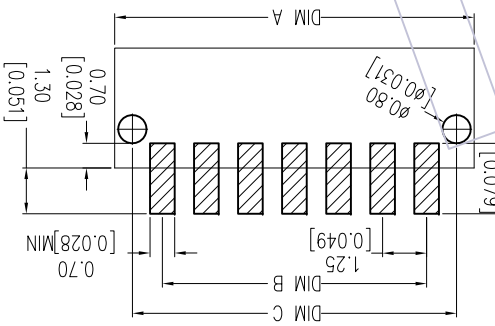
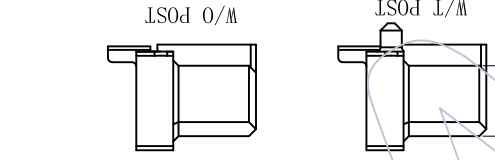
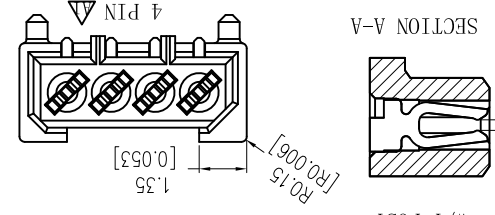
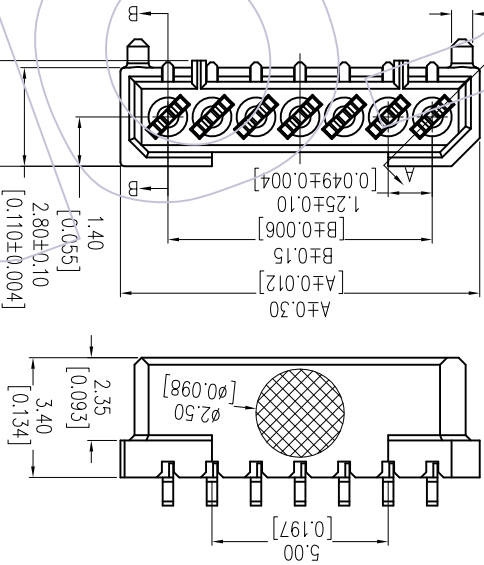
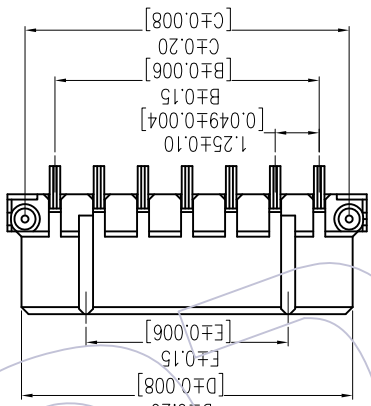
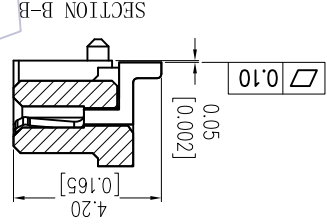
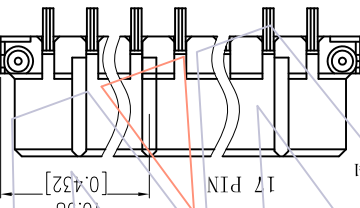
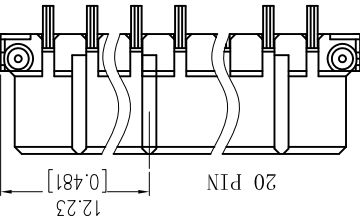
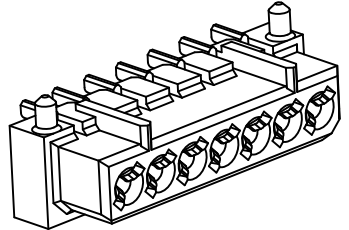

PIN 数	A	B	C	D	E
4	6.45	3.75	5.45	5.65	1.99
5	7.70	5.00	6.70	6.90	3.24
6	8.95	6.25	7.95	8.15	4.49
7	10.20	7.50	9.20	9.40	5.74
8	11.45	8.75	10.45	10.65	6.99
10	13.95	11.25	12.95	13.15	9.49
17	22.70	20.00	21.70	21.90	18.24
20	26.45	23.75	25.45	25.65	21.99

W/O POST	3652-S-XXX-034SNR01
W/T POST	3652-S-XXX-034SNR02

REV	DATE	MODIFICATION DESCRIPTION	CHANGE	DIM		APPROVE	DATE	DRAW	DATE	SCALE	FIT	PART NO.	TITLE:	Customer NO.	PROJ.
				Angle	TOL										
A0	2016.10.20	NEW	---	±.3	±.15	Ding	2017.12.19	3652-SXXX-034SNR0X	mm	mm	mm	1.25mm BTP FEMALE, 90° SMT H=3.4	WCON-Dongguan	WCON-Kunshan	WCON-Donqun
A1	2017.12.19	Modify	---	X.XXX	±0.15								Http: www.wcon.com	Tel: +86 769 85358915	Fax: +86 512 57468468
				X.XX	±0.25								Http: www.wcon.com	Tel: +86 769 85358920	Fax: +86 512 57468468
				X.X	±0.40								Http: www.wcon.com	Tel: +86 769 85358915	Fax: +86 512 57468468

Recommended P.C.B Layout (Top Side)
 (PCB BOARD TOLERANCE ±0.05)



WCON-Dongguan
 Http: www.wcon.com
 WCON-Kunshan

Customer NO.
 WCON-Dongguan
 Http: www.wcon.com
 WCON-Kunshan
 Tel: +86 769 85358920
 Fax: +86 512 57468468
 E-mail: sales@wcon.com
 E-mail: sales@wcon.com

X-ON Electronics

Largest Supplier of Electrical and Electronic Components

Click to view similar products for [Headers & Wire Housings](#) category:

Click to view products by [Wcon](#) manufacturer:

Other Similar products are found below :

[95000-104TRLF](#) [10135584-644402LF](#) [DF62W-EP2022PCA](#) [95000-106TRLF](#) [DF62W-2022SCA](#) [DF62W-EP2022PC](#) [2203348](#) [DF62W-2022SC](#) [1084018](#) [1029039](#) [1084017](#) [802-10-012-10-002000](#) [1112640](#) [1112639](#) [891-007-9SS-BST1T](#) [000-34000](#) [0008550134](#) [0009482033](#) [0009507031](#) [57102-F02-18ULF](#) [57102-S06-03LF](#) [57202-S52-04LF](#) [PCN6-15S-2.5E](#) [0039019024](#) [58102-G61-06LF](#) [582553-1](#) [0009485154](#) [0009508121](#) [0022285053](#) [0050291907](#) [018731A](#) [LY20-4P-DT1-P1E-BR](#) [02.125.8002.8](#) [60101931](#) [60598-1 \(Cut Strip\)](#) [M1625-3R/100](#) [61062-3](#) [61082-181009](#) [CSU011177004](#) [636-1427](#) [638009-1](#) [641938-9](#) [641991-4](#) [644168-1](#) [644827-2](#) [647662-1](#) [65039-019ELF](#) [65692-001LF](#) [65781-018](#) [65781-047](#)