

HSF

Recommended P.C.B Layout(Top Side)
(PCB BOARD TOLERANCE±0.05)

NOTES:
 Current Rating: 1.0AMP
 Contact Resistance: 20mΩ Max
 Withstand Voltage: 500V AC/DC
 Insulation Resistance: 1000MΩ Min
 Operation Temperature: -40℃ to +105℃

Contact Material:Phosphor Bronze
 Contact plating:Sn Over Ni
 Insulator Material:PBT+30%G.F UL94V-0

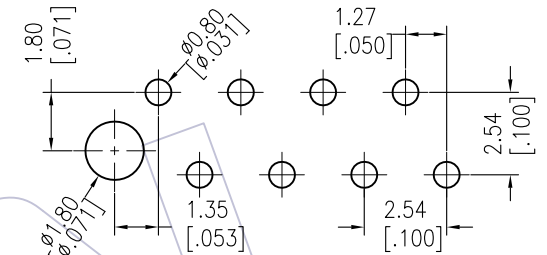
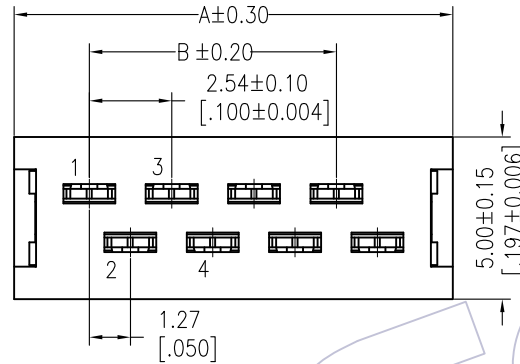

Ordering Information

3900 -XX MI XX A N T 01

No.of pins
 04P 12P
 06P 14P
 08P 16P
 10P 18P
 20P

Contact Plating
 SN=Tin

Packing
 T=Tube

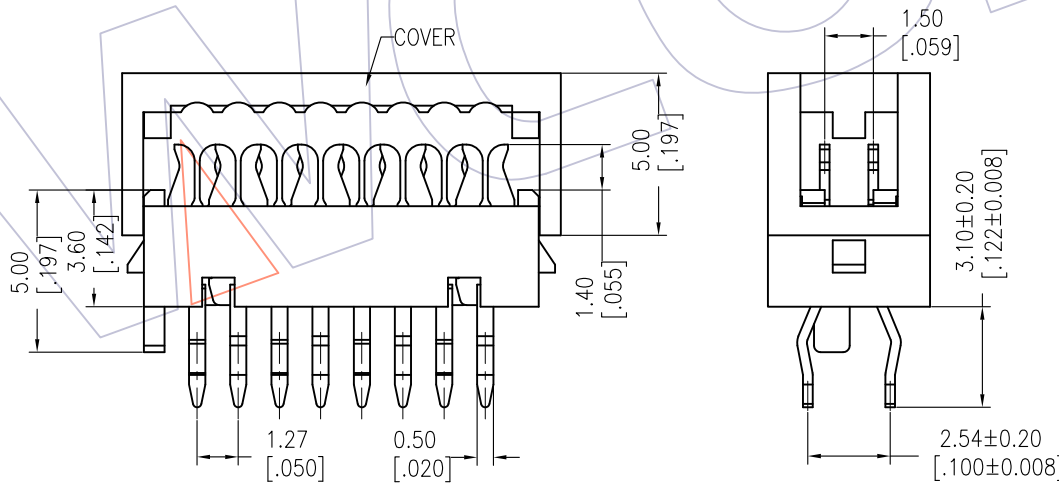

Dimensional & Ordering Information

Circuit	Part No.	Dimension		Q'TY /Tube
		A	B	
04	3900-04MISNANT01	8.45	2.54	69pcs
06	3900-06MISNANT01	10.99	5.08	53pcs
08	3900-08MISNANT01	13.53	7.62	43pcs
10	3900-10MISNANT01	16.07	10.16	36pcs
12	3900-12MISNANT01	18.61	12.70	31pcs
14	3900-14MISNANT01	21.15	15.24	27pcs
16	3900-16MISNANT01	23.69	17.78	24pcs
18	3900-18MISNANT01	26.23	20.32	22pcs
20	3900-20MISNANT01	28.77	22.86	20pcs

REV	DATE	MODIFICATION DESCRIPTION	CHANGE	OPERATION	DRAW	DATE	SCALE	FIT	PART NO.
A2	2018/05/15	MINI MATCH--1.27mm MRC Connector	-----	x.X ±0.40	Ding	2018/05/15	UNIT	mm	SEE TABLE
A1	2014/05/28	Micro Match --Mini Match	-----	x.XX ±0.25	CHECK	DATE	SIZE	A4	TITLE: 1.27mm MRC Connector DIP Plug IDC TYPE
A0	2012/10/11	NEW	-----	x.XXX ±0.15	APPROVE	DATE	SHEET	1/1	Customer NO.
				Angle ± 3'			PROJ.		
				DIM TOL					

WCON
 Http: www.wcon.com

WCON-Dongguan
 Tel: +86 769 85358920
 Fax: +86 769 85358915
 E-mail: sales@wcon.com

WCON-Kunshan
 Tel: +86 512 57468408
 Fax: +86 512 57468468
 E-mail: salesks@wcon.com

X-ON Electronics

Largest Supplier of Electrical and Electronic Components

Click to view similar products for [Headers & Wire Housings](#) category:

Click to view products by [Wcon](#) manufacturer:

Other Similar products are found below :

[57102-F02-18ULF](#) [58102-G61-06LF](#) [582553-1](#) [009176003701906](#) [0050291907](#) [02.125.8002.8](#) [609-3404](#) [61062-3](#) [622-0430](#) [622-3653LF](#)
[63453-116](#) [636-1030](#) [636-1427](#) [636-3427](#) [636-4007](#) [641938-9](#) [65495-038](#) [65692-001LF](#) [65781-018](#) [65781-047](#) [65817-010LF](#) [65817-015LF](#)
[66207-023LF](#) [67016-026LF](#) [67095-007LF](#) [68631-112](#) [68645-018](#) [68648-049](#) [699319-000](#) [M90C108951C](#) [70.362.1628.0](#) [70-4210](#) [70-4226B](#)
[70-4853B](#) [707-5020](#) [707-5028](#) [71.350.2428.0](#) [71961-016LF](#) [733-134](#) [754199-000](#) [760-3052](#) [787-8014-00](#) [FCN-367T-T012/H](#)
[80.063.4001.1](#) [800-90-001-10-001000](#) [801-43-002-10-013000](#) [801-43-006-10-002000](#) [803-41-018-10-001000](#) [803-43-014-20-001000](#)
[803-43-024-10-001000](#)