

NOTES:
 Current Rating: 3.0AMP
 Contact Resistance: 20mΩ Max
 Withstand Voltage: 500V AC/DC
 Insulation Resistance: 1000MΩ Min
 Operation Temperature: -55°C to +105°C
 Contact Material: Phosphor Bronze/Brass
 Contact plating: Sel.Au over Ni
 Insulator Material: PT+30%G.F UL94V-0
 Sheel: Cold Roller Steel, Ni Plated
 Nut: Brass, Sn over Ni Plated

Ordering Information

6224-XX M N XX X 0 X

No. of Pins 09, 15, 25, 37P
 S0=Gold Flash/Ni B:Black 1=W/O Screw thread(three part)
 U:Blue 2=W/T Screw thread(three part)
 S3=10u"Gold/Ni 3=W/O Screw thread(two part)
 S4=15u"Gold/Ni 4=W/T Screw thread(two part)
 S5=30u"Gold/Ni 5=W/T Screw thread, Don't lock(two part)
 6=W/T Screw thread&Nut, Don't lock (two part)

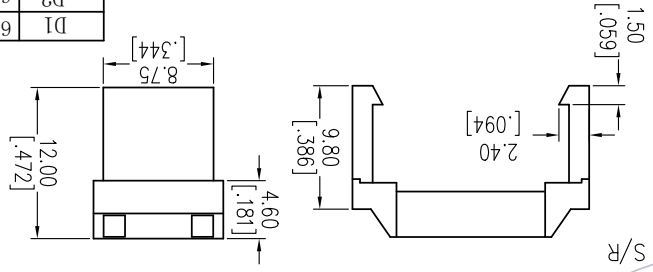
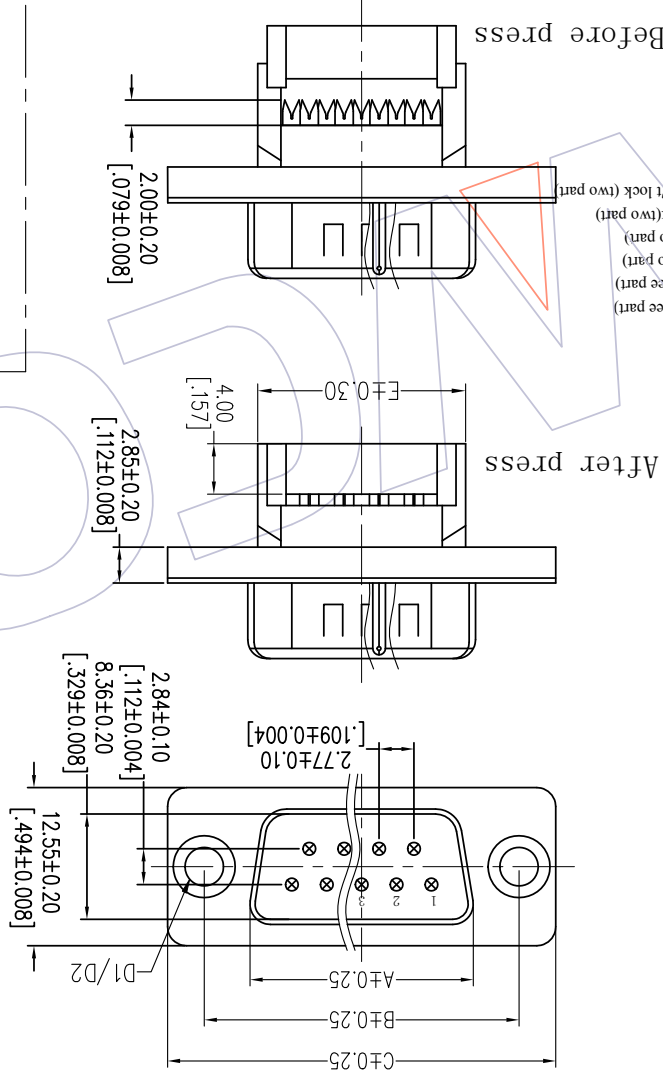

No. of Positions		DIM "A"	DIM "B"	DIM "C"	DIM "D1"	DIM "D2"	DIM "E"
09	17.78	24.99	30.82	16.90			
15	26.15	33.32	39.24	25.60			
25	39.94	47.04	53.04	38.90			
37	56.56	63.50	69.62	55.60			

W/O Screw thread		W/T Screw thread	
09	17.78	24.99	30.82
15	26.15	33.32	39.24
25	39.94	47.04	53.04
37	56.56	63.50	69.62

D1		D2	
6224-XXMNXXX01/3		6224-XXMNXXX02/4	

REV	DATE	MODIFICATION DESCRIPTION	CHANGE	OPERATION		DRAW	DATE	SCALE	FIT	PART NO.	SEE TABLE	TITLE:	Customer NO.		PROJ.	
				Angle	DIM								APPROVE	DATE		SHEET
A3	2019/07/30	Modify	△	X.X	±0.40	Ding	2019/07/30									
A2	2017/03/01	Modify	△	X.XX	±0.25											
A1	2015/12/14	Modify	△	X.XXX	±0.15											
A0	2012/12/06	NEW	---													

WCON-Dongguan
 WCON-Kunshan
 Tel: +86 769 85358920
 Fax: +86 512 57468408
 E-mail: sdies@wcon.com
 E-mail: sdiesks@wcon.com
 Http: www.wcon.com



X-ON Electronics

Largest Supplier of Electrical and Electronic Components

Click to view similar products for [wcon](#) manufacturer:

Other Similar products are found below :

[2185-140SG0AYNT1](#) [1125-1206G0S155C002](#) [2263-205SG0DYNT6](#) [2185-207ZG0CYNT1](#) [2157-140SG0CYNT1](#) [1125-2212G0S280C001](#)
[WF2543-1H03B01](#) [WF2543-1H04B01](#) [1220-1210G0M087P1](#) [WF2543-1H07B01](#) [2185DN1-205SG0CYNT1](#) [3622-S040-027G1R02](#) [2263-222RG0DYNT1](#) [1215-2114G0S076C002](#) [1325-1208G0Z093CT01](#) [1125-2208G0S360C001](#) [2220T-206MS0CUNT2](#) [3622-P040-038G1R02](#)
[WF1501-WM09ER1](#) [1125-1206G0M113CR01](#) [WF2005-2H09W01](#) [6223-09FMNS0B02](#) [6212-26FHS0B01](#) [3220-20SW0BST1](#) [WF2005-WR02ET2](#) [2185DN2-106SG0CYNT1](#) [2185-240SG0AYNT1](#) [2111P-232SG0FYNT4](#) [3111-20MSNBK00R1](#) [1125-2205G0S210C001](#) [2185-208SS0CYNT1](#) [2159-213RG0CUNT1](#) [2263D-204SG0DYNT6](#) [2185-209SS1CYNT2](#) [2211-112MG0CYNR4](#) [2227T-204MG3CUNR1](#) [2185-210SG0CYNR1](#) [6212-26MHS0B01](#) [3610-S020-040G1R01](#) [WF3001-2WR03BA1](#) [WF1001A-WZ06ET1](#) [6321D-040SDS1PNT01](#) [2185-208SSNCYNT1](#) [6320D-040RDS1PNT01](#) [WF2547-2H06B01](#) [2135-207MH3CUNR3](#) [2243-211WG0CUNT2](#) [2185-104ZG0CYNR1](#) [2272-209RG0CUNT1](#) [WF2549-2WS10S0B01](#)