

NOTES:

Current Rating: 1AMP
 Contact Resistance: 5mΩ max
 Withstand Voltage: 500V AC/DC
 Insulation Resistance: 1000MΩ min
 Operation Temperature: -55°C to +105°C
 Contact Material: Phosphor Bronze
 Contact plating: Au or Sn over Ni
 Shell Material: SPC, t=0.50mm
 Housing Material: PB1+30%GF(UL94V-0)
 Cover Material: LCP+30%GF(UL94V-0)

Ordering Information
 6320M-XXXSXXMNA01

No. of Pins: Contact Plated:
 014=14P
 020=20P
 S1=3u" Gold/Tin
 S2=5u" Gold/Tin
 S3=10u" Gold/Tin
 S4=15u" Gold/Tin
 S5=30u" Gold/Tin
 040=40P
 050=50P
 068=68P
 080=80P
 100=100P

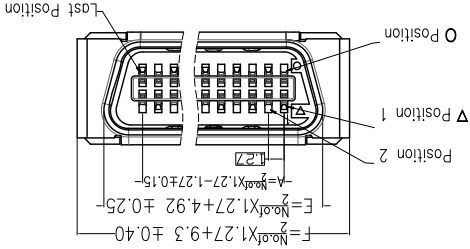

PART NO.	PN	A	E	F	G
6320M-014SSXXMNA01	14P	7.62	13.81	18.19	17.14
6320M-020SSXXMNA01	20P	11.43	17.62	22.00	20.95
6320M-026SSXXMNA01	26P	15.24	21.43	25.81	24.76
6320M-036SSXXMNA01	36P	21.59	27.78	32.16	31.11
6320M-040SSXXMNA01	40P	24.13	30.32	34.70	33.65
6320M-050SSXXMNA01	50P	30.48	36.67	41.05	40.00
6320M-068SSXXMNA01	68P	41.91	48.10	52.48	51.43
6320M-080SSXXMNA01	80P	49.53	55.72	60.10	59.05
6320M-100SSXXMNA01	100P	62.23	68.42	72.80	71.75

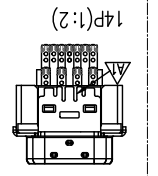
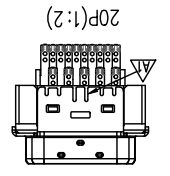
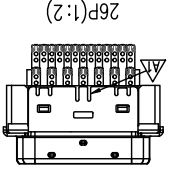
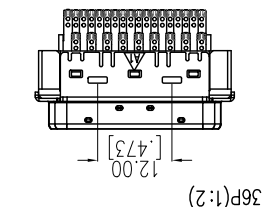
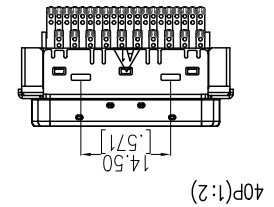
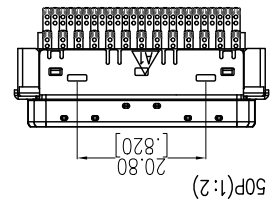
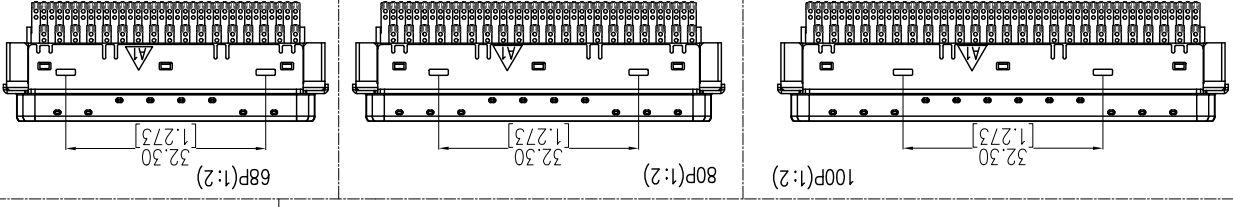
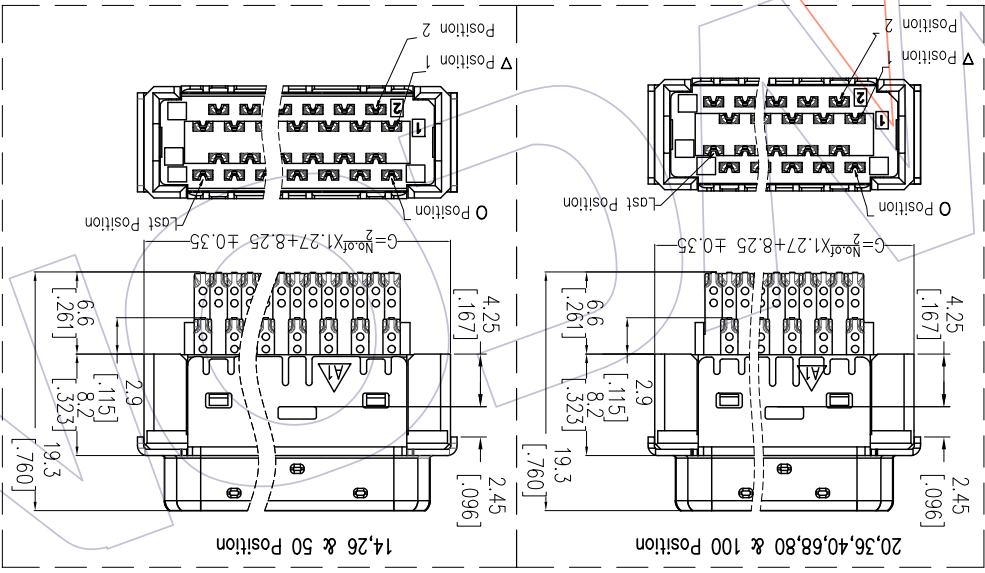
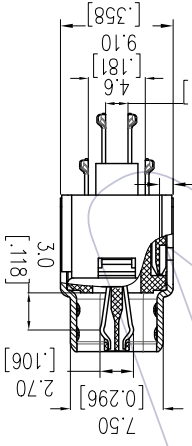

REV	DATE	MODIFICATION DESCRIPTION	CHANG	OPERATION	DRAW	DATE	SCALE	PART NO.	6320M-XXXSSXXMNA01	TITLE:	1.27mm MDR SCSI Male (Soldering Type)	Customer NO.
A0	2019/06/06	NEW			APPROVE	DATE	SHEET 1/1	PROJ.				
A1	2019/09/20	MODIFY			CHECK	DATE	SIZE A4	UNIT Inch				
					XSR	2019/09/20	mm	DATE				
					OPERATION	DATE	SCALE FIT	DATE				
					±0.40							
					X.X							
					±0.25							
					±0.15							
					Angle							
					± 3°							

WCON
 WCON-Dongguan
 WCON-Kunshan
 Http: www.wcon.com
 Tel: +86 769 85358920
 Fax: +86 769 85358915
 Tel: +86 512 57468408
 Fax: +86 512 57468468
 E-mail: sdteks@wcon.com

X-ON Electronics

Largest Supplier of Electrical and Electronic Components

Click to view similar products for [wcon](#) manufacturer:

Other Similar products are found below :

[2185-140SG0AYNT1](#) [1125-1206G0S155C002](#) [2263-205SG0DYNT6](#) [2185-207ZG0CYNT1](#) [2157-140SG0CYNT1](#) [1125-2212G0S280C001](#)
[WF2543-1H03B01](#) [WF2543-1H04B01](#) [1220-1210G0M087P1](#) [WF2543-1H07B01](#) [2185DN1-205SG0CYNT1](#) [3622-S040-027G1R02](#) [2263-222RG0DYNT1](#) [1215-2114G0S076C002](#) [1325-1208G0Z093CT01](#) [1125-2208G0S360C001](#) [2220T-206MS0CUNT2](#) [3622-P040-038G1R02](#)
[WF1501-WM09ER1](#) [1125-1206G0M113CR01](#) [WF2005-2H09W01](#) [6223-09FMNS0B02](#) [6212-26FHS0B01](#) [3220-20SW0BST1](#) [WF2005-WR02ET2](#) [2185DN2-106SG0CYNT1](#) [2185-240SG0AYNT1](#) [2111P-232SG0FYNT4](#) [3111-20MSNBK00R1](#) [1125-2205G0S210C001](#) [2185-208SS0CYNT1](#) [2159-213RG0CUNT1](#) [2263D-204SG0DYNT6](#) [2185-209SS1CYNT2](#) [2211-112MG0CYNR4](#) [2227T-204MG3CUNR1](#) [2185-210SG0CYNR1](#) [6212-26MHS0B01](#) [3610-S020-040G1R01](#) [WF3001-2WR03BA1](#) [WF1001A-WZ06ET1](#) [6321D-040SDS1PNT01](#) [2185-208SSNCYNT1](#) [6320D-040RDS1PNT01](#) [WF2547-2H06B01](#) [2135-207MH3CUNR3](#) [2243-211WG0CUNT2](#) [2185-104ZG0CYNR1](#) [2272-209RG0CUNT1](#) [WF2549-2WS10S0B01](#)