

# HSF

**NOTES:**

Current Rating: 1.0AMP  
 Contact Resistance: 20mΩ Max  
 Withstand Voltage: 500V AC/DC  
 Insulation Resistance: 1000MΩ Min  
 Operation Temperature: -40°C to +105°C

Contact Material: Phosphor Bronze  
 Contact plating: Au Or Sn over Ni  
 Insulator Material: PBT+30%G.F UL94V-0

## Ordering Information

5222-XX Y P XX B X 0 1

Two Parts  
 Conn+Cover 06P 20P No. of Pins Contact Plating Color Insulator Bump  
 08P 30P S0=Gold Flash/Ni B=Black N=W/O Bump  
 10P 34P S3=10u"Gold/Ni G=Grey(427C) W=With Bump  
 12P 36P S4=15u"Gold/Ni  
 14P 40P S5=30u"Gold/Ni  
 16P 44P  
 18P 44P  
 20P 60P  
 22P 64P  
 24P

Item	Pitch	Mating
Standard	2.00	3111/3220
Alternate		

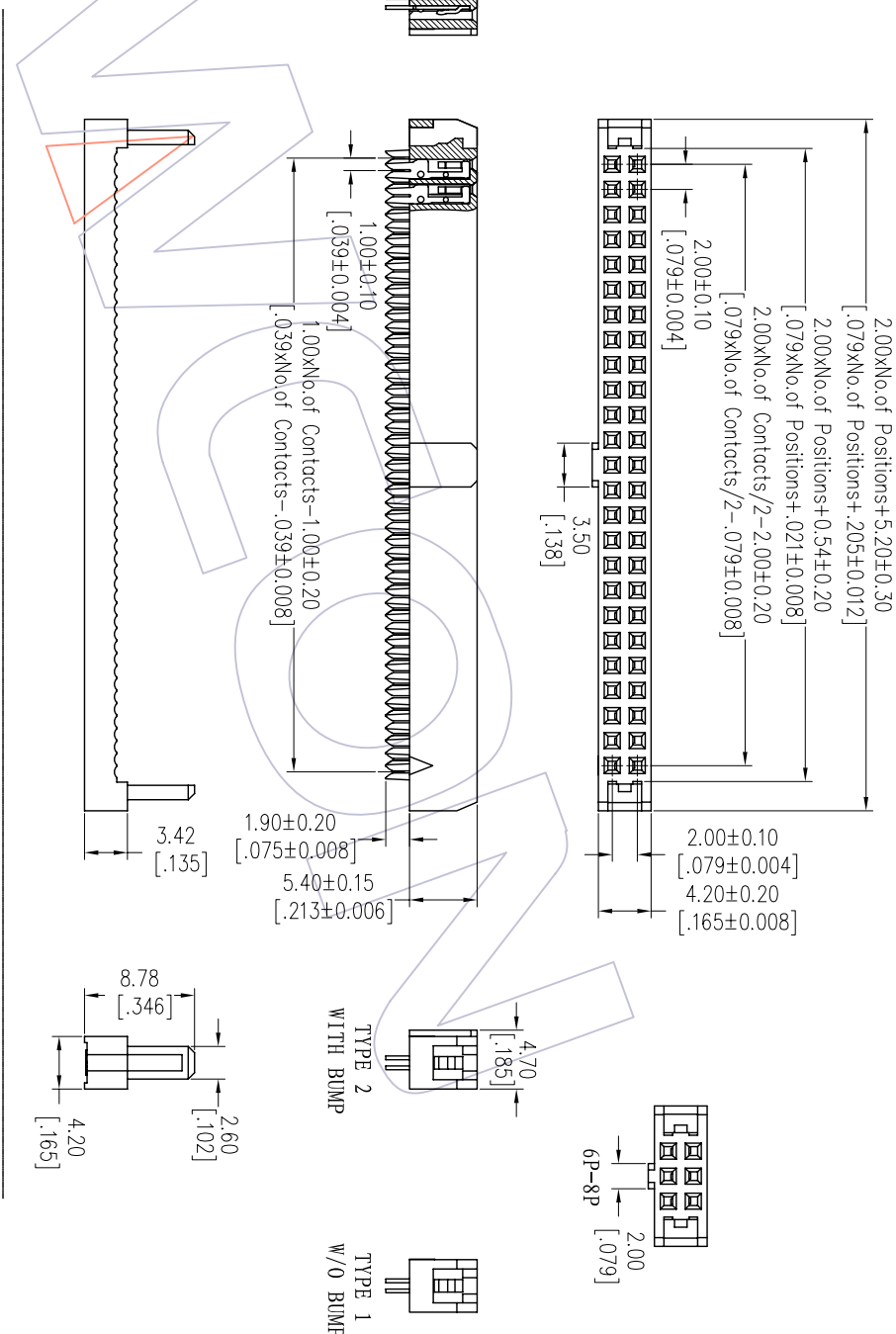

SR P/N: G5220-XXDX01

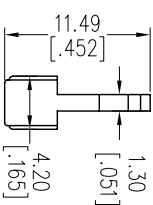
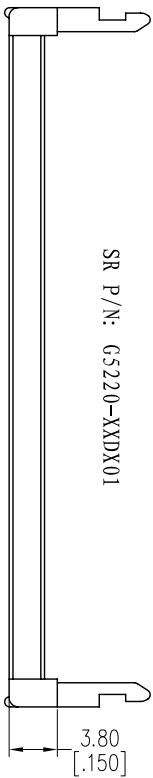

TYPE	PART NO.
TYPE 1	5222-XXYPXXBN01
TYPE 2	5222-XXYPXXBW01

REV	DATE	MODIFICATION DESCRIPTION	CHANGE
A0	2012/10/10	NEW	

OPERATION	DRAW	DATE	SCALE	FIT
XX	JYHuong	2012/10/10	UNIT	mm
XX XX	CHECK	DATE	SIZE	A4
X XXX	±0.25		SHEET	1/1
Angle	±0.15		PROJ.	
± 3°				
TOL	APPROVE	DATE		

PART NO.	SEE TABLE
TITLE:	2.00 IDC SOCKET+SR (ONE SLIDE CONTACT)
Customer NO.	

**WCON**

Http: www.wcon.com

WCON-Dongguan  
 Tel: +86 769 85358920  
 Fax: +86 769 85358915  
 E-mail: sales@wcon.com

WCON-Kunshan  
 Tel: +86 512 57468408  
 Fax: +86 512 57468468  
 E-mail: sales@wcon.com

## X-ON Electronics

Largest Supplier of Electrical and Electronic Components

*Click to view similar products for [I/O Connectors](#) category:*

*Click to view products by [Wcon](#) manufacturer:*

Other Similar products are found below :

[571763P](#) [61-168618-12P](#) [D20419-211](#) [72.250.1628.2](#) [72.250.2428.2](#) [76.350.0729.0](#) [76871-1403](#) [PCR-E36PM](#) [PCS-XE26LKA](#) [PCS-XES68MS+](#) [G38A71314B](#) [9776-18-6](#) [1571250010](#) [157-22500-3](#) [MS3471L14-19P L/C](#) [192991-0703](#) [172501-6002](#) [FCN-260C008-A/L0](#) [FCN-260C024-AL0](#) [FCN-261Z008](#) [2000314-1](#) [200331-1](#) [PCS-E28FS+](#) [PCS-XE26SLFD+](#) [PCS-XE26SLFDT+](#) [G730VID08BDC24](#) [HDMR-29-01-S-SM-TR](#) [HDRA-E68W1LFDTC-SL+](#) [54182-0605](#) [UE86K842720321](#) [38113800006](#) [DP3AR020WQ1R200](#) [Z4.102.0680.0](#) [500-1040](#) [500-1052](#) [500-1054](#) [ZP-4008-66L](#) [10-565995-597N](#) [10-584459-12P](#) [5554841-1](#) [SM3106F14S-7S-LC](#) [U90B3054061110](#) [U65-E04-4020](#) [ZPF00000000097891](#) [557-262M2-06C](#) [PCS-96LFD+](#) [60-042222-02S](#) [10099439-003C-TRLF](#) [226-0348-000](#) [10137239-0021LF](#)