

RECOMMENDED PCB LAYOUT  
TOLERANCE IS ±0.05

Current Rating: 1.0A AC/DC  
Contact Resistance: 20milliohm Max  
Insulation Resistance: 100Megohm Min  
Withstand Voltage: 250V AC/minute  
Operation Temperature: -25°C to +75°C  
Housing Material: PA9T+30%GF(UL94V-0)  
Contact Material: Copper alloy  
Contact plating: Sn over Ni Plating  
02-06Pin without slot "A"

## Ordering Information

WF1001A-WMXX E R1

No. of Pins: 2P~20P  
Insulator Color: E=Beige  
Packing: R=Tape & Reel

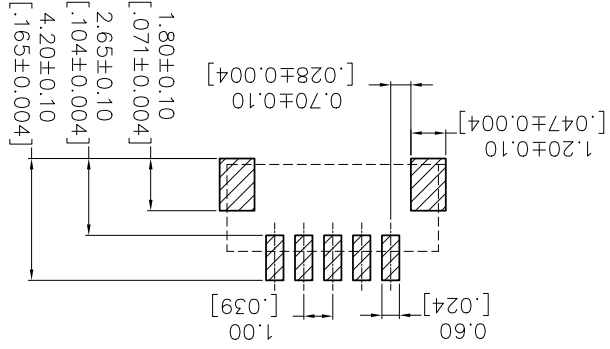
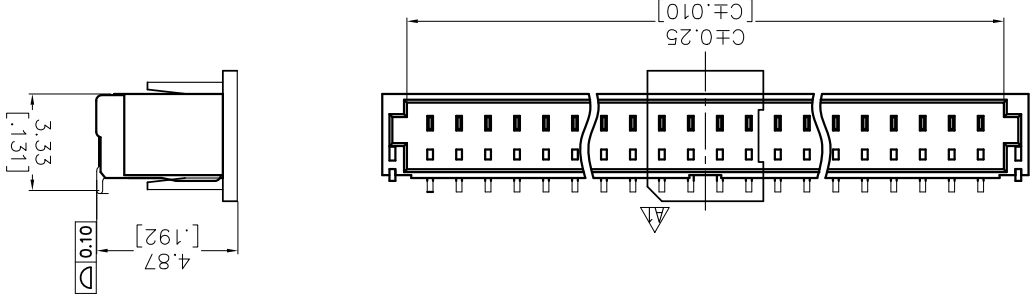
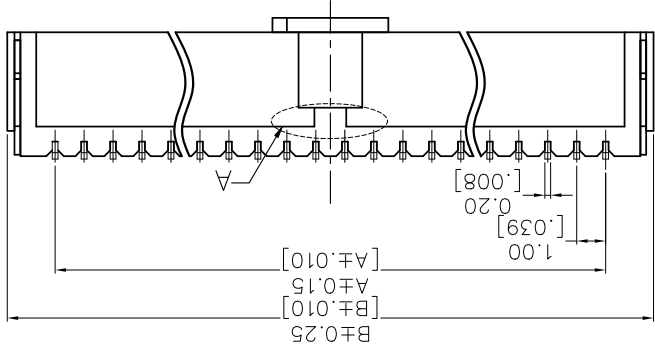

Ordering Information & Dimensions:

Dimension		Part No.	
A	B	C	
WF1001A-WM02ER1	1.00	4.30	2.60
WF1001A-WM03ER1	2.00	5.30	3.60
WF1001A-WM04ER1	3.00	6.30	4.60
WF1001A-WM05ER1	4.00	7.30	5.60
WF1001A-WM06ER1	5.00	8.30	6.60
WF1001A-WM07ER1	6.00	9.30	7.60
WF1001A-WM08ER1	7.00	10.30	8.60
WF1001A-WM09ER1	8.00	11.30	9.60
WF1001A-WM10ER1	9.00	12.30	10.60
WF1001A-WM11ER1	10.00	13.30	11.60
WF1001A-WM12ER1	11.00	14.30	12.60
WF1001A-WM13ER1	12.00	15.30	13.60
WF1001A-WM14ER1	13.00	16.30	14.60
WF1001A-WM15ER1	14.00	17.30	15.60
WF1001A-WM16ER1	15.00	18.30	16.60
WF1001A-WM17ER1	16.00	19.30	17.60
WF1001A-WM18ER1	17.00	20.30	18.60
WF1001A-WM19ER1	18.00	21.30	19.60
WF1001A-WM20ER1	19.00	22.30	20.60

REV	DATE	MODIFICATION DESCRIPTION	CHANGE	DIM TOL	APPROVE	DATE	PROJ.	CUSTOMER NO.
A0	2013/12/23	NEW	---	Angle ±.3°	APPROVE	DATE	SHEET 1/1	Customer NO.
A1	2018/11/21	Modify the CAP	---	X.XXX ±0.15	CHECK	DATE	SIZE A4	WCON-Dongguan WCON-Kunshan Tel: +86 769 85358920 Fax: +86 512 57468408 E-mail: sales@wcon.com
				X.X ±0.40	DRAW	DATE	UNIT mm	WCON-Dongguan WCON-Kunshan Tel: +86 769 85358920 Fax: +86 512 57468408 E-mail: sales@wcon.com
					Ding	2018/11/21	SCALE FIT	WCON-Dongguan WCON-Kunshan Tel: +86 769 85358920 Fax: +86 512 57468408 E-mail: sales@wcon.com

**WCON**  
http://www.wcon.com

PART NO. WF1001A-WMXXER1  
TITLE: J SH 1.0mm Wafer 180度SMT

## X-ON Electronics

Largest Supplier of Electrical and Electronic Components

*Click to view similar products for [Headers & Wire Housings](#) category:*

*Click to view products by [Wcon](#) manufacturer:*

Other Similar products are found below :

[95000-104TRLF](#) [10135584-644402LF](#) [DF62W-EP2022PCA](#) [95000-106TRLF](#) [DF62W-2022SCA](#) [DF62W-EP2022PC](#) [2203348](#) [DF62W-2022SC](#) [1084018](#) [1029039](#) [1084017](#) [802-10-012-10-002000](#) [1112640](#) [1112639](#) [891-007-9SS-BST1T](#) [000-34000](#) [0008550134](#) [0009482033](#) [0009507031](#) [57102-F02-18ULF](#) [57102-S06-03LF](#) [57202-S52-04LF](#) [PCN6-15S-2.5E](#) [0039019024](#) [58102-G61-06LF](#) [582553-1](#) [0009485154](#) [0009508121](#) [0022285053](#) [0050291907](#) [018731A](#) [LY20-4P-DT1-P1E-BR](#) [02.125.8002.8](#) [60101931](#) [60598-1 \(Cut Strip\)](#) [M1625-3R/100](#) [61062-3](#) [61082-181009](#) [CSU011177004](#) [636-1427](#) [638009-1](#) [641938-9](#) [641991-4](#) [644168-1](#) [644827-2](#) [647662-1](#) [65039-019ELF](#) [65692-001LF](#) [65781-018](#) [65781-047](#)