

# HSF

Recommended P.C.B Layout(Top Side)  
(PCB BOARD TOLERANCE±0.05)

NOTES:  
 Current Rating:1.0A  
 Voltage Rating:100V AC,DC  
 Contact Resistance:20mΩ max  
 Withstand Voltage:800V AC/minute  
 Insulation Resistance:1000MΩ min  
 Operation Temperature:-25℃ to +85℃

Contact Material:Brass  
 Contact plating:Au or Sn Over Ni  
 Insulator Material:PA66 Or PA46(UL94V-0)

## Ordering Information

WF2001 - WS H XX X 0 X X

Contact Plating  
 S0=Gold Flash/Tin  
 S3=10u/Gold/Tin  
 S4=15u/Gold/Tin  
 S5=30u/Gold/Tin  
 G0=Gold Flash  
 G3=10u/Gold  
 G4=15u/Gold  
 G5=30u/Gold  
 Blank=Tin  
 H=PA46  
 Blank=PA66  
 Color  
 B=Black  
 E=Beige  
 W=White  
 T=Natural  
 Series No.  
 1=Type 1  
 2=Type 2  
 Packing  
 0=PE Bag

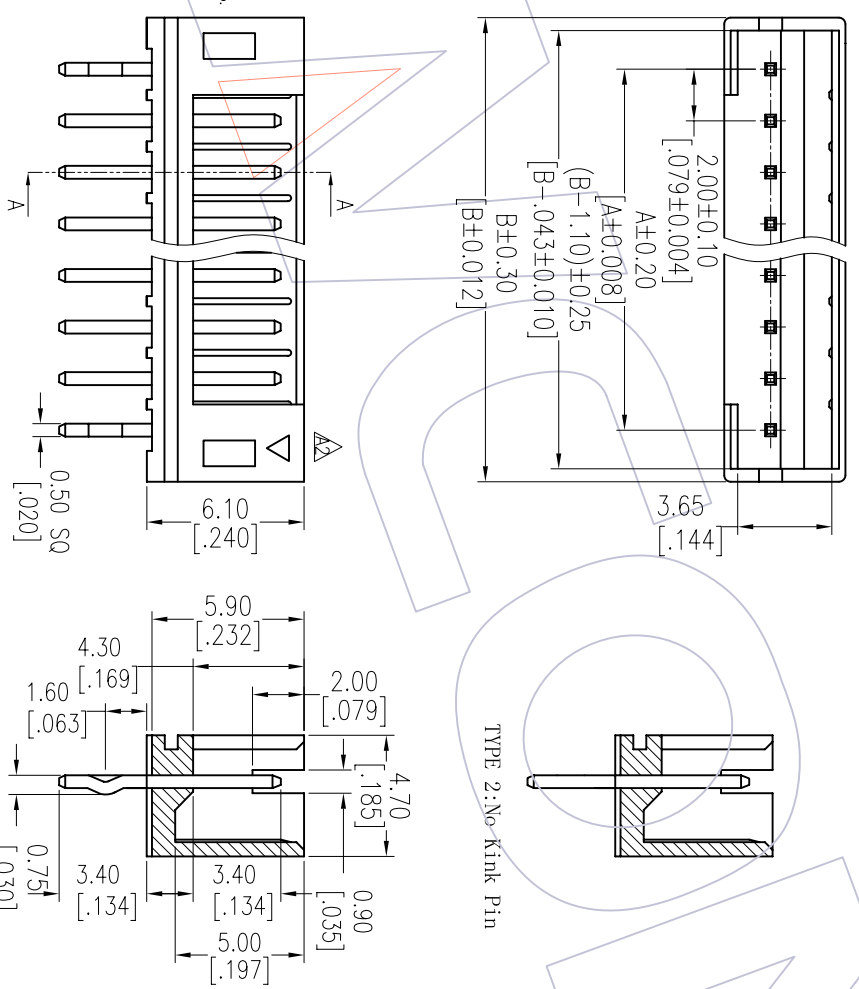

## Dimensional & Ordering Information:

| Circuit | Part No.       | Dimension |      | Q'TY /Bag |
|---------|----------------|-----------|------|-----------|
|         |                | A         | B    |           |
| 02      | WF2001-WS02X0X | 2.0       | 6.0  | 1,000     |
| 03      | WF2001-WS03X0X | 4.0       | 8.0  | 1,000     |
| 04      | WF2001-WS04X0X | 6.0       | 10.0 | 1,000     |
| 05      | WF2001-WS05X0X | 8.0       | 12.0 | 1,000     |
| 06      | WF2001-WS06X0X | 10.0      | 14.0 | 1,000     |
| 07      | WF2001-WS07X0X | 12.0      | 16.0 | 1,000     |
| 08      | WF2001-WS08X0X | 14.0      | 18.0 | 1,000     |
| 09      | WF2001-WS09X0X | 16.0      | 20.0 | 1,000     |
| 10      | WF2001-WS10X0X | 18.0      | 22.0 | 1,000     |
| 11      | WF2001-WS11X0X | 20.0      | 24.0 | 1,000     |
| 12      | WF2001-WS12X0X | 22.0      | 26.0 | 1,000     |
| 13      | WF2001-WS13X0X | 24.0      | 28.0 | 1,000     |
| 14      | WF2001-WS14X0X | 26.0      | 30.0 | 1,000     |
| 15      | WF2001-WS15X0X | 28.0      | 32.0 | 1,000     |
| 16      | WF2001-WS16X0X | 30.0      | 34.0 | 1,000     |
| 17      | WF2001-WS17X0X | 32.0      | 36.0 | 1,000     |
| 18      | WF2001-WS18X0X | 34.0      | 38.0 | 1,000     |
| 19      | WF2001-WS19X0X | 36.0      | 40.0 | 1,000     |
| 20      | WF2001-WS20X0X | 38.0      | 42.0 | 1,000     |

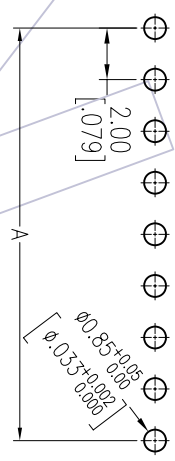

# WCON

Http: www.wcon.com  
 WCON-Dongguan  
 Tel: +86 769 85358920  
 Fax: +86 769 85358915  
 E-mail: sales@wcon.com

WCON-Kunshan  
 Tel: +86 512 57468408  
 Fax: +86 512 57468468  
 E-mail: sales@wcon.com

| OPERATION  | DRAW                     | DATE       | SCALE | FIT   | PART NO.     | SEE TABLE                |
|------------|--------------------------|------------|-------|-------|--------------|--------------------------|
| XX         | Wang                     | 2012/10/16 | mm    | A4    | TITLE:       | "J"TYPE PH2.0 WAFER 180° |
| XX         | CHECK                    | DATE       | SIZE  | SHEET | Customer NO. |                          |
| XX         | APPROVE                  | DATE       | 1/1   | PROJ. |              |                          |
| ANGLE      | ± 3'                     |            |       |       |              |                          |
| CHANG      |                          |            |       |       |              |                          |
| DATE       | MODIFICATION DESCRIPTION |            |       |       |              |                          |
| 2012/08/25 | NEW                      |            |       |       |              |                          |
| 2012/10/16 | Modify drawing           |            |       |       |              |                          |
| REV        | DATE                     |            |       |       |              |                          |

## X-ON Electronics

Largest Supplier of Electrical and Electronic Components

*Click to view similar products for [Headers & Wire Housings](#) category:*

*Click to view products by [Wcon](#) manufacturer:*

Other Similar products are found below :

[95000-104TRLF](#) [10135584-644402LF](#) [DF62W-EP2022PCA](#) [95000-106TRLF](#) [DF62W-2022SCA](#) [DF62W-EP2022PC](#) [2203348](#) [DF62W-2022SC](#) [1084018](#) [1029039](#) [1084017](#) [802-10-012-10-002000](#) [1112640](#) [1112639](#) [891-007-9SS-BST1T](#) [000-34000](#) [0008550134](#) [0009482033](#) [0009507031](#) [57102-F02-18ULF](#) [57102-S06-03LF](#) [57202-S52-04LF](#) [PCN6-15S-2.5E](#) [0039019024](#) [58102-G61-06LF](#) [582553-1](#) [0009485154](#) [0009508121](#) [0022285053](#) [0050291907](#) [018731A](#) [LY20-4P-DT1-P1E-BR](#) [02.125.8002.8](#) [60101931](#) [60598-1 \(Cut Strip\)](#) [M1625-3R/100](#) [61062-3](#) [61082-181009](#) [CSU011177004](#) [636-1427](#) [638009-1](#) [641938-9](#) [641991-4](#) [644168-1](#) [644827-2](#) [647662-1](#) [65039-019ELF](#) [65692-001LF](#) [65781-018](#) [65781-047](#)