

HSP

NOTES:

Rated Current: 5.0AMP
 Contact Resistance: 20mΩ max
 Withstand Voltage: 1000V AC/DC
 Insulation Resistance: 1000MΩ min
 Operation Temperature: -25°C to +85°C

Contact Material: Brass
 Contact plating: Au Or Sn Over Ni
 Insulator Material: PA46 Or PA66

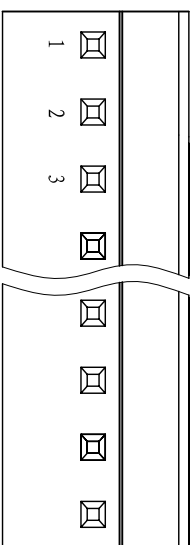

Recommended P.C.B Layout(Top Side)
 (PCB BOARD TOLERANCE±0.05)

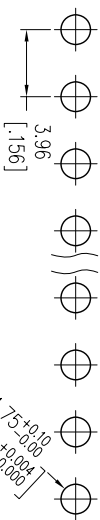

ø1.75±0.08
 ø1.69±0.04
 ø0.06±0.006

Specification & Ordering Information:

Circuit	Part No.	Dimension		Q'Ty/ bag
		A	B	
02	WF 3961 - WS02W01	3.96	7.92	700
03	WF 3961 - WS03W01	7.92	11.88	600
04	WF 3961 - WS04W01	11.88	15.84	450
05	WF 3961 - WS05W01	15.84	19.80	350
06	WF 3961 - WS06W01	19.80	23.76	300
07	WF 3961 - WS07W01	23.76	27.72	250
08	WF 3961 - WS08W01	27.72	31.68	200
09	WF 3961 - WS09W01	31.68	35.64	180
10	WF 3961 - WS10W01	35.64	39.60	150
11	WF 3961 - WS11W01	39.60	43.56	120
12	WF 3961 - WS12W01	43.56	47.52	90
13	WF 3961 - WS13W01	47.52	51.48	70
14	WF 3961 - WS14W01	51.48	55.44	50
15	WF 3961 - WS15W01	55.44	59.40	30

Ordering Information

WF3961- WS XX W 0 1

No. of pins Contact Plating Color Packing
 02-1SP S0=Gold Flash/Tin B=Black 0=PE Bag
 H=PA46 W=White
 Blank=AA66
 S4=15u/Gold/Tin
 S5=30u/Gold/Tin
 C0=Gold Flash
 G3=10u/Gold
 G4=15u/Gold
 G5=30u/Gold
 Blank=Tin

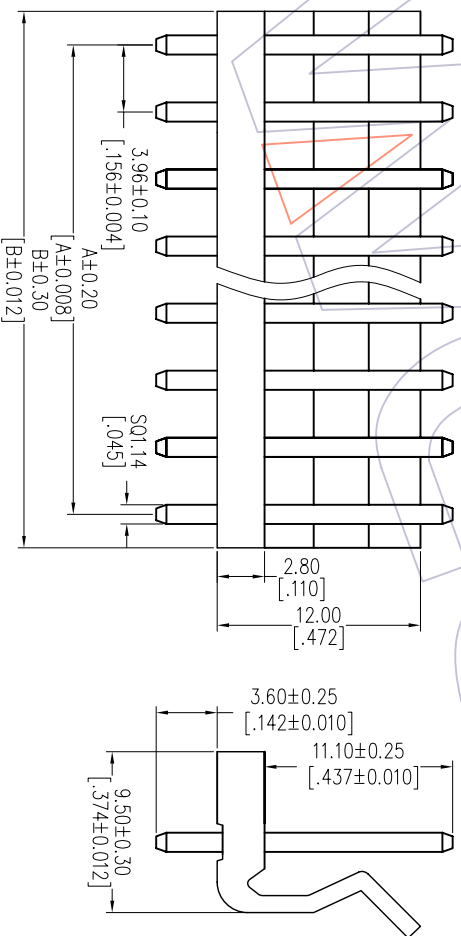

REV	DATE	MODIFICATION DESCRIPTION	CHANGE	OPERATION	DRAW	DATE	SCALE	FIT	PART NO.	SEE TAB	<p>WCON Http: www.wcon.com</p> <p>WCON-Dongguan Tel: +86 769 85358920 Fax: +86 769 85358915 E-mail: sales@wcon.com</p> <p>WCON-Kunshan Tel: +86 512 57468408 Fax: +86 512 57468468 E-mail: sales@wcon.com</p>
AO	2012/09/11	NEW		XX XX X.XXX	JYHuang	2012/09/11	mm A4	1/1	"M" TYPE 3.96 WAPER 180°		
REV	DATE	MODIFICATION DESCRIPTION	CHANGE	Angle ± 3°	CHECK	DATE	SHEET	PROJ.	Customer NO.		

X-ON Electronics

Largest Supplier of Electrical and Electronic Components

Click to view similar products for [Headers & Wire Housings](#) category:

Click to view products by [Wcon](#) manufacturer:

Other Similar products are found below :

[95000-104TRLF](#) [10135584-644402LF](#) [DF62W-EP2022PCA](#) [95000-106TRLF](#) [DF62W-2022SCA](#) [DF62W-EP2022PC](#) [2203348](#) [DF62W-2022SC](#) [1084018](#) [1029039](#) [1084017](#) [802-10-012-10-002000](#) [1112640](#) [1112639](#) [891-007-9SS-BST1T](#) [000-34000](#) [0008550134](#) [0009482033](#) [0009507031](#) [57102-F02-18ULF](#) [57102-S06-03LF](#) [57202-S52-04LF](#) [PCN6-15S-2.5E](#) [0039019024](#) [58102-G61-06LF](#) [582553-1](#) [0009485154](#) [0009508121](#) [0022285053](#) [0050291907](#) [018731A](#) [LY20-4P-DT1-P1E-BR](#) [02.125.8002.8](#) [60101931](#) [60598-1 \(Cut Strip\)](#) [M1625-3R/100](#) [61062-3](#) [61082-181009](#) [CSU011177004](#) [636-1427](#) [638009-1](#) [641938-9](#) [641991-4](#) [644168-1](#) [644827-2](#) [647662-1](#) [65039-019ELF](#) [65692-001LF](#) [65781-018](#) [65781-047](#)