

HSP

NOTES:

Rated Current: 5.0AMP
 Contact Resistance: 20mΩ max
 Withstand Voltage: 1000V AC/DC
 Insulation Resistance: 1000MΩ min
 Operation Temperature: -25°C to +85°C

Contact Material: Brass
 Contact plating: Au Or Sn Over Ni
 Insulator Material: PA46 Or PA66

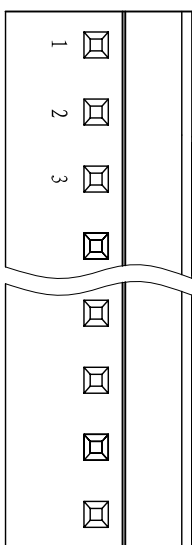

Recommended P.C.B Layout(Top Side)
 (PCB BOARD TOLERANCE±0.05)

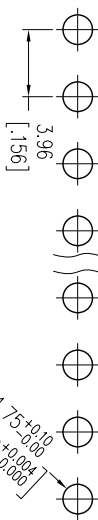

Specification & Ordering Information:

Circuit	Part No.	Dimension		Q'Ty/ bag
		A	B	
02	WF 3961 - WS02W01	3.96	7.92	700
03	WF 3961 - WS03W01	7.92	11.88	600
04	WF 3961 - WS04W01	11.88	15.84	450
05	WF 3961 - WS05W01	15.84	19.80	350
06	WF 3961 - WS06W01	19.80	23.76	300
07	WF 3961 - WS07W01	23.76	27.72	250
08	WF 3961 - WS08W01	27.72	31.68	200
09	WF 3961 - WS09W01	31.68	35.64	180
10	WF 3961 - WS10W01	35.64	39.60	150
11	WF 3961 - WS11W01	39.60	43.56	120
12	WF 3961 - WS12W01	43.56	47.52	90
13	WF 3961 - WS13W01	47.52	51.48	70
14	WF 3961 - WS14W01	51.48	55.44	50
15	WF 3961 - WS15W01	55.44	59.40	30

Ordering Information

WF3961- WS XX W 0 1

No. of pins Contact Plating Color Packing
 02-15P S0=Gold Flash/Tin B=Black 0=PE Bag
 H=PA46 W=White
 Blank=AA66
 S4=15u/Gold/Tin
 S5=30u/Gold/Tin
 C0=Gold Flash
 G3=10u/Gold
 G4=15u/Gold
 G5=30u/Gold
 Blank=Tin

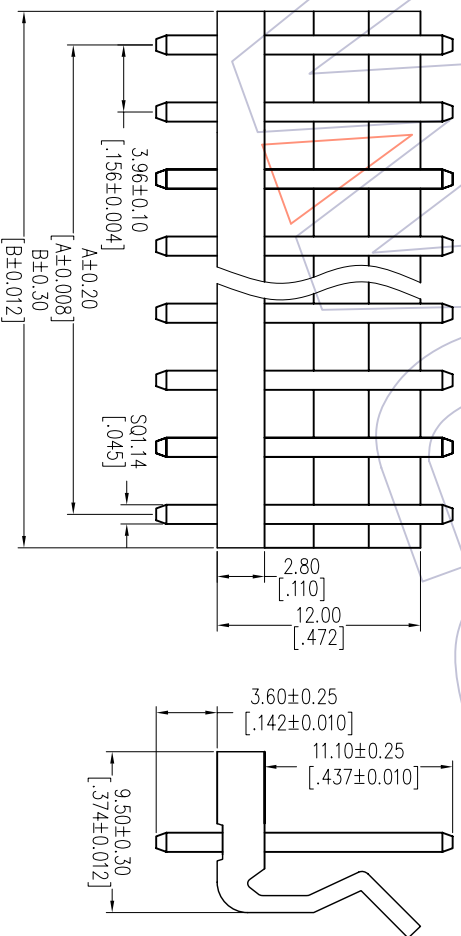

REV	DATE	MODIFICATION DESCRIPTION	CHANGE	OPERATION	DRAW	DATE	SCALE	FIT	PART NO.	SEE TAB
AO	2012/09/11	NEW		XX	JYHuang	2012/09/11	UNIT	mm	TITLE:	"M" TYPE 3.96 WAFER 180°
				XX	CHECK	DATE	SIZE	A4	SHEET	1/1
				XXX	APPROVE	DATE	PROJ.		Customer NO.	
				Angle						
				± 3'						
				TOL						

WCON

WCON-Dongguan
 Tel: +86 769 85358920
 Fax: +86 769 85358915
 E-mail: sales@wcon.com

WCON-Kunshan
 Tel: +86 512 57468408
 Fax: +86 512 57468468
 E-mail: sales@wcon.com

X-ON Electronics

Largest Supplier of Electrical and Electronic Components

Click to view similar products for [Headers & Wire Housings](#) category:

Click to view products by [Wcon](#) manufacturer:

Other Similar products are found below :

[57102-F02-18ULF](#) [58102-G61-06LF](#) [0009485154](#) [009176003701906](#) [0050291907](#) [00-9021-0611-00-339](#) [02.125.8002.8](#) [609-3404](#) [61062-3](#)
[622-0430](#) [622-3653LF](#) [63453-116](#) [636-1030](#) [636-1427](#) [636-3427](#) [636-4007](#) [641938-9](#) [644827-2](#) [65495-038](#) [65692-001LF](#) [65781-018](#)
[65781-047](#) [65817-010LF](#) [65817-015LF](#) [66207-023LF](#) [67016-026LF](#) [67095-007LF](#) [68631-112](#) [68645-018](#) [68648-049](#) [699319-000](#)
[70.362.1628.0](#) [70-4210](#) [70-4226B](#) [70-4853B](#) [707-5020](#) [707-5028](#) [71.350.2428.0](#) [71961-016LF](#) [733-134](#) [754199-000](#) [760-3052](#) [787-8014-00](#)
[FCN-367T-T012/H](#) [80.063.4001.1](#) [800-90-001-10-001000](#) [800-90-010-10-002000](#) [801-43-002-10-013000](#) [801-43-006-10-002000](#)
[803-41-018-10-001000](#)