

4 5 6 7 8 9 10

A

B

C

D

E

F

G

H

11.60±0.25
[.457±0.010]

B±0.25

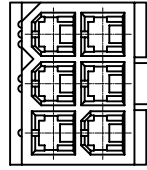

2x03P

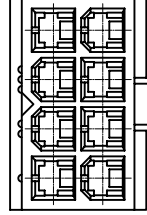

2x04P

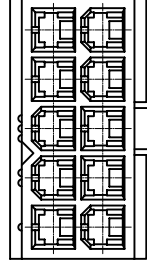

2x05P

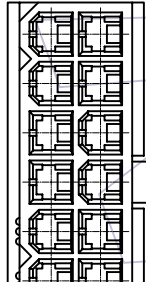

2x07P

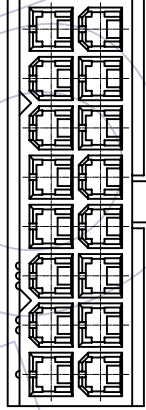

2x08P

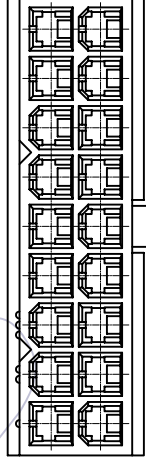

2x09P

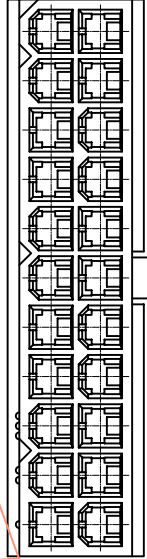

2x11P

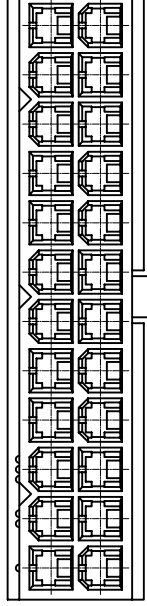

2x12P

OPERATION	DRAW	DATE	SCALE	FIT	PART NO.	WCON	
						Http: www.wcon.com	WCON-Kunshan
x.x ±0.40	JYHuang	2012/09/17	UNIT	mm inch	WF42.02-2HKXXW02	WCON-Dongguan	WCON-Kunshan
x.xx ±0.25	CHECK	DATE	SIZE	A4	TITLE: 4.20mm Mini Fit Housing Dual Row Female	Tel: +86 769 85358920	Tel: +86 512 57468408
x.xxx ±0.15	APPROVE	DATE	SHEET	2/2	Customer NO.	Fax: +86 769 85358915	Fax: +86 512 57468468
Angle DIM	TOL		PROJ.			E-mail: sales@wcon.com	E-mail: sales@wcon.com

4 5 6 7 8 9 10

X-ON Electronics

Largest Supplier of Electrical and Electronic Components

Click to view similar products for [Headers & Wire Housings](#) category:

Click to view products by [Wcon](#) manufacturer:

Other Similar products are found below :

[95000-104TRLF](#) [10135584-644402LF](#) [DF62W-EP2022PCA](#) [95000-106TRLF](#) [DF62W-2022SCA](#) [DF62W-EP2022PC](#) [2203348](#) [DF62W-2022SC](#) [1084018](#) [1029039](#) [1084017](#) [802-10-012-10-002000](#) [1112640](#) [1112639](#) [891-007-9SS-BST1T](#) [000-34000](#) [0008550134](#) [0009482033](#) [0009507031](#) [57102-F02-18ULF](#) [57102-S06-03LF](#) [57202-S52-04LF](#) [PCN6-15S-2.5E](#) [0039019024](#) [58102-G61-06LF](#) [582553-1](#) [0009485154](#) [0009508121](#) [0022285053](#) [0050291907](#) [018731A](#) [LY20-4P-DT1-P1E-BR](#) [02.125.8002.8](#) [60101931](#) [60598-1 \(Cut Strip\)](#) [M1625-3R/100](#) [61062-3](#) [61082-181009](#) [CSU011177004](#) [636-1427](#) [638009-1](#) [641938-9](#) [641991-4](#) [644168-1](#) [644827-2](#) [647662-1](#) [65039-019ELF](#) [65692-001LF](#) [65781-018](#) [65781-047](#)