

2-DIN-46284-ST / 3-DIN-46284-ST

Socket terminal blocks
with steel screws and mounting holes



GENERAL INFORMATION

No. of poles 2 + 3

TECHNICAL DATA

Clamping Range	<i>solid / stranded / AWG</i> 1 - 6 mm ² / 1 - 4 mm ² / 16 - 10 AWG [1]
Rated Cross Section	2,5 mm ²
Wire Stripping Length	6,5 mm ± 0,5 mm
Rated Insulation Voltage	450 V acc. to EN 60998-1
Rated Current	24 A
Torque	0,5 Nm
Base mounting	Recommendation: Screw M3 with matching washer; max. torque 0.8 Nm; use of an elastic & insulating substrate.
Other specifications	Terminal strips must not be strung together without considering the clearance and creepage distances.

APPROVALS

	Current [A]	Voltage [V]	Group	AWG	[Nm]
	20	300	B	18 - 12	0,51
	20	150	C	18 - 12	0,51
	10	300	D	18 - 12	0,51
	20	300	B	18 - 12	0,51
	20	150	C	18 - 12	0,51
	10	300	D, E	18 - 12	0,51

CONFIGURATIONS

Item	Article number	PU
2-DIN-46284-ST	10.610.012	264
3-DIN-46284-ST	10.610.013	168

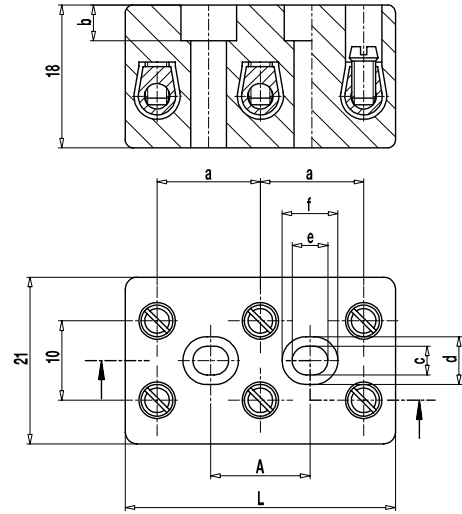

Dimensions (mm)

Type	L	A	a	b	c	d	e	f
2-DIN-46284-ST	20	—	11,5	4	∅ 3,5	∅ 6,6	—	—
3-DIN-46284-ST	34	12,5	13	4	3,6	6	4,5	7

MATERIAL

Moulding	Technical ceramics
Comparative Tracking Index	CTI ≥ 600
Insulating Group	I
Temperature Range	-40°C up to 250°C
Terminal body	Nickel plated brass
Screw	M3; Zinc plated steel, blue passivated

OPTIONS / ACCESSORIES

- Version with wire protector on request

[1] Recommendation: Use flexible and AWG conductors with ferrules only.

X-ON Electronics

Largest Supplier of Electrical and Electronic Components

Click to view similar products for [Weco manufacturer](#):

Other Similar products are found below :

[110-A-111/02](#) [110-A-111/03](#) [110-A-111/04](#) [110-A-111/05](#) [110-A-111/06](#) [110-A-111/08-BA](#) [110-M-111/02](#) [110-M-111/05](#) [110-M-111/06](#)
[110-M-121/02](#) [110-M-121/06](#) [110-M-211/02](#) [110-M-211/03](#) [110-M-211/04](#) [110-M-211/05](#) [110-M-211/06](#) [110-M-211-SMD/02-MAG](#) [110-M-211-SMD/03-MAG](#) [110-M-211-SMD/04-MAG](#) [110-M-221/02](#) [110-M-221/03](#) [110-M-221/04](#) [110-M-221/05](#) [110-M-221/06](#) [110-P-111/16](#)
[120-A-111/02-K](#) [120-A-111/03](#) [120-A-111/04](#) [120-A-111/05](#) [120-A-111/06](#) [120-A-111/10-333](#) [120-D-111/08](#) [120-D-121/06](#) [120-M-211/02](#)
[120-M-211/02-K](#) [120-M-211/03](#) [120-M-221/02](#) [120-M-221/03](#) [120-M-221/04](#) [120-M-221/06](#) [120-M-222/06](#) [120-M-222/08](#) [120-M-222/10](#)
[121-A-111/02](#) [121-A-111/03](#) [121-A-111/04](#) [121-A-111/05](#) [121-A-111/06](#) [121-D-121/05](#) [121-M-111 /02](#)