

900-S-7,5

Tab connector
Tab 2x 2,8 mm / 1x 6,3 mm

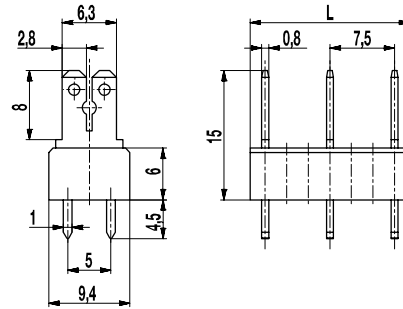

GENERAL INFORMATION

| | |
|--------------|--------|
| Pitch | 7,5 mm |
| No. of poles | 2 - 17 |

TECHNICAL DATA

| | | | |
|--------------------------|---|-------|--------|
| Overvoltage Category | III | III | II |
| Pollution Severity Level | 3 | 2 | 2 |
| Rated Voltage | 500 V | 630 V | 1000 V |
| Rated Impulse Voltage | 6 kV | 6 kV | 6 kV |
| Rated Insulation Voltage | 750 V acc. to EN 60998-1 | | |
| Rated Current | 7,5 A: with receptacles 2,8; wire 1 mm ² (16 AWG) 15 A: with receptacles 6,3; wire 2,5 mm ² (14 AWG) | | |
| Hole in PCB | ø 1,6 mm | | |
| Other specifications | Indicated rated voltages refer to applications with insulation receptacles | | |

APPROVALS

| | Current [A] | Voltage [V] | Group | AWG | [Nm] |
|--|-------------|-------------|-------|-----|------|
| | 15 | 300 | B | | |
| | 15 | 150 | C | | |
| | 15 | 300 | B | | |
| | 10 | 300 | D, E | | |

MATERIAL

| | |
|----------------------------|--|
| Moulding | PA, red, V-0 |
| Comparative Tracking Index | CTI ≥ 600 |
| Insulating Group | I |
| Temperature Range | -40°C up to 100°C |
| Solder pin | 1,0 x 0,8 mm; tin plated brass |
| Tab | 2,8 x 0,8 mm; 6,3 x 0,8 mm; tin plated brass |

OPTIONS / ACCESSORIES

- Consecutive numbering
- Special marking according to drawing
- Self-adhesive marking strip BST-7,50
- Insulation receptacles ISO
- Insulation sockets ISO-900
- Change of pitch
- Component mix of tab connector versions
- Tab connectors are also individually available (see single tabs GST-900)

CONFIGURATIONS

| Poles | Part number | Article number | Length (L) | Packaging | PU |
|-------|--------------|----------------|------------|-----------|-----|
| 2 | 900-S-7,5/02 | 75.870.903 | 11,00 mm | Box | 250 |
| 3 | 900-S-7,5/03 | 75.870.904 | 18,50 mm | Box | 200 |
| 4 | 900-S-7,5/04 | 75.870.906 | 26,00 mm | Box | 100 |
| 5 | 900-S-7,5/05 | 75.870.907 | 33,50 mm | Box | 100 |
| 6 | 900-S-7,5/06 | 75.870.909 | 41,00 mm | Box | 100 |



X-ON Electronics

Largest Supplier of Electrical and Electronic Components

Click to view similar products for [Terminals](#) category:

Click to view products by [Weco](#) manufacturer:

Other Similar products are found below :

[00-054007-01074-6](#) [00-054007-70206-1](#) [00-054007-70210-8](#) [00-054007-70217-7](#) [00-054007-70228-3](#) [00-054007-70256-6](#) [00-054007-70316-7](#) [00-054007-49560-4](#) [00-054007-70209-2](#) [00-054007-70231-3](#) [00-054007-70241-2](#) [00-054007-70242-9](#) [00-054007-70246-7](#) [00-054007-70263-4](#) [00-054007-70288-7](#) [00-054007-70290-0](#) [00-054007-70300-6](#) [00-054007-70304-4](#) [01-2900-1-04412](#) [600TS-10](#) [605601-1](#) [60617-1-C](#) [61314-6-C](#) [61810-3](#) [626-0194](#) [63-S](#) [M55155/079C01](#) [M55155/099B03](#) [M55155/109H01](#) [M55155/29XJ08](#) [M55155/30-6S](#) [M55155/30-9S](#) [M55155/30XI09](#) [M6-14RSX](#) [696683-1](#) [696861-1](#) [696999-1](#) [M86700006](#) [D18-110B-C](#) [D18-110B-M](#) [701-1936](#) [701-1955](#) [701-2003](#) [701-2007](#) [701-2013](#) [701-2018](#) [701-2069](#) [701-2077-60](#) [701-2315](#) [701-2430](#)