

# 971-SLR-SMD-1,1

Pin strip for SMD  
Plug-in area  $\varnothing$  1,1 mm

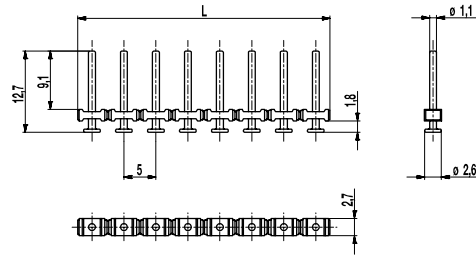

### PCB LAYOUT

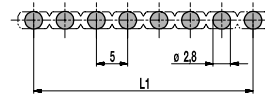

$L1 = (\text{No. of poles} - 1) \times \text{pitch}$   
Solder paste thickness: 0,15 - 0,2 mm

### GENERAL INFORMATION

Pitch	5 mm
No. of poles	2 - 12
Usable with	plug connectors of series 115-F-.../...-1,1-SW; 950-FL-DS, 950-TFL-DS, 950-NAF-DS, 950-GFL-DS, 950-NLFL-DS, 950-RFL-DS

### TECHNICAL DATA

Overvoltage Category	III	III	II
Pollution Severity Level	3	2	2
Rated Voltage	160 V	160 V	320 V
Rated Impulse Voltage	2,5 kV	2,5 kV	2,5 kV
Rated Insulation Voltage	130 V acc. to EN 60998-1		
Rated Current	10 A		
Soldering process	Reflow solder		

### APPROVALS

	Current [A]	Voltage [V]	Group	AWG	[Nm]
	10 [1]	300	B		
	10	300	B		

### MATERIAL

Moulding	PA HT, black, V-0
Comparative Tracking Index	CTI $\geq$ 600
Insulating Group	I
Temperature Range	-40°C up to 120°C; reflow solder temperature peak max. 255°C acc. to DIN EN 61760-1
Solder pin	$\varnothing$ 1,1 mm (plug-in area); tin plated brass

### OPTIONS / ACCESSORIES

- Other plug pin lengths on request
- Other solder pin surfaces on request

[1] Above headers with 1.0 or 1.1 mm dia. pins are rated 12A max. with manufacturer's Cat. No. 120-W-111 terminal blocks. Above headers with 1.1 mm or 1.3 mm dia. pins are rated 12A max. with 115-F-111, 115-F-211 and 115-F-118 terminal blocks.

### CONFIGURATIONS

Poles	Part number	Article number	Length (L)	Packaging	PU	Tape Width	Tape Height
2	971-SLR-SMD-1,1/02	12.893.822	9,50 mm	Box	1000		
3	971-SLR-SMD-1,1/03	13.893.822	14,50 mm	Box	500		
4	971-SLR-SMD-1,1/04	14.893.822	19,50 mm	Box	500		
5	971-SLR-SMD-1,1/05	15.893.822	24,50 mm	Box	250		
6	971-SLR-SMD-1,1/06	16.893.822	29,50 mm	Box	250		
2	971-SLR-SMD-1,1/02-T&R	12.893.822.A00	9,50 mm	Tape-on-Reel	500	32 mm	15,9 mm
3	971-SLR-SMD-1,1/03-T&R	13.893.822.A00	14,50 mm	Tape-on-Reel	500	32 mm	15,9 mm
4	971-SLR-SMD-1,1/04-T&R	14.893.822.A00	19,50 mm	Tape-on-Reel	500	56 mm	15,9 mm
5	971-SLR-SMD-1,1/05-T&R	15.893.822.A00	24,50 mm	Tape-on-Reel	500	56 mm	15,9 mm
6	971-SLR-SMD-1,1/06-T&R	16.893.822.A00	29,50 mm	Tape-on-Reel	500	56 mm	15,9 mm

further number of poles on request



## X-ON Electronics

Largest Supplier of Electrical and Electronic Components

*Click to view similar products for [Headers & Wire Housings](#) category:*

*Click to view products by [Weco](#) manufacturer:*

Other Similar products are found below :

[0015917161](#) [0022155065](#) [57102-F02-18ULF](#) [58102-G61-06LF](#) [582553-1](#) [01.001.5753.1](#) [0050291907](#) [02.125.8002.8](#) [609-3404](#) [61062-3](#)  
[CSU011177004](#) [622-0430](#) [622-3653LF](#) [63453-116](#) [636-1030](#) [636-1427](#) [636-3427](#) [636-4007](#) [641938-9](#) [65495-038](#) [65692-001LF](#) [65781-018](#)  
[65781-047](#) [65817-010LF](#) [65817-015LF](#) [67095-007LF](#) [67601157](#) [68631-112](#) [68645-018](#) [699319-000](#) [70.362.1628.0](#) [70-4210](#) [70-4226B](#) [70-](#)  
[4853B](#) [71.350.2428.0](#) [733-134](#) [733-162](#) [MHR-64-VUAL](#) [80.063.4001.1](#) [800-90-001-10-001000](#) [801-43-002-10-013000](#) [801-43-006-10-](#)  
[002000](#) [803-43-024-10-001000](#) [803-93-012-10-001000](#) [8-1437020-4](#) [819-22-004-30-001101](#) [820-22-006-30-001101](#) [820-22-008-30-001101](#)  
[821-22-002-10-001101](#) [821-22-003-10-002101](#)