

## Pin strip for THR

### 971-SLR-THR-1,3

Soldering/plug-in area  $\varnothing$  1,3 mm

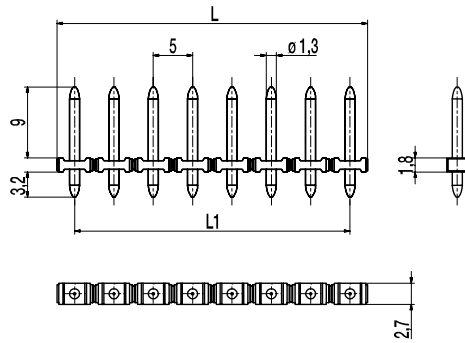

### PCB Layout

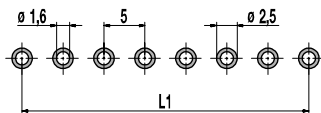

$L1 = (\text{No. of poles} - 1) \times \text{pitch}$   
 Solder paste thickness: 0,15 - 0,2 mm  
 Solder pad diameter:  $\varnothing$  2,5 mm

971-SLR-THR-1,3 is a pin strip with a pitch of 5 mm for the application in a reflow soldering process. The high temperature resistant plastic housing has a very high CTI value and is equipped with spacers, so-called "Stand-offs", which ensure a better hot-air circulation during the reflow soldering process in the convection oven. Beyond this, they assure an improved optical control of the solder joints.

The pin strip 971-SLR-THR-1,3 comes with a constant pin  $\varnothing$  of 1,3 mm and is usable with all WECO plug connectors (see general information). Furthermore we recommend this pin strip for small numbers of poles and for the series of 115-F for all numbers of poles. The obtained plug-in and pull-out forces are comfortable. For the automatic assembling all pin strips of this series are packed in Tape-on-Reel and equipped with high temperature resistant Pick Caps, which can easily be removed after the soldering process.

### Part Numbers

No. of poles	971-SLR-THR-1,3	Length	PU
2	12.893.805	9,50	1000
3	13.893.805	14,50	500
4	14.893.805	19,50	500
5	15.893.805	24,50	250
6	16.893.805	29,50	250
8	18.893.805	39,50	250
10	20.893.805	49,50	100
11	21.893.805	54,50	100
12	22.893.805	59,50	100

### General Information

Pitch	5 mm
No. of poles	2 - 12
Usable with	plug connectors of series 115-F, 950-FL-DS, 950-TFL-DS, 950-NAF-DS, 950-GFL-DS, 950-NLFL-DS, 950-RFL-DS
Additional Information	Also please consider the pin strips 971-SLR for wave soldering and 971-SLR-SMD in genuine surface mount technology.

### Technical Data

Overvoltage Category	III	III	II
Pollution Severity Level	3	2	2
Rated Voltage	250 V	320 V	630 V
Rated Impulse Voltage	4 kV	4 kV	4 kV
Rated Insulation Voltage	250 V acc. to EN 60998-1		
Rated Current	10 A		
Soldering process	Wave solder & reflow solder		
Hole in PCB	$\varnothing$ 1,6 mm		
PCB thickness	Wave solder max. 1,6 mm; reflow solder 1,6 - 3,2 mm		

### Material

Moulding	PA HT, black, V-0
Comparative Tracking Index	CTI $\geq$ 600
Insulating Group	I
Temperature Range	-40°C up to 120°C; reflow solder temperature (Peak) max. 260°C (15-30 s)
Solder pin	$\varnothing$ 1,3 mm; tin plated brass

### Approvals

	Current	Voltage	Group	AWG	Nm
	10 [1]	300	B		
	10 [1]	300	B		

### Options / Accessories

- Other plug pin lengths on request
- Other solder pin surfaces on request

### Part Numbers: Tape-on-Reel

No. of poles	971-SLR-THR-1,3	Tape Width	Tape Height	PU
2	12.893.805.A00	32 mm	15,9 mm	500
3	13.893.805.A00	32 mm	15,9 mm	500
4	14.893.805.A00	56 mm	15,9 mm	500
5	15.893.805.A00	56 mm	15,9 mm	500
6	16.893.805.A00	56 mm	15,9 mm	500
7	17.893.805.A00	56 mm	15,9 mm	500
10	20.893.805.A00	72 mm	15,9 mm	500
12	22.893.805.A00	88 mm	15,9 mm	500

further number of poles on request

[1] By using 115-F current of 12 A possible

## X-ON Electronics

Largest Supplier of Electrical and Electronic Components

*Click to view similar products for [Headers & Wire Housings](#) category:*

*Click to view products by [Weco](#) manufacturer:*

Other Similar products are found below :

[0015917161](#) [0022155065](#) [57102-F02-18ULF](#) [58102-G61-06LF](#) [582553-1](#) [01.001.5753.1](#) [0050291907](#) [02.125.8002.8](#) [609-3404](#) [61062-3](#)  
[CSU011177004](#) [622-0430](#) [622-3653LF](#) [63453-116](#) [636-1030](#) [636-1427](#) [636-3427](#) [636-4007](#) [641938-9](#) [65495-038](#) [65692-001LF](#) [65781-018](#)  
[65781-047](#) [65817-010LF](#) [65817-015LF](#) [67095-007LF](#) [67601157](#) [68631-112](#) [68645-018](#) [699319-000](#) [70.362.1628.0](#) [70-4210](#) [70-4226B](#) [70-](#)  
[4853B](#) [71.350.2428.0](#) [733-134](#) [733-162](#) [MHR-64-VUAL](#) [80.063.4001.1](#) [800-90-001-10-001000](#) [801-43-002-10-013000](#) [801-43-006-10-](#)  
[002000](#) [803-43-024-10-001000](#) [803-93-012-10-001000](#) [8-1437020-4](#) [819-22-004-30-001101](#) [820-22-006-30-001101](#) [820-22-008-30-001101](#)  
[821-22-002-10-001101](#) [821-22-003-10-002101](#)