

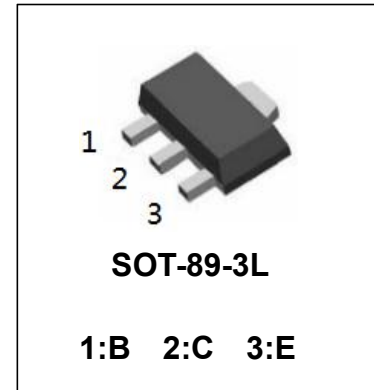

BCX54,BCX55,BCX56
(KCX54 ,KCX55,KCX56)
■ Features

- ◆ High current (max. 1A).
- ◆ Low voltage (max.80V).
- ◆ Package:SOT-89-3L.

■ Absolute Maximum Ratings Ta = 25°C

Parameter	Symbol	Rating	Unit
Collector-base voltage	BCX54	45	V
	BCX55	V_{CB0}	60
	BCX56	100	V
Collector-emitter voltage	BCX54	45	V
	BCX55	V_{CEO}	60
	BCX56	80	V
Emitter-base voltage	V_{EBO}	5	V
Collector current	I_C	1	A
Peak collector current	I_{CM}	1.5	A
Peak base current	I_{BM}	0.2	A
Total power dissipation	P_{tot}	1.3	W
Storage temperature	T_{stg}	-65 to +150	°C
Junction temperature	T_J	150	°C
Operating ambient temperature	T_{amb}	-65 to +150	°C
Thermal resistance from junction to ambient	$R_{th(j-a)}$	94	K/W
Thermal resistance from junction to solder point	$R_{th(j-s)}$	14	K/W

■ Electrical Characteristics Ta = 25°C

Parameter	Symbol	Testconditions	Min	Typ	Max	Unit
Collector cutoff current	I_{CBO}	$V_{CB} = 30\text{ V}, I_E = 0$			100	nA
		$V_{CB} = 30\text{ V}, I_E = 0; T_J = 125$			10	u A

NPN Transistors

Emitter cutoff current	I_{EBO}	$V_{EB} = 5\text{ V}, I_C = 0$			100	nA
DC current gain	h_{FE}	$I_C = 5\text{ mA}; V_{CE} = 2\text{ V}$	63			
		$I_C = 150\text{ mA}; V_{CE} = 2\text{ V}$	63		250	
		$I_C = 500\text{ mA}; V_{CE} = 2\text{ V}$	40			
DC current gain BCX54-10,BCX55-10,BCX56-10 BCX54-16,BCX55-16,BCX56-16	h_{FE}	$I_C = 150\text{ mA}; V_{CE} = 2\text{ V}$	63		160	
		$I_C = 150\text{ mA}; V_{CE} = 2\text{ V}$	100		250	
Collector-emitter saturation voltage	$V_{CE(sat)}$	$I_C = 500\text{ mA}; I_B = 50\text{ mA}$			0.5	V
Base to emitter voltage	V_{BE}	$I_C = 500\text{ mA}; V_{CE} = 2\text{ V}$			1	V
Transition frequency	f_T	$I_C = 10\text{ mA}; V_{CE} = 5\text{ V}; f = 100\text{ MHz}$		130		MHz
DC current gain ratio of the complementary pairs	$\frac{h_{FE}}{h_{FE}}$	$ I_C = 150\text{ mA}; V_{CE} = 2\text{ V}$		1.3	1.6	
	h_{FE}					

hFE Classification

TYPE	BCX54	BCX54-10	BCX54-16
Marking	BA	BC	BD

TYPE	BCX55	BCX55-10	BCX55-16
Marking	BE	BG	BM

TYPE	BCX56	BCX56-10	BCX56-16
Marking	BH	BK	BL

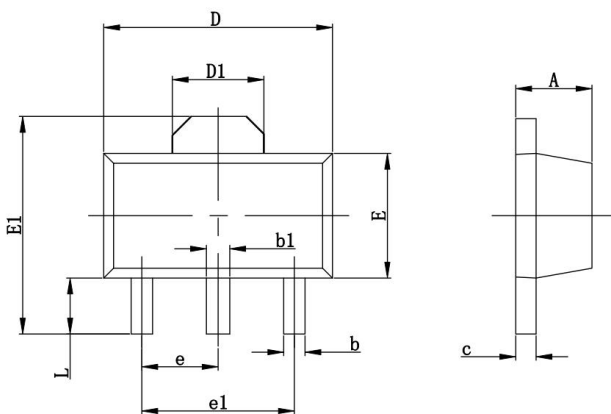
Package mechanical data

SOT-89-3L

Ref.	Dimensions					
	Millimeters			Inches		
	Min.	Typ.	Max.	Min.	Typ.	Max.
A	1.4		1.6	0.055		0.063
b	0.35		0.52	0.013		0.197
b1	0.4		0.58	0.016		0.023
c	0.35		0.44	0.014		0.017
D	4.4		4.6	0.173		0.181
D1		1.55			0.061	
E	2.35		2.55	0.091		0.102
E1	3.94		4.25	0.155		0.167
e		1.500			0.060	
e1		3.000			0.118	
L	0.9		1.1	0.035		0.047



Jiangsu Weida Semiconductor Co., Ltd.

NPN Transistors

■ Typical Characteristics

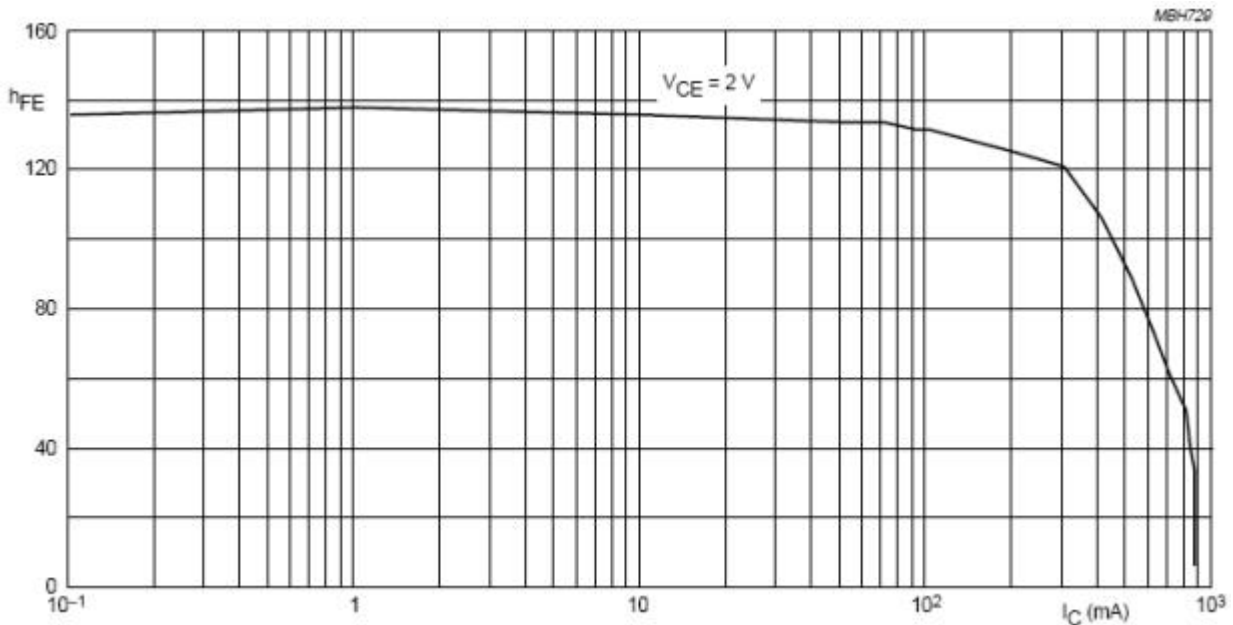

Information furnished in this document is believed to be accurate and reliable. However, Jiangsu Weida Semiconductor Co., Ltd assumes no responsibility for the consequences of use without consideration for such information nor use beyond it.

Information mentioned in this document is subject to change without notice, apart from that when an agreement is signed, Jiangsu Weida Semiconductor Co., Ltd complies with the agreement.

Products and information provided in this document have no infringement of patents. Jiangsu Weida Semiconductor Co., Ltd assumes no responsibility for any infringement of other rights of third parties which may result from the use of such products and information.

X-ON Electronics

Largest Supplier of Electrical and Electronic Components

Click to view similar products for [Bipolar Transistors - BJT category](#):

Click to view products by [Weida Semiconductor manufacturer](#):

Other Similar products are found below :

[BC559C](#) [MCH4017-TL-H](#) [MMBT-2369-TR](#) [BC546/116](#) [NJVMJD148T4G](#) [NTE16](#) [NTE195A](#) [IMX9T110](#) [2N4401-A](#) [2N6728](#) [2SA1419T-TD-H](#) [2SB1204S-TL-E](#) [2SC5488A-TL-H](#) [FMC5AT148](#) [2N2369ADCSM](#) [2N2907A](#) [2N3904-NS](#) [2N5769](#) [2SC4618TLN](#) [CPH6501-TL-E](#) [US6T6TR](#) [BAX18/A52R](#) [BC556/112](#) [IMZ2AT108](#) [MMST8098T146](#) [MCH6102-TL-E](#) [BC846B-13-F](#) [2N3879](#) [30A02MH-TL-E](#) [NTE13](#) [NTE282](#) [NTE323](#) [NTE350](#) [NTE81](#) [JANTX2N2920L](#) [JANSR2N2907AUB](#) [CMLT3946EG TR](#) [SNSS40600CF8T1G](#) [CMLT3906EG TR](#) [GRP-DATA-JANS2N2907AUB](#) [GRP-DATA-JANS2N2222AUA](#) [MMDT3946FL3-7](#) [2N4240](#) [JANS2N3019](#) [MSB30KH-13](#) [2N2221AUB](#) [2SD1815T-TL-E](#) [2N6678](#) [2N2907Ae4](#) [JAN2N3507](#)