

HDC-C-HE-SM2.5AG**Weidmüller Interface GmbH & Co. KG**

Klingenbergstraße 26

D-32758 Detmold

Germany

www.weidmueller.com



Crimps provide a electrical and mechanical connection between wire and contact that is both secure and reliable. The optimal crimp connection is gas-tight and corrosion-resistant.

General ordering data

| | |
|------------|---|
| Version | Heavy-duty connectors, Crimp contact, HE, HEE, HQ, MixMate, Pin, Conductor cross-section, max.: 2.5, turned, Copper alloy |
| Order No. | 1200800000 |
| Type | HDC-C-HE-SM2.5AG |
| GTIN (EAN) | 4008190131913 |
| Qty. | 100 pc(s). |

Creation date September 16, 2022 2:05:31 AM CEST

Catalogue status 09.09.2022 / We reserve the right to make technical changes.

HDC-C-HE-SM2.5AG**Weidmüller Interface GmbH & Co. KG**

Klingenbergstraße 26

D-32758 Detmold

Germany

www.weidmueller.com

Technical data**Dimensions and weights**

| | | | |
|----------|--------|------------|--------|
| Diameter | 4.5 mm | Net weight | 1.32 g |
|----------|--------|------------|--------|

Environmental Product Compliance

| | | | |
|------------|----------------|------|----------------------------------|
| REACH SVHC | Lead 7439-92-1 | SCIP | 6eabd5ae-2d6b-409e-8bdf-87c27ee1 |
|------------|----------------|------|----------------------------------|

General data

| | | | |
|------------------------------------|----------------------|----------------------------------|---------------------|
| Conductor cross-section, max. | 2.5 mm ² | Contact diameter, male Ø | 2.5 mm |
| Contact material | Copper alloy | Cross-section for connected wire | 2.5 mm ² |
| Material | Copper alloy | Plugging cycles | ≥ 500 |
| Production methods | turned | Series | HE |
| Stripping length, rated connection | 7.5 mm | Surface finish | silver |
| Type | Pin | Type of connection | Crimp connection |
| Version insert | HE, HEE, HQ, MixMate | Volume resistance | ≤2 mΩ |

Classifications

| | | | |
|-------------|-------------|-------------|-------------|
| ETIM 6.0 | EC000796 | ETIM 7.0 | EC000796 |
| ETIM 8.0 | EC000796 | ECLASS 9.0 | 27-44-02-04 |
| ECLASS 9.1 | 27-44-02-04 | ECLASS 10.0 | 27-44-02-04 |
| ECLASS 11.0 | 27-44-02-04 | ECLASS 12.0 | 27-44-02-04 |

Approvals

Approvals



| | |
|-------------------------|------------|
| ROHS | Conform |
| UL File Number Search | UL Website |
| Certificate No. (cURus) | E92202 |

Downloads

| | |
|------------------|--|
| Engineering Data | CAD data – STEP |
| Engineering Data | EPLAN, WSCAD, Zuken E3.S |
| Catalogues | Catalogues in PDF-format |
| Brochures | FL FIELDWIRING EN FL FIELDWIRING EN |

HDC-C-HE-SM2.5AG

Weidmüller Interface GmbH & Co. KG
 Klingenbergstraße 26
 D-32758 Detmold
 Germany

www.weidmueller.com

Drawings

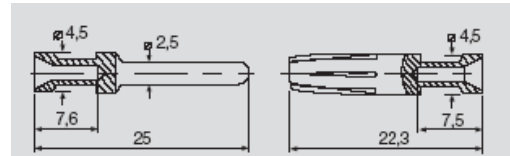

| Leiterquerschnitt | Abisolierlänge | |
|-----------------------------|----------------|--------|
| 0,50 mm ² | AWG 20 | 7,5 mm |
| 0,75 - 1,00 mm ² | AWG 18 | 7,5 mm |
| 1,50 mm ² | AWG 16 | 7,5 mm |
| 2,50 mm ² | AWG 14 | 7,5 mm |
| 4,00 mm ² | AWG 12 | 7,5 mm |

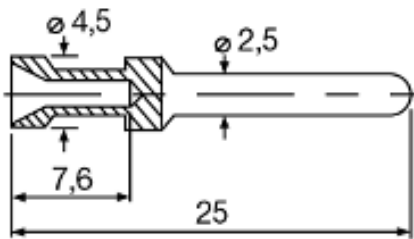

X-ON Electronics

Largest Supplier of Electrical and Electronic Components

Click to view similar products for [Heavy Duty Power Connectors](#) category:

Click to view products by [Weidmuller](#) manufacturer:

Other Similar products are found below :

[6646058-2](#) [6646137-1](#) [6646138-1](#) [6646940-1](#) [6651091-1](#) [6651525-1](#) [6651529-1](#) [696475-1](#) [702-32-01109](#) [73000005059](#) [73080254296](#)
[73080965046](#) [7310205040001](#) [765-15-0080A](#) [765-16-0080B](#) [765-18-0080D](#) [PS00/A0620/6300](#) [129-1J](#) [E6374G1](#) [157-43GW8](#) [MS3117-](#)
[14AC](#) [1643543-1](#) [1766966-1](#) [1791340000](#) [NLDFT-3-BL-L-S120-M40A](#) [NLDFT-N-W-L-C240-M40B](#) [1926015-1](#) [NLS-N-W-C240-M40B](#) [2-](#)
[1589900-8](#) [2199314-1](#) [KA8102](#) [9300480317](#) [294-0091-01100](#) [296-0040-01100](#) [1648582-1](#) [A32595-0049](#) [1766249-1](#) [1766280-1](#) [1766818-1](#)
[AN0264023](#) [279-0841-10100A](#) [30-9717](#) [RMSB4](#) [4729](#) [492H414-9-01](#) [BSB5](#) [419-2083-301](#) [LCDX4/0-14B-X](#) [075-8519-001](#) [078238-1613](#)