

**BLDT 5.08/10/- SN OR BX**
**Weidmüller Interfaces GmbH & Co. KG**

Postfach 3030

32760 Detmold

Tel. +49 5231 14-0

Fax. +49 5231 14-2083

info@weidmueller.com

www.weidmueller.com

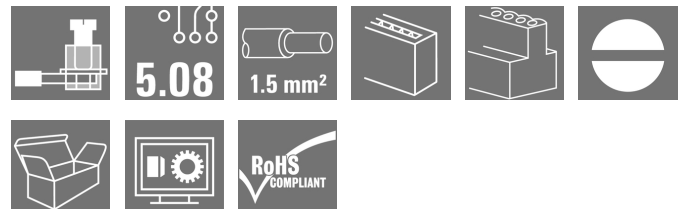
**Product image**

Female plugs with two clamping-yoke screw connections per pole for wire connections with 90° and 270° outlet directions. The female plugs provide space for labelling and can be coded.

**General ordering data**

|              |                                                                                                                                            |
|--------------|--------------------------------------------------------------------------------------------------------------------------------------------|
| Version      | PCB plug-in connector, female plug, 5.08 mm, Number of poles: 10, 90°/270°, Clamping yoke connection, Clamping range, max. : 3.31 mm², Box |
| Order No.    | <a href="#">1644810000</a>                                                                                                                 |
| Type         | BLDT 5.08/10/- SN OR BX                                                                                                                    |
| GTIN (EAN)   | 4008190284022                                                                                                                              |
| Qty.         | 30 pc(s).                                                                                                                                  |
| Product data | IEC: 400 V / 14 A / 0.2 - 2.5 mm²<br>UL: 300 V / 10 A / AWG 26 - AWG 12                                                                    |
| Packaging    | Box                                                                                                                                        |

**BLDT 5.08/10/- SN OR BX**

Weidmüller Interfaces GmbH &amp; Co. KG

Postfach 3030

32760 Detmold

Tel. +49 5231 14-0

Fax. +49 5231 14-2083

info@weidmuller.com

www.weidmuller.com

**Technical data****Dimensions and weights**

|            |         |                 |            |
|------------|---------|-----------------|------------|
| Depth      | 26.8 mm | Depth (inches)  | 1.055 inch |
| Height     | 23.3 mm | Height (inches) | 0.917 inch |
| Width      | 50.8 mm | Width (inches)  | 2 inch     |
| Net weight | 32.52 g |                 |            |

**System Parameters**

|                                              |                                     |                   |                            |
|----------------------------------------------|-------------------------------------|-------------------|----------------------------|
| Product family                               | OMNIMATE Signal - series BL/SL 5.08 |                   |                            |
| Type of connection                           | Field connection                    |                   |                            |
| Wire connection method                       | Clamping yoke connection            |                   |                            |
| Pitch in mm (P)                              | 5.08 mm                             |                   |                            |
| Pitch in inches (P)                          | 0.2 inch                            |                   |                            |
| Conductor outlet direction                   | 90°/270°                            |                   |                            |
| Number of poles                              | 10                                  |                   |                            |
| L1 in mm                                     | 45.72 mm                            |                   |                            |
| L1 in inches                                 | 1.8 inch                            |                   |                            |
| Number of rows                               | 1                                   |                   |                            |
| Pin series quantity                          | 1                                   |                   |                            |
| Rated cross-section                          | 2.5 mm <sup>2</sup>                 |                   |                            |
| Touch-safe protection acc. to DIN VDE 57 106 | Safe from finger touch              |                   |                            |
| Touch-safe protection acc. to DIN VDE 0470   | IP 20                               |                   |                            |
| Protection degree                            | IP20                                |                   |                            |
| Volume resistance                            | ≤5 mΩ                               |                   |                            |
| Can be coded                                 | Yes                                 |                   |                            |
| Stripping length                             | 7 mm                                |                   |                            |
| Clamping screw                               | M 2.5                               |                   |                            |
| Screwdriver blade                            | 0.6 x 3.5                           |                   |                            |
| Screwdriver blade standard                   | DIN 5264                            |                   |                            |
| Plugging cycles                              | 25                                  |                   |                            |
| Plugging force/pole, max.                    | 10 N                                |                   |                            |
| Pulling force/pole, max.                     | 7.5 N                               |                   |                            |
| Tightening torque                            | Torque type                         | Wire connection   |                            |
|                                              | Usage information                   | Tightening torque | min. 0.4 Nm<br>max. 0.5 Nm |

**Material data**

|                                       |                            |                                       |        |
|---------------------------------------|----------------------------|---------------------------------------|--------|
| Insulating material                   | PBT                        | Colour                                | orange |
| Colour chart (similar)                | RAL 2000                   | Insulating material group             | IIIa   |
| Comparative Tracking Index (CTI)      | ≥ 200                      | UL 94 flammability rating             | V-0    |
| Contact material                      | Copper alloy               | Contact surface                       | tinned |
| Layer structure of plug contact       | 4...8 μm Sn hot-dip tinned | Storage temperature, min.             | -40 °C |
| Storage temperature, max.             | 70 °C                      | Operating temperature, min.           | -50 °C |
| Operating temperature, max.           | 100 °C                     | Temperature range, installation, min. | -25 °C |
| Temperature range, installation, max. | 100 °C                     |                                       |        |

**Conductors suitable for connection**

|                                         |                      |
|-----------------------------------------|----------------------|
| Clamping range, min.                    | 0.13 mm <sup>2</sup> |
| Clamping range, max.                    | 3.31 mm <sup>2</sup> |
| Wire connection cross section AWG, min. | AWG 26               |

Creation date September 16, 2022 8:38:48 AM CEST

Catalogue status 09.09.2022 / We reserve the right to make technical changes.

## BLDT 5.08/10/- SN OR BX

Weidmüller Interfaces GmbH & Co. KG

Postfach 3030

32760 Detmold

Tel. +49 5231 14-0

Fax. +49 5231 14-2083

info@weidmueller.com

www.weidmueller.com

## Technical data

|                                                 |                          |
|-------------------------------------------------|--------------------------|
| Wire connection cross section AWG, max.         | AWG 12                   |
| Solid, min. H05(07) V-U                         | 0.2 mm <sup>2</sup>      |
| Solid, max. H05(07) V-U                         | 2.5 mm <sup>2</sup>      |
| Flexible, min. H05(07) V-K                      | 0.2 mm <sup>2</sup>      |
| Flexible, max. H05(07) V-K                      | 2.5 mm <sup>2</sup>      |
| w. plastic collar ferrule, DIN 46228 pt 4, min. | 0.2 mm <sup>2</sup>      |
| w. plastic collar ferrule, DIN 46228 pt 4, max. | 1.5 mm <sup>2</sup>      |
| w. wire end ferrule, DIN 46228 pt 1, min.       | 0.2 mm <sup>2</sup>      |
| w. wire end ferrule, DIN 46228 pt 1, max.       | 1.5 mm <sup>2</sup>      |
| Plug gauge in accordance with EN 60999 a x b; ø | 2.4 mm x 1.5 mm ; 2.4 mm |

| Clampable conductor                    | Cross-section for conductor connection | Type                         | fine-wired              |
|----------------------------------------|----------------------------------------|------------------------------|-------------------------|
|                                        |                                        | nominal                      | 0.5 mm <sup>2</sup>     |
| wire end ferrule                       |                                        | Stripping length             | nominal 6 mm            |
|                                        |                                        | Recommended wire-end ferrule | <a href="#">H0.5/6</a>  |
|                                        |                                        |                              |                         |
| Cross-section for conductor connection |                                        | Type                         | fine-wired              |
|                                        |                                        | nominal                      | 0.75 mm <sup>2</sup>    |
| wire end ferrule                       |                                        | Stripping length             | nominal 6 mm            |
|                                        |                                        | Recommended wire-end ferrule | <a href="#">H0.75/6</a> |
|                                        |                                        |                              |                         |
| Cross-section for conductor connection |                                        | Type                         | fine-wired              |
|                                        |                                        | nominal                      | 1 mm <sup>2</sup>       |
| wire end ferrule                       |                                        | Stripping length             | nominal 6 mm            |
|                                        |                                        | Recommended wire-end ferrule | <a href="#">H1.0/6</a>  |
|                                        |                                        |                              |                         |
| Cross-section for conductor connection |                                        | Type                         | fine-wired              |
|                                        |                                        | nominal                      | 1.5 mm <sup>2</sup>     |
| wire end ferrule                       |                                        | Stripping length             | nominal 7 mm            |
|                                        |                                        | Recommended wire-end ferrule | <a href="#">H1.5/7</a>  |
|                                        |                                        |                              |                         |

Reference text The outside diameter of the plastic collar should not be larger than the pitch (P). Length of ferrules is to be chosen depending on the product and the rated voltage.

### Rated data acc. to IEC

| tested acc. to standard                                                   | IEC 60664-1, IEC 61984 | Rated current, min. number of poles (Tu=20°C)                         | 14 A              |
|---------------------------------------------------------------------------|------------------------|-----------------------------------------------------------------------|-------------------|
| Rated current, max. number of poles (Tu=20°C)                             | 11.5 A                 | Rated current, min. number of poles (Tu=40°C)                         | 12 A              |
| Rated current, max. number of poles (Tu=40°C)                             | 10 A                   | Rated voltage for surge voltage class / pollution degree II/2         | 400 V             |
| Rated voltage for surge voltage class / pollution degree III/2            | 320 V                  | Rated voltage for surge voltage class / pollution degree III/3        | 250 V             |
| Rated impulse voltage for surge voltage class/ pollution degree II/2      | 4 kV                   | Rated impulse voltage for surge voltage class/ pollution degree III/2 | 4 kV              |
| Rated impulse voltage for surge voltage class/ contamination degree III/3 | 4 kV                   | Short-time withstand current resistance                               | 3 x 1s with 120 A |

**BLDT 5.08/10/- SN OR BX**

**Weidmüller Interfaces GmbH & Co. KG**

Postfach 3030

32760 Detmold

Tel. +49 5231 14-0

Fax. +49 5231 14-2083

info@weidmueller.com

www.weidmueller.com

**Technical data**

**Rated data acc. to CSA**

|                                   |                                                                                   |                                   |           |
|-----------------------------------|-----------------------------------------------------------------------------------|-----------------------------------|-----------|
| Institute (CSA)                   |  | Certificate No. (CSA)             | 12400-365 |
| Rated voltage (Use group B / CSA) | 300 V                                                                             | Rated voltage (Use group D / CSA) | 300 V     |
| Rated current (Use group B / CSA) | 10 A                                                                              | Rated current (Use group D / CSA) | 10 A      |
| Wire cross-section, AWG, min.     | AWG 26                                                                            | Wire cross-section, AWG, max.     | AWG 12    |
| Reference to approval values      | Specifications are maximum values, details - see approval certificate.            |                                   |           |

**Packing**

|           |        |            |        |
|-----------|--------|------------|--------|
| Packaging | Box    | VPE length | 348 mm |
| VPE width | 135 mm | VPE height | 31 mm  |

**Classifications**

|             |             |             |             |
|-------------|-------------|-------------|-------------|
| ETIM 6.0    | EC002638    | ETIM 7.0    | EC002638    |
| ETIM 8.0    | EC002638    | ECLASS 9.0  | 27-44-03-09 |
| ECLASS 9.1  | 27-44-03-09 | ECLASS 10.0 | 27-44-03-09 |
| ECLASS 11.0 | 27-46-02-02 | ECLASS 12.0 | 27-46-02-02 |

**Important note**

|                |                                                                                                                                                                                                                                                                                                                                                                                                                                                                                                                                                                                                                                                                                                    |
|----------------|----------------------------------------------------------------------------------------------------------------------------------------------------------------------------------------------------------------------------------------------------------------------------------------------------------------------------------------------------------------------------------------------------------------------------------------------------------------------------------------------------------------------------------------------------------------------------------------------------------------------------------------------------------------------------------------------------|
| IPC conformity | Conformity: The products are developed, manufactured and delivered according international recognized standards and norms and comply with the assured properties in the data sheet resp. fulfill decorative properties in accordance with IPC-A-610 "Class 2". Further claims on the products can be evaluated on request.                                                                                                                                                                                                                                                                                                                                                                         |
| Notes          | <ul style="list-style-type: none"> <li>• Additional variants on request</li> <li>• Gold-plated contact surfaces on request</li> <li>• Rated current related to rated cross-section &amp; min. No. of poles.</li> <li>• Wire end ferrule without plastic collar to DIN 46228/1</li> <li>• Wire end ferrule with plastic collar to DIN 46228/4</li> <li>• P on drawing = pitch</li> <li>• Rated data refer only to the component itself. Clearance and creepage distances to other components are to be designed in accordance with the relevant application standards.</li> <li>• Long term storage of the product with average temperature of 50 °C and average humidity 70%, 36 months</li> </ul> |

**Approvals**

|           |                                                                                     |
|-----------|-------------------------------------------------------------------------------------|
| Approvals |  |
| ROHS      | Conform                                                                             |

**Data sheet**

**BLDT 5.08/10/- SN OR BX**

**Weidmüller Interfaces GmbH & Co. KG**

Postfach 3030

32760 Detmold

Tel. +49 5231 14-0

Fax. +49 5231 14-2083

[info@weidmueller.com](mailto:info@weidmueller.com)

[www.weidmueller.com](http://www.weidmueller.com)

**Technical data**

**Downloads**

|                                             |                                                 |
|---------------------------------------------|-------------------------------------------------|
| Approval/Certificate/Document of Conformity | <a href="#">Declaration of the Manufacturer</a> |
| Engineering Data                            | <a href="#">CAD data – STEP</a>                 |
| Engineering Data                            | <a href="#">EPLAN, WSCAD</a>                    |
| Catalogues                                  | <a href="#">Catalogues in PDF-format</a>        |
| Brochures                                   | <a href="#">FL DRIVES EN</a>                    |
|                                             | <a href="#">MB DEVICE MANUF. EN</a>             |
|                                             | <a href="#">FL DRIVES DE</a>                    |
|                                             | <a href="#">FL BUILDING SAFETY EN</a>           |
|                                             | <a href="#">FL APPL LED LIGHTING EN</a>         |
|                                             | <a href="#">FLIndustr.CONTROLS EN</a>           |
|                                             | <a href="#">FL MACHINE SAFETY EN</a>            |
|                                             | <a href="#">FL HEATING ELECTR EN</a>            |
|                                             | <a href="#">FL APPL INVERTER EN</a>             |
|                                             | <a href="#">FL_BASE_STATION_EN</a>              |
|                                             | <a href="#">FL ELEVATOR EN</a>                  |
|                                             | <a href="#">FL POWER SUPPLY EN</a>              |
|                                             | <a href="#">FL 72H SAMPLE SER EN</a>            |
| <a href="#">PO OMNIMATE EN</a>              |                                                 |
| <a href="#">PO OMNIMATE EN</a>              |                                                 |

**BLDT 5.08/10/- SN OR BX**

**Weidmüller Interfaces GmbH & Co. KG**

Postfach 3030

32760 Detmold

Tel. +49 5231 14-0

Fax. +49 5231 14-2083

**Drawings**

info@weidmueller.com

**Product image**

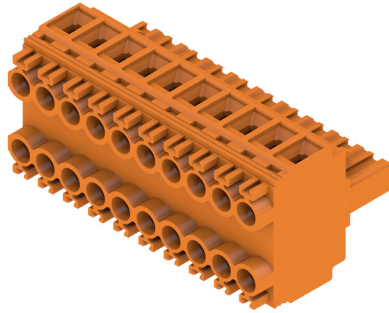

**Dimensional drawing**

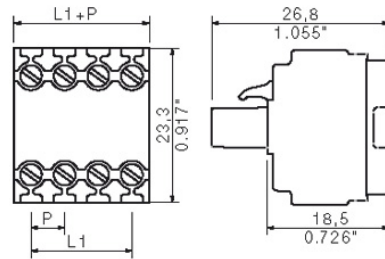

**Graph**

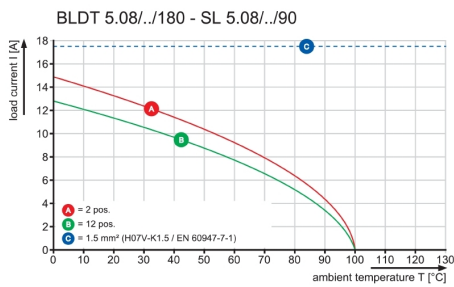

DIE DEUTSCHE VERSION IST VERBINDLICH  
THE GERMAN VERSION IS BINDING

WEITERGABE SOWIE VERVIELFÄLTIGUNG DIESES DOKUMENTS, VERWERTUNG UND MITTEILUNG SEINES INHALTS SIND VERBOTEN, SOWEIT NICHT AUSDRUECKLICH GESTATET.  
ZUWIDERHANDLUNGEN VERPFLICHTEN ZU SCHADENERSATZ. ALLE RECHTE FUER DEN FALL DER PATENT-, GEBRAUCHSMUSTER- ODER GESCHMACKSMUSTEREINTRAGUNG VORBEHALTEN.  
THE REPRODUCTION, DISTRIBUTION AND UTILIZATION OF THIS DOCUMENT AS WELL AS THE COMMUNICATION OF ITS CONTENTS TO OTHERS WITHOUT EXPLICIT AUTHORIZATION IS PROHIBITED.  
OFFENDERS WILL BE HELD LIABLE FOR THE PAYMENT OF DAMAGES. ALL RIGHTS RESERVED IN THE EVENT OF THE GRANT OF A PATENT, UTILITY MODEL OR DESIGN.

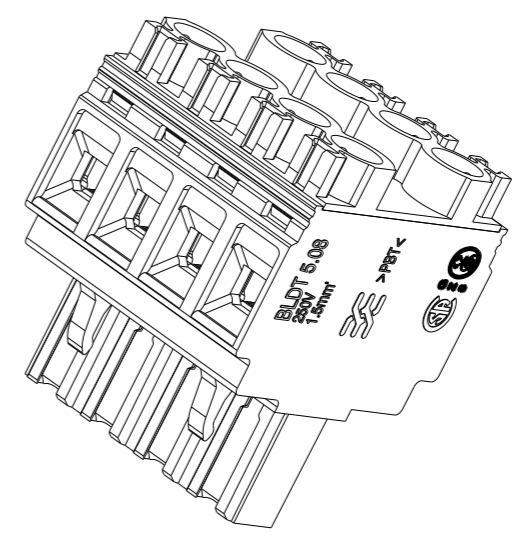
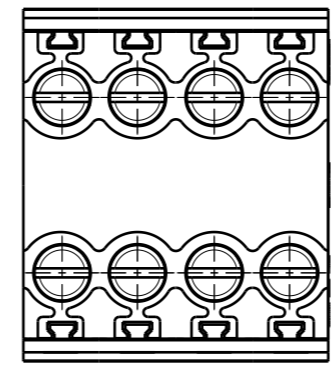
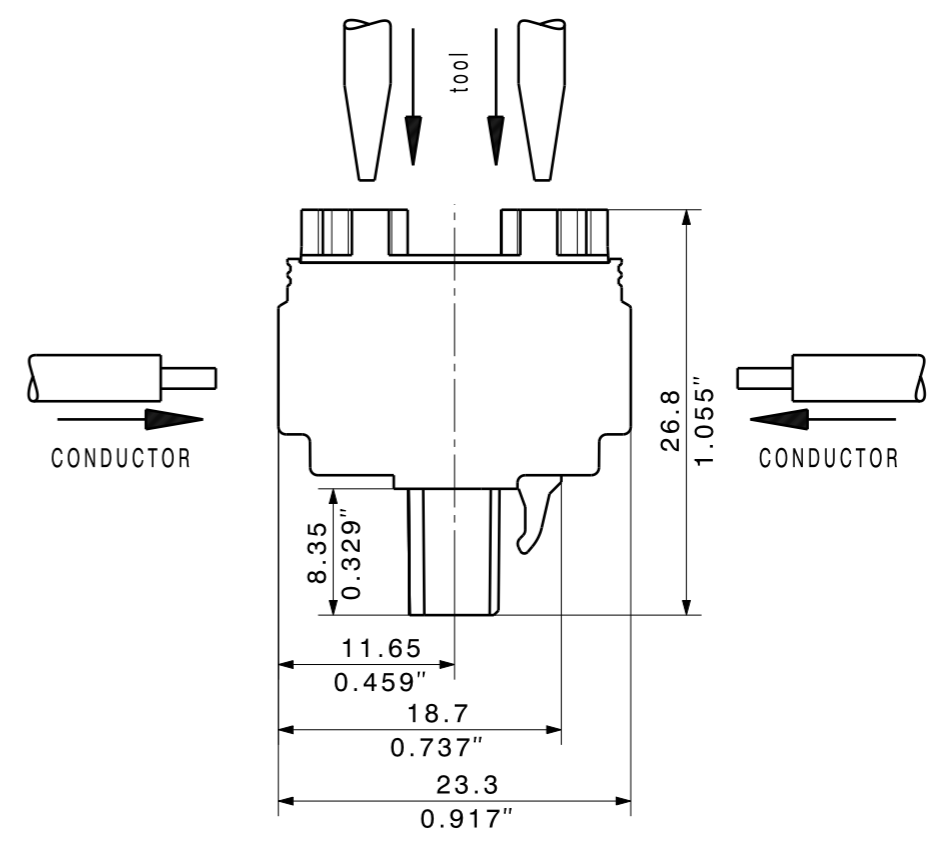
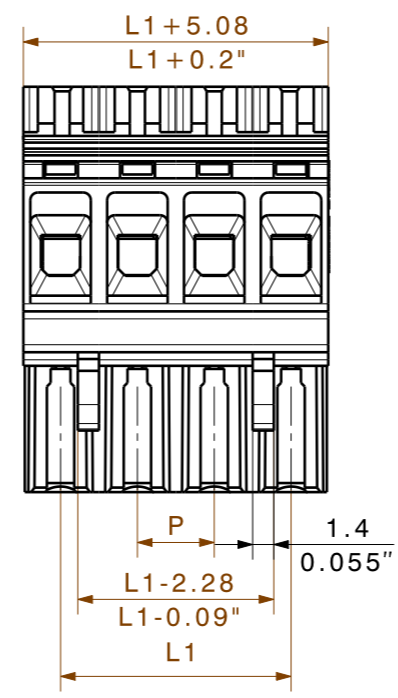

|    |         |           |
|----|---------|-----------|
| 12 | 55,88   | 2,200     |
| 11 | 50,80   | 2,000     |
| 10 | 45,72   | 1,800     |
| 9  | 40,64   | 1,600     |
| 8  | 35,56   | 1,400     |
| 7  | 30,48   | 1,200     |
| 6  | 25,40   | 1,000     |
| 5  | 20,32   | 0,800     |
| 4  | 15,24   | 0,600     |
| 3  | 10,16   | 0,400     |
| 2  | 5,08    | 0,200     |
| n  | L1 [mm] | L1 [Inch] |

For the mounting of PCBs, it should be noted that the rated data stated here relates only to the PCB components alone.  
The necessary creepage and clearance paths must be observed in connection with the respective applicant in accordance to IEC 664 / VDE 0110.  
The current-carrying capacity and pitch tolerance is to be determined according to DIN IEC 326 part 3 very fine.  
Weidmüller PCB components are tested to the DIN EN 61984 standard, and are valid for its field of application.  
Provided that the components are used to the intended purpose, all requirements with respect to the occurring of electrical, mechanical, thermic and corrosive stress will be satisfied.

SHOWN:BLDT 5.08/04

|                                      |  |                                |            |                                                          |  |
|--------------------------------------|--|--------------------------------|------------|----------------------------------------------------------|--|
| GENERAL TOLERANCE:<br>DIN ISO 2768-m |  | 78271/5<br>07.10.14 AMANN_A 00 |            | CAT.NO.: .                                               |  |
| RoHS COMPLIANT                       |  | MODIFICATION                   |            | Weidmüller                                               |  |
| DRAWN                                |  | DATE                           | NAME       | DRAWING NO. <b>C 21389</b> 07                            |  |
| RESPONSIBLE                          |  | 02.11.2007                     | HELIS_MA   | ISSUE NO.                                                |  |
| SUPERSEDES: -                        |  | CHECKED                        | 07.10.2014 | SHEET 01 OF 02 SHEETS                                    |  |
| SUPERSEDED BY: .                     |  | APPROVED                       | LANG_T     | PRODUCT FILE:BLDT 5.08                                   |  |
|                                      |  |                                |            | <b>BLDT 5.08/../(B)</b><br>Buchsenleiste<br>SOCKET BLOCK |  |
|                                      |  |                                |            | 7129                                                     |  |

## X-ON Electronics

Largest Supplier of Electrical and Electronic Components

*Click to view similar products for [Weidmuller manufacturer:](#)*

Other Similar products are found below :

[9926252205](#) [1527710000](#) [1596520000](#) [1697190000](#) [1726520000](#) [8924550000](#) [8950710000](#) [56956](#) [0126700000](#) [6720000227](#) [6720005111](#)  
[6720005330](#) [68676](#) [69236](#) [69718](#) [EXO24CH](#) [7940000218](#) [8432240000](#) [8463580000](#) [8581180000](#) [8881610000](#) [9001080000](#) [9002660000](#)  
[9003720000](#) [9008380000](#) [9012020000](#) [9025800000](#) [9032010000](#) [9032020000](#) [903708](#) [9046390000](#) [9104673500](#) [910640](#) [9129643500](#)  
[913155](#) [9159530000](#) [919656](#) [919764](#) [9202230000](#) [9202850000](#) [9203710000](#) [9204640000](#) [9455640000](#) [9456750000](#) [9457913000](#) [980811](#)  
[980826](#) [9919371205](#) [1166660000](#) [11751](#)