

HDC CM 10 FC**Weidmüller Interface GmbH & Co. KG**

Klingenbergstraße 26

D-32758 Detmold

Germany

www.weidmueller.com

HD-series crimp contacts are used with the CM10 module. The crimp contact features a stainless steel spring. The top spring provides a secure and permanent grip on the crimp contact in the module.

Customized contact-release tools are available for taking apart the contacts. The CM10 module can be ordered with or without the integrated module-release aid. A removal tool is available for those modules that do not feature an integrated module-release aid.

General ordering data

Version	Heavy-duty connectors, HDC insert, ConCept module
Order No.	1758410000
Type	HDC CM 10 FC
GTIN (EAN)	4032248019632
Qty.	10 pc(s).

Creation date September 16, 2022 10:37:21 AM CEST

Catalogue status 09.09.2022 / We reserve the right to make technical changes.

HDC CM 10 FC

Weidmüller Interface GmbH & Co. KG

Klingenbergstraße 26

D-32758 Detmold

Germany

www.weidmueller.com

Technical data

Dimensions and weights

Depth	34 mm	Depth (inches)	1.339 inch
Height	40.4 mm	Height (inches)	1.591 inch
Width	11.4 mm	Width (inches)	0.449 inch
Net weight	12.2 g		

ConCept Pneumatic module

Colour	beige	UL 94 flammability rating	V-0
--------	-------	---------------------------	-----

Dimensions

Height of socket	40.4 mm	Total length base	34 mm
Width	11.4 mm		

General data

Insulating material	PC glass-fibre reinforced (UL-listed and railway-certified)	Insulation strength	10 ¹¹ Ω
Material	Polycarbonate, glass fibre reinforced	Number of poles	10
Pollution severity	3	Rated current (DIN EN 61984)	10 A
Rated impulse voltage (DIN EN 61984)	4 kV	Rated voltage (DIN EN 61984)	250 V
Series	ConCept module	Surge voltage category	III
Type	Female	UL 94 flammability rating	V-0
Volume resistance	≤4 mΩ		

Connection data PE

Connection type PE	Screw connection via module frame
--------------------	-----------------------------------

Version

Conductor cross-section, max.	2.5 mm ²	Conductor cross-section, min.	0.14 mm ²
Material	Polycarbonate, glass fibre reinforced	Stripping length, rated connection	8 mm
Type of connection	Crimp connection	Volume resistance	≤4 mΩ
Wire connection cross section AWG, max.	AWG 14	Wire connection cross section AWG, min.	AWG 26

Classifications

ETIM 6.0	EC000438	ETIM 7.0	EC000438
ETIM 8.0	EC000438	ECLASS 9.0	27-44-02-05
ECLASS 9.1	27-44-02-05	ECLASS 10.0	27-44-02-05
ECLASS 11.0	27-44-02-05	ECLASS 12.0	27-44-02-05

Approvals

Approvals



ROHS

Conform

Creation date September 16, 2022 10:37:21 AM CEST

Catalogue status 09.09.2022 / We reserve the right to make technical changes.

2

HDC CM 10 FC

Weidmüller Interface GmbH & Co. KG
Klingenbergstraße 26
D-32758 Detmold
Germany

www.weidmueller.com

Technical data**Downloads**

Approval/Certificate/Document of Conformity	Manufacturer's declaration
Engineering Data	CAD data – STEP
Engineering Data	WSCAD
Catalogues	Catalogues in PDF-format
Brochures	FL FIELDWIRING EN

Data sheet

HDC CM 10 FC

Weidmüller Interface GmbH & Co. KG
Klingenbergstraße 26
D-32758 Detmold
Germany

www.weidmueller.com

Drawings

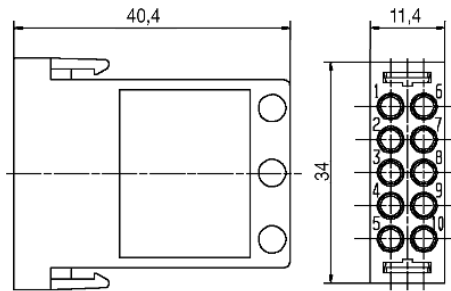

X-ON Electronics

Largest Supplier of Electrical and Electronic Components

Click to view similar products for [Weidmuller manufacturer](#):

Other Similar products are found below :

[0103300000](#) [0105620000](#) [0105820000](#) [0110020000](#) [0110060000](#) [0114660000](#) [0117500000](#) [0117510000](#) [0117920000](#) [0117960000](#)
[0117960000 AP SAK4-10](#) [011796 AP \(SAK4/6\)](#) [0117980000](#) [0117980000 AP SAK4-10 BL](#) [0119660000](#) [0119760000](#) [0119860000](#)
[0119960000](#) [0120060000](#) [0122800000](#) [012280 \(PACK OF 5\)](#) [0122810000](#) [0124300000](#) [0124400000](#) [0124700000](#) [0124800000](#) [0126160000](#)
[0126260000](#) [0126360000](#) [0126700000](#) [0128360000](#) [012836 SAK4](#) [0128380000](#) [012838 SAK4](#) [0130160000](#) [0131700000](#) [0132961027](#)
[0132961039](#) [0133360001](#) [0133360011](#) [0134220000](#) [0134500000](#) [0134700000](#) [0134920000](#) [0137100000](#) [0139160000](#) [0140200000](#)
[0141620000](#) [0146720000](#) [0150960000](#)