

## MPC (polycarbonate empty enclosure) MPC 17/17/15 7035

**Weidmüller Interface GmbH & Co. KG**  
Klingenbergstraße 16  
D-32758 Detmold  
Germany  
Fon: +49 5231 14-0  
Fax: +49 5231 14-292083  
www.weidmueller.com



Small and medium-sized polycarbonate housings The polycarbonate housings of the MPC series are ideal for building into electrical, electromechanical and pneumatic devices as well as PCBs. The enclosures are used in situations with extreme mechanical and chemical conditions.

#### Features:

- 9 sizes in 2 versions
- grey or transparent cover
- cover with lead-seal holes
- Mounting holes outside the seal area - receptacle threads for rail mounting, mounting plates and circuit board
- Comprehensive accessories Weidmüller can manufacture and supply the housing to match customer specifications, fitted with all necessary terminals and cable glands.

#### General ordering data

Type	MPC 17/17/15 7035
Order No.	<a href="#">9535430000</a>
Version	MPC (polycarbonate empty enclosure), Empty enclosure, Height: 175 mm, Width: 175 mm, Depth: 150 mm, Material: Polycarbonate, Light Grey
GTIN (EAN)	4032248016822
Qty.	1 pc(s).

**MPC (polycarbonate empty enclosure)  
MPC 17/17/15 7035**

**Weidmüller Interface GmbH & Co. KG**  
Klingenbergstraße 16  
D-32758 Detmold  
Germany  
Fon: +49 5231 14-0  
Fax: +49 5231 14-292083  
www.weidmueller.com

**Technical data**
**Dimensions and weights**

Width	175 mm	Width (inches)	6.89 inch
Height	175 mm	Height (inches)	6.89 inch
Depth	150 mm	Depth (inches)	5.905 inch
Weight	717 g	Net weight	731 g

**Cable glands, right**

M12	6	M16	4
-----	---	-----	---

**Cable glands, top/bottom**

M12	6	M16	4
M20	4		

**General information**

Areas of use	Building systems and technology, Transportation, Packaging industry, Machine construction	Material	Polycarbonate
Seal material	Polyurethane	Operating temperature, min.	-50 °C
Operating temperature, max.	130 °C	Protection degree	IP66, IP67
Enclosure attachment	Holes 4.5 mm	Lid attachment	4 polyamide crosshead screws
Integral fixing	thanks to self-tapping screws		

**General information on accessories**

Material	Polycarbonate
----------	---------------

**horizontal assembly**

WDU 10 / ZDU 10	1x11	WDU 16 / ZDU 16	1x9
WDU 2,5 / ZDU 2,5 / IDU 2,5	1x22	WDU 35 / ZDU 35	1x7
WDU 4 / ZDU 4	1x19	WDU 6 / ZDU 6	1x14

**vertical assembly**

WDU 10 / ZDU 10	1x11	WDU 16 / ZDU 16	1x9
WDU 2,5 / ZDU 2,5 / IDU 2,5	1x22	WDU 35 / ZDU 35	1x7
WDU 4 / ZDU 4	1x19	WDU 6 / ZDU 6	1x14

**Classifications**

ETIM 3.0	EC000058	ETIM 4.0	EC000058
ETIM 5.0	EC000058	ETIM 6.0	EC000261
UNSPSC	31-26-15-02	eClass 5.1	27-14-91-07
eClass 6.2	27-14-91-07	eClass 7.1	27-14-91-07
eClass 8.1	27-14-91-07	eClass 9.0	27-18-01-01
eClass 9.1	27-18-92-90		

**Data sheet****MPC (polycarbonate empty enclosure)  
MPC 17/17/15 7035****Weidmüller Interface GmbH & Co. KG**  
Klingenbergstraße 16  
D-32758 Detmold  
Germany  
Fon: +49 5231 14-0  
Fax: +49 5231 14-292083  
www.weidmueller.com**Technical data****Approvals**

Approvals



ROHS

Conform

**Downloads**

Brochure/Catalogue	<a href="#">CAT 5 ENCL 17/18 EN</a>
Engineering Data	<a href="#">EPLAN_WSCAD</a>
Engineering Data	<a href="#">STEP</a>

**Data sheet****MPC (polycarbonate empty enclosure)  
MPC 17/17/15 7035**

**Weidmüller Interface GmbH & Co. KG**  
Klingenbergstraße 16  
D-32758 Detmold  
Germany  
Fon: +49 5231 14-0  
Fax: +49 5231 14-292083  
[www.weidmueller.com](http://www.weidmueller.com)

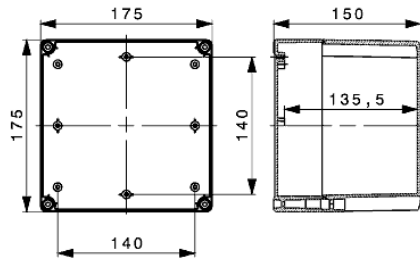
**Drawings**

## X-ON Electronics

Largest Supplier of Electrical and Electronic Components

*Click to view similar products for [Enclosures, Boxes, & Cases](#) category:*

*Click to view products by [Weidmuller](#) manufacturer:*

Other Similar products are found below :

[CR-425 PAINTED](#) [585-R-WH-PK](#) [M-10-PLATED](#) [60221-01](#) [60566-01-000](#) [HPL-9VB BATT DOOR](#) [M-16-LID-PLATED](#) [M18-PLTD](#) [M-21-LID-PLATED](#) [M-21-PLATED](#) [M-23-PLATED](#) [CU-281-MB](#) [6711GSKT](#) [71884-29-028](#) [LH45-100 Black](#) [7200B](#) [72868-510-000](#) [CNS-0000 Black](#) [72883-510-000](#) [CNS-0101 Black](#) [72906-510-000](#) [CNS-0407 Black](#) [73091-510-000](#) [CNM-0000-BLACK Kit](#) [73092-510-000](#) [CNM-0101 Black](#) [73108-510-000](#) [CNL-0303 Black](#) [73395-510-039](#) [CNS-0006 Bone](#) [74257-510-000](#) [CNL-0004](#) [MDC-1183-PLAIN-ALUM](#) [MDC-1183-PTD](#) [MDC-13104-PLAIN-ALUM](#) [MDC-211 - PAINTED IVORY/BEIGE](#) [MDC-321-PTD](#) [MDC-432-PLAIN-ALUM](#) [MDC-973-PTD](#) [76](#) [77153-01-028](#) [FLX6030](#) [83535-01-508](#) [PS-11296-G](#) [PS-11298-B](#) [116-508](#) [120-407](#) [120-412](#) [120-909](#) [120-455](#) [R272-100-000](#) [120-910](#) [R501-001-010](#) [R508-080-000](#) [R508-160-000](#) [R530-120-000](#) [R530-122-000](#) [R530-200-000](#) [R531-160-000](#) [R531-200-000](#) [R582-080-100](#)