

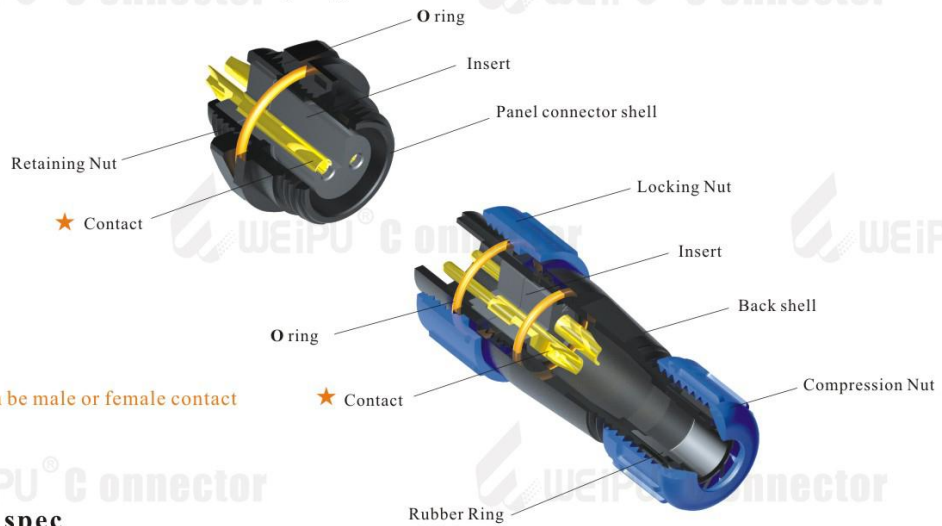

● SP13/SP17/SP21 IP68 Threaded coupling



★ Each side can be male or female contact

Material and spec

Product type	Connector	Overmolded Cable Assemblies
Coupling	Threaded coupling	Threaded coupling
Shell material	Nylon66, fire resistance : V-0	PC、PVC, fire resistance:V-0; Locking nut material: Anodized aluminum
Insert material	PPS max temperature 260 °C, fire resistance : V-0	PPS max temperature 260 °C, fire resistance : V-0
Contact material	Brass with gold plating	Brass with gold plating
Termination	SP13:solder, SP17:solder/crimp, SP21:solder / screw/crimp	
Cable outer diameter range	SP13 I: 4-6.5mm SP13 II: 5-8mm SP17 :6-10mm SP21 I: 4.5-7mm SP21 II:7-12mm	
IP rating	IP68	IP66
Mating cycle	>500	>500
Temperature range	-25°C~+85°C	-20°C~+85°C
Insulation resistance MΩ	2000	2000

**SP
13**

SP13 Series IP68

Cable connector

Mate with SP1311, SP1312



SP1310 / P

SP1310 / S

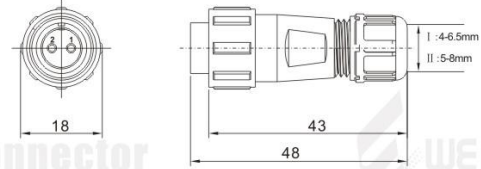

C: with cap, N: without cap
Cable outer diameter: I : 4-6.5mm , II :5-8mm
Number of contact: 2. 3. 4. 5. 6. 7. 9

In-line cable connector

Mate with SP1310



SP1311 / P

SP1311 / S

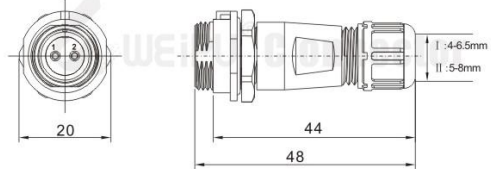

Front mount

Mate with SP1310



SP1312 / P

SP1312 / S

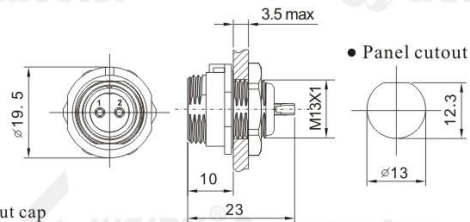

C: with cap, N: without cap
Number of contact: 2. 3. 4. 5. 6. 7. 9

Contact arrangement and spec for solder termination

Number of contact	2	3	4	5	6	7	9
Male contact face view							
Rated current (A)	13A	13A	5A	5A	5A	5A	3A
Contact diameter	∅ 1.6X2	∅ 1.6X3	∅ 1X4	∅ 1X5	∅ 1X6	∅ 1X7	∅ 0.7X9
Rated voltage (AC.V)	250V	250V	200V	180V	125V	125V	125V
Test voltage(AC.V) 1 min	1500V	1500V	1500V	1000V	1000V	1000V	1000V
Contact resistance mΩ	2	2	5	5	5	5	10
Wire size mm ² /AWG	≤2/14	≤2/14	≤0.785/18	≤0.785/18	≤0.785/18	≤0.785/18	≤0.785/18

X-ON Electronics

Largest Supplier of Electrical and Electronic Components

Click to view similar products for [Circular Metric Connectors](#) category:

Click to view products by [Weipu](#) manufacturer:

Other Similar products are found below :

[600X518037X](#) [MA1EAF1200](#) [6STD09SAM99B70X](#) [8R4A00A18M020](#) [1300140094](#) [130203-0054](#) [1300150099](#) [1-3637-600-5205](#) [1A4000-348](#) [8R4006A16M010](#) [8R5006A18A120](#) [1R3006A20M005](#) [RF-12P1N8A80DU](#) [RF-12P1N8A90DU](#) [41-01016](#) [41-40010](#) [41-40011](#) [41-40017](#) [42-01015](#) [4-22279-4](#) [4-22281-1](#) [4-22284-9](#) [43-10041](#) [41-40005](#) [41-40016](#) [43-00132](#) [XS3P-M421-2](#) [600X518050X](#) [SACC-DSI-FS-5P-PG9-L180 SC](#) [8R4000A16M010](#) [1R3004A20A1201](#) [N03FA03144](#) [1300140077](#) [41-01117](#) [XS2RD4265](#) [RSC 4/9](#) [XS2R-D426-1](#) [XS8A-0441](#) [859RD04-103R004](#) [860RD04-113R004](#) [860-X08-213R004](#) [1-213245-2](#) [2273142-2](#) [LC20-02PMFS-SW8001](#) [1604360](#) [21031121405](#) [MSAS-12PMMP-SF8001](#) [8P-04BFFB-SL7001](#) [21038122406](#) [41-50000](#)