

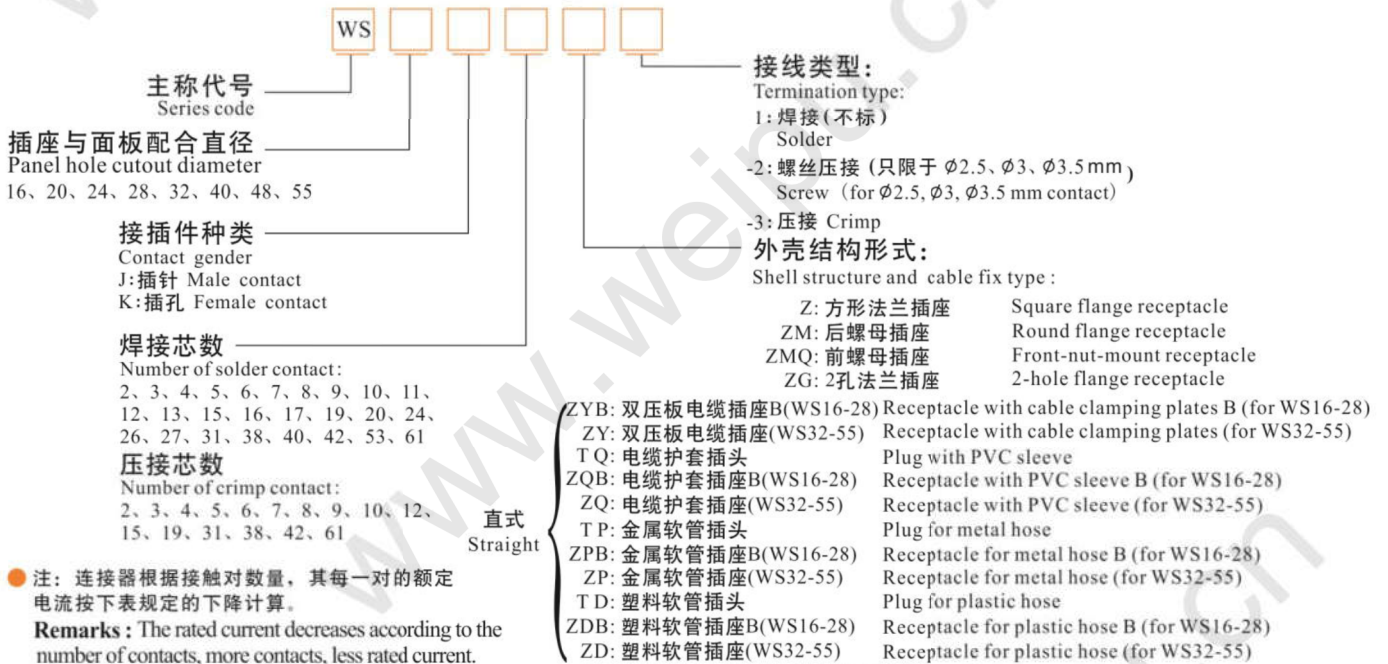

● WS系列 WS Series

型号 Part number system



● 注: 连接器根据接触对数量, 其每一对的额定电流按下表规定的下降计算。

Remarks: The rated current decreases according to the number of contacts, more contacts, less rated current.

| 接触对芯数<br>Number of contact             | 1~3 | 4~10 | 11~20 | 21~30 | 31~40 | 41~50 | 51~61 |
|--|-----|------|-------|-------|-------|-------|-------|
| 下降率 (%)<br>Rated current decrease rate | 0   | 10   | 20    | 30    | 40    | 50    | 60    |

★ 焊接芯件参数表见97-98页

Solder contact spec see page 97-98

★ 接触件可以是插针或插孔

Each side can be male or female contact

★ 压接芯件参数表见99-102页

Crimp contact spec see page 99-102

材料和技术参数 Material and spec

|       |                   |  |                                |
|-------|-------------------|--|--------------------------------|
| 接插方式  | Coupling          | 螺纹连接   | Threaded                       |
| 外壳材料  | Shell material    | 锌合金(镀铬)  | Zinc alloy with chrome plating |
| 绝缘体   | Insert material   | 热塑塑料PPS, 耐高温260℃   | PPS, max temperature 260 °C    |
| 接触件材料 | Contact material  | 铜(镀金)  | Brass with gold plating        |
| 接线方式  | Termination       | 焊接: $\phi 1$ 、 $\phi 2.5$ 、 $\phi 3.5$ 、 $\phi 5.5$ mm; 螺丝压接: $\phi 2.5$ 、 $\phi 3$ 、 $\phi 3.5$ mm; 压接: $\phi 1$ 、 $\phi 1.5$ 、 $\phi 2.5$ 、 $\phi 3.5$ 、 $\phi 5.5$ 、 $\phi 10$ mm<br>Solder: $\phi 1$ 、 $\phi 2.5$ 、 $\phi 3.5$ 、 $\phi 5.5$ mm; Screw: $\phi 2.5$ 、 $\phi 3$ 、 $\phi 3.5$ mm; Crimp: $\phi 1$ 、 $\phi 1.5$ 、 $\phi 2.5$ 、 $\phi 3.5$ 、 $\phi 5.5$ 、 $\phi 10$ mm |                                |
| 接插次数  | Mating cycle      | 500  |                                |
| 温度范围  | Temperature range | -40℃~+85℃  |                                |

### WS系列配套表 WS Series Mating diagram

◆ 方形法兰插座  
Square flange receptacle



Z

◆ 后螺母插座  
Round flange receptacle



ZM

◆ 前螺母插座  
Front-nut-mount receptacle

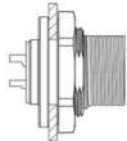

ZMQ

◆ 2孔法兰插座  
2-hole flange receptacle with cap

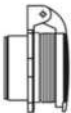

ZG

◆ 直式对接双压板电缆插座  
In-line receptacle with cable clamping plates

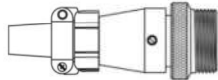

ZYB  
ZY

◆ 直式对接电缆护套插座  
In-line receptacle with PVC sleeve

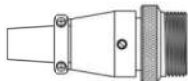

ZQB  
ZQ

◆ 直式对接金属软管插座  
In-line receptacle for metal hose

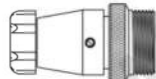

ZPB  
ZP

◆ 直式对接塑料软管插座  
In-line receptacle for plastic-hose

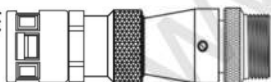

ZDB  
ZD

◆ 弯式对接金属软管插座  
In-line receptacle with angled back shell for metal-hose

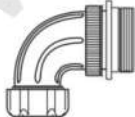

ZR

◆ 弯式对接双压板电缆插座  
In-line receptacle with angled back shell and cable clamping plates

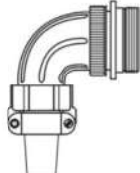

ZS

◆ 弯式对接塑料软管插座  
In-line receptacle with angled back shell for plastic-hose

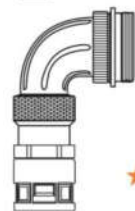

ZC

TQ

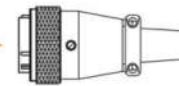

◆ 直式电缆护套插头  
Plug with PVC sleeve

TP

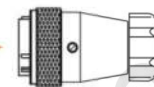

◆ 直式金属软管插头  
Plug for metal-hose

TD

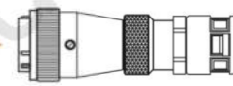

◆ 直式塑料软管插头  
Plug for plastic-hose

TS

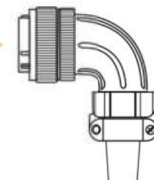

◆ 弯式双压板电缆插头  
Plug with angled back shell and cable clamping plates

TR

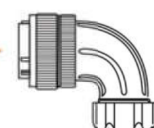

◆ 弯式金属软管插头  
Plug with angled back shell for metal-hose

TC



◆ 弯式塑料软管插头  
Plug with angled back shell for plastic-hose



◆ 插座塑料防尘盖  
Plastic receptacle cap

★ 接触件可以是插针或插孔  
Each side can be male or female contact

★ 焊接芯件参数表见97-98页  
Solder contact spec see page 97-98

★ 压接芯件参数表见99-102页  
Crimp contact spec see page 99-102



● 方形法兰插座: Z Square flange mount receptacle: Z

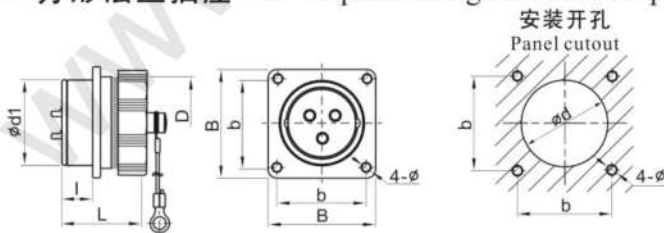

| 尺寸<br>Dimension(mm) | WS16  | WS20  | WS24  | WS28  | WS32    | WS40    | WS48    | WS55    |
|---------------------|-------|-------|-------|-------|---------|---------|---------|---------|
| $\phi d1$           | 15.8  | 19.8  | 23.8  | 27.8  | 31.8    | 39.8    | 47.8    | 54.8    |
| D                   | M18X1 | M22X1 | M26X1 | M30X1 | M35X1.5 | M44X1.5 | M52X1.5 | M59X1.5 |
| I                   | 9.7   | 9.8   | 10    | 9.8   | 14.4    | 14.2    | 14.2    | 14      |
| L                   | 21.6  | 23    | 23    | 23    | 34      | 34      | 34      | 34      |
| b                   | 20    | 22    | 26    | 30    | 32      | 40      | 48      | 52      |
| B                   | 26    | 29    | 32    | 36    | 42      | 50      | 58      | 64      |
| $\phi d$            | 16.5  | 20.5  | 24.5  | 28.5  | 32.5    | 40.5    | 48.5    | 55.5    |
| $\phi$              | 3.2   | 3.2   | 3.2   | 3.2   | 3.5     | 4.5     | 4.5     | 4.5     |

● 后螺母插座: ZM Round flange receptacle: ZM

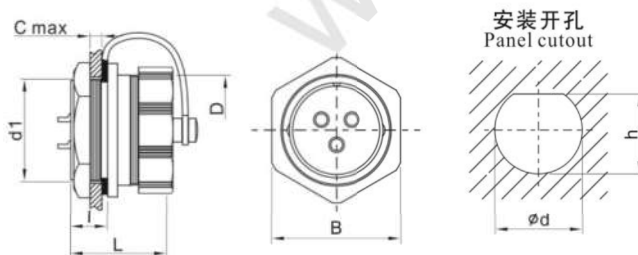

| 尺寸<br>Dimension(mm) | WS16  | WS20  | WS24  | WS28  |
|---------------------|-------|-------|-------|-------|
| d1                  | M16X1 | M20X1 | M24X1 | M28X1 |
| D                   | M18X1 | M22X1 | M26X1 | M30X1 |
| C                   | 5     | 5     | 5     | 5     |
| I                   | 9.7   | 9.9   | 10    | 10.2  |
| L                   | 22    | 23    | 23    | 23    |
| B                   | 21.2  | 25.5  | 29.2  | 33.3  |
| $\phi d$            | 15.7  | 19.7  | 23.9  | 27.7  |
| h                   | 15.3  | 19.3  | 23.2  | 26.9  |



● 前螺母插座: ZMQ IP67 Front-nut-mount receptacle: ZMQ IP67

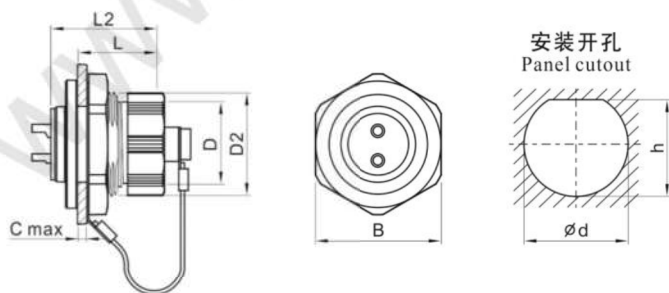

| 尺寸<br>Dimension(mm) | WS16  | WS20  | WS24  | WS28  |
|---------------------|-------|-------|-------|-------|
| $\phi D$            | M18X1 | M22X1 | M26X1 | M30X1 |
| D2                  | M22X1 | M26X1 | M30X1 | M34X1 |
| L                   | 16    | 17    | 17    | 17    |
| L2                  | 21.6  | 23    | 23    | 23    |
| C                   | 5     | 5     | 5     | 5     |
| B                   | 26.8  | 30.8  | 34.8  | 38.8  |
| $\phi d$            | 22    | 26    | 30    | 34    |
| h                   | 20.6  | 24.6  | 28.6  | 32.6  |

● 2孔法兰插座: ZG 2-hole flange receptacle with cap: ZG

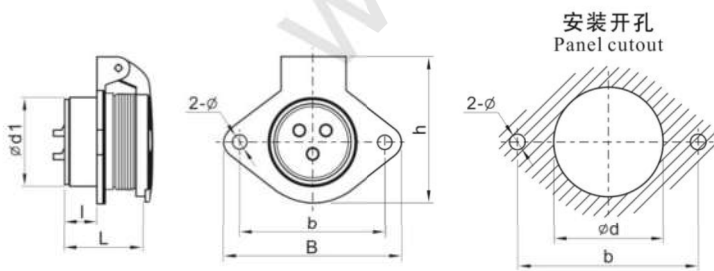

| 尺寸<br>Dimension(mm) | WS16 | WS20 | WS24 | WS28 | WS32 | WS40 | WS48 | WS55 |
|---------------------|------|------|------|------|------|------|------|------|
| $\phi d1$           | 15.8 | 19.8 | 23.8 | 27.8 | 31.8 | 39.8 | 47.8 | 54.8 |
| l                   | 10   | 10   | 10   | 10   | 15.4 | 14.7 | 14.3 | 14   |
| L                   | 22   | 23   | 23   | 23   | 34   | 34   | 34   | 34   |
| b                   | 30   | 35   | 40   | 45   | 55   | 65   | 80   | 85   |
| B                   | 38   | 44   | 50   | 55   | 67   | 77   | 92   | 98   |
| h                   | 32.5 | 36.5 | 40.5 | 45.5 | 52.5 | 63.5 | 74.5 | 80   |
| $\phi d$            | 16.5 | 20.5 | 24.5 | 28.5 | 32.5 | 40.5 | 48.5 | 55.5 |
| $\phi$              | 3.5  | 4.5  | 4.5  | 4.5  | 5.5  | 5.5  | 5.5  | 6.5  |



● 直式对接电缆护套插座B: ZQB In-line receptacle with PVC sleeve B: ZQB

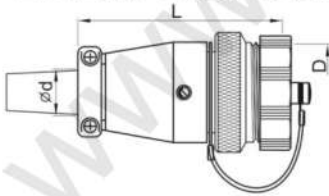

| 尺寸<br>Dimension(mm) | WS16  | WS20  | WS24  | WS28  |
|---------------------|-------|-------|-------|-------|
| D                   | M18X1 | M22X1 | M26X1 | M30X1 |
| L                   | 44.3  | 48.3  | 53.5  | 56    |
| ød max              | 10    | 11.6  | 12.4  | 15.7  |

护盖可订购尺寸见P93 Optional cap size see P93

● 直式对接电缆护套插座: ZQ In-line receptacle with PVC sleeve: ZQ

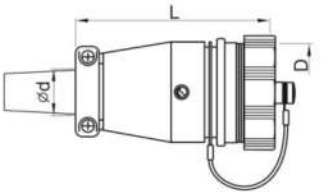

| 尺寸<br>Dimension(mm) | WS32    | WS40    | WS48    | WS55    |
|---------------------|---------|---------|---------|---------|
| D                   | M35X1.5 | M44X1.5 | M52X1.5 | M59X1.5 |
| L                   | 70      | 77      | 85      | 97      |
| ød max              | 19.5    | 24      | 24      | 30      |

护盖可订购尺寸见P93 Optional cap size see P93

● 直式对接金属软管插座B: ZPB In-line receptacle for metal-hose B: ZPB

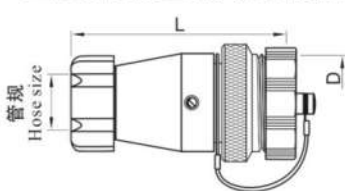

| 尺寸<br>Dimension(mm) | WS16  | WS20  | WS24  | WS28  |
|---------------------|-------|-------|-------|-------|
| D                   | M18X1 | M22X1 | M26X1 | M30X1 |
| L                   | 49.5  | 58    | 62    | 65    |
| 管规<br>Hose size     | 1/4"  | 3/8"  | 3/8"  | 1/2"  |

护盖可订购尺寸见第93页 Optional cap size see P93

● 直式对接金属软管插座: ZP In-line receptacle for metal-hose: ZP

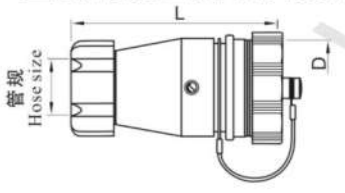

| 尺寸<br>Dimension(mm) | WS32    | WS40    | WS48                     | WS55    |
|---------------------|---------|---------|--------------------------|---------|
| D                   | M35X1.5 | M44X1.5 | M52X1.5                  | M59X1.5 |
| L                   | 75      | 99      | 103                      | 106     |
| 管规<br>Hose size     | 3/4"    | 1"      | I: 1" (不标)<br>II: 1 1/4" | 1 1/4"  |

护盖可订购尺寸见第93页 Optional cap size see P93

● 直式对接双压板电缆插座B: ZYB In-line receptacle with cable clamping plates B: ZYB

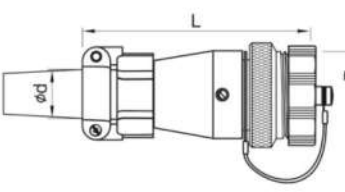

| 尺寸<br>Dimension(mm) | WS16  | WS20  | WS24  | WS28  |
|---------------------|-------|-------|-------|-------|
| D                   | M18X1 | M22X1 | M26X1 | M30X1 |
| L                   | 48.5  | 54.5  | 55.5  | 65.3  |
| ød max              | 10    | 13    | 13    | 17    |

护盖可订购尺寸见第93页 Optional cap size see P93

电缆护套尺寸见第93页 PVC sleeve dimension see P93

● 直式对接双压板电缆插座: ZY In-line receptacle with cable clamping plates: ZY

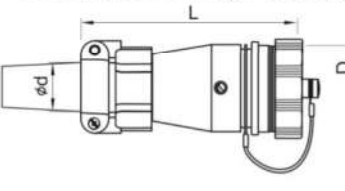

| 尺寸<br>Dimension(mm) | WS32    | WS40    | WS48                 | WS55    |
|---------------------|---------|---------|----------------------|---------|
| D                   | M35X1.5 | M44X1.5 | M52X1.5              | M59X1.5 |
| L                   | 89.2    | 94.8    | 101.8                | 124.7   |
| ød max              | 19      | 23      | I: 23 (不标)<br>II: 31 | 31      |

护盖可订购尺寸见第93页 Optional cap size see P93

电缆护套尺寸见第93页 PVC sleeve dimension see P93



● 直式对接塑料软管插座B: ZDB In-line receptacle for plastic-hose B: ZDB

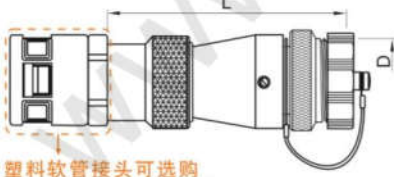

塑料软管接头可选购  
Optional plastic hose adapter

| 尺寸<br>Dimension(mm)  | WS16  | WS20  | WS24  | WS28  |
|----------------------|-------|-------|-------|-------|
| D                    | M18X1 | M22X1 | M26X1 | M30X1 |
| L                    | 55.5  | 64.5  | 69    | 75.5  |
| 接头规格<br>Adapter size | PG7   | PG11  | PG11  | PG16  |
| 管规<br>Hose size      | 1/4"  | 3/8"  | 3/8"  | 1/2"  |

护盖可选购尺寸见第93页 Optional cap size see P93

● 直式对接塑料软管插座: ZD In-line receptacle for plastic-hose: ZD

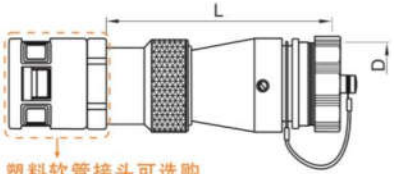

塑料软管接头可选购  
Optional plastic hose adapter

| 尺寸<br>Dimension(mm)  | WS32    | WS40    | WS48                     | WS55    |
|----------------------|---------|---------|--------------------------|---------|
| D                    | M35X1.5 | M44X1.5 | M52X1.5                  | M59X1.5 |
| L                    | 89.5    | 96.5    | 105                      | 119.5   |
| 接头规格<br>Adapter size | PG21    | PG29    | I: PG29 (不标)<br>II: PG36 | PG36    |
| 管规<br>Hose size      | 3/4"    | 1"      | I: 1" (不标)<br>II: 1 1/4" | 1 1/4"  |

护盖可选购尺寸见第93页 Optional cap size see P93

● 弯式对接金属软管插座: ZR In-line receptacle with angled back shell for metal-hose: ZR

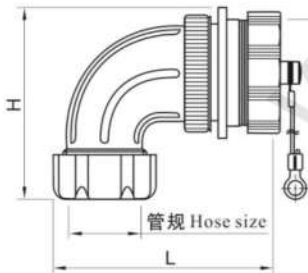

| 尺寸<br>Dimension(mm) |   | WS20  | WS24  | WS28  | WS32    | WS40    | WS48    | WS55    |
|---------------------|---|-------|-------|-------|---------|---------|---------|---------|
| D                   | — | M22X1 | M26X1 | M30X1 | M35X1.5 | M44X1.5 | M52X1.5 | M59X1.5 |
| L                   | — | 60    | 60    | 63    | 81      | 88      | 96      | 107     |
| H                   | — | 48    | 51    | 52    | 58      | 70      | 82      | 90      |
| 管规<br>Hose size     | — | 3/8"  | 3/8"  | 1/2"  | 3/4"    | 1"      | 1"      | 1 1/4"  |

护盖可选购尺寸见第93页 Optional cap size see P93

● 弯式对接双压板电缆插座: ZS In-line receptacle with angled back shell and cable clamping plates: ZS

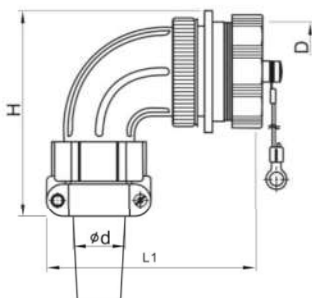

| 尺寸<br>Dimension(mm) |   | WS20  | WS24  | WS28  | WS32    | WS40    | WS48    | WS55    |
|---------------------|---|-------|-------|-------|---------|---------|---------|---------|
| D                   | — | M22X1 | M26X1 | M30X1 | M35X1.5 | M44X1.5 | M52X1.5 | M59X1.5 |
| L                   | — | 60.6  | 60.4  | 64.7  | 82      | 89.2    | 96      | 114.2   |
| H                   | — | 54.4  | 56.8  | 64    | 72      | 83.3    | 94.5    | 112.3   |
| $\phi d$ max        | — | 13    | 13    | 17    | 19      | 23      | 23      | 31      |

护盖可选购尺寸见第93页 Optional cap size see P93



● 弯式对接塑料软管插座: ZC In-line receptacle with angled back shell for plastic-hose: ZC

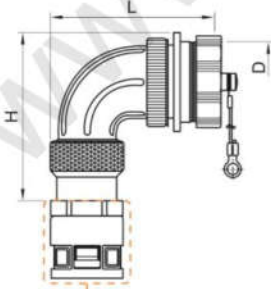

塑料软管接头可选购  
Optional plastic hose adapter

| 尺寸<br>Dimension(mm)  |   | WS20  | WS24  | WS28  | WS32    | WS40    | WS48    | WS55    |
|----------------------|---|-------|-------|-------|---------|---------|---------|---------|
| D                    | — | M22X1 | M26X1 | M30X1 | M35X1.5 | M44X1.5 | M52X1.5 | M59X1.5 |
| L                    | — | 60    | 61    | 63    | 82      | 88.5    | 95      | 112     |
| H                    | — | 88    | 88    | 98    | 110     | 120     | 135     | 140     |
| 接头规格<br>Adapter size | — | PG11  | PG11  | PG16  | PG21    | PG29    | PG29    | PG36    |
| 管规<br>Hose size      | — | 3/8"  | 3/8"  | 1/2"  | 3/4"    | 1"      | 1"      | 1 1/4"  |

护盖可选购尺寸见第93页 Optional cap size see P93

● 直式电缆护套插头: TQ Plug with PVC sleeve: TQ

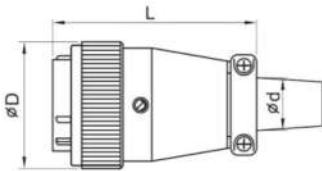

| 尺寸<br>Dimension(mm) | WS16 | WS20 | WS24 | WS28 | WS32 | WS40 | WS48 | WS55 |
|---------------------|------|------|------|------|------|------|------|------|
| ∅D                  | 21.5 | 26.4 | 29.8 | 34   | 39.3 | 49.3 | 57.2 | 64.5 |
| L                   | 44   | 49.5 | 53.5 | 56   | 70   | 75.5 | 85.5 | 97   |
| ∅d max              | 10   | 11.6 | 12.4 | 16   | 19.5 | 24   | 24   | 30   |

电缆护套尺寸见第93页 PVC sleeve dimension see P93

● 直式金属软管插头: TP Plug for metal-hose: TP

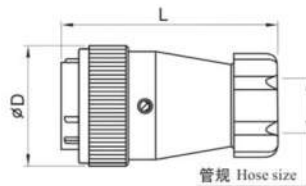

| 尺寸<br>Dimension(mm) | WS16 | WS20 | WS24 | WS28 | WS32 | WS40 | WS48                     | WS55   |
|---------------------|------|------|------|------|------|------|--------------------------|--------|
| ∅D1                 | 21.5 | 26.4 | 29.8 | 34   | 39.3 | 49.3 | 57.2                     | 64.5   |
| L                   | 48   | 57   | 58   | 61   | 74   | 82   | 90                       | 100    |
| 管规<br>Hose size     | 1/4" | 3/8" | 3/8" | 1/2" | 3/4" | 1"   | I: 1" (不标)<br>II: 1 1/4" | 1 1/4" |

● 直式塑料软管插头: TD Plug for plastic-hose: TD

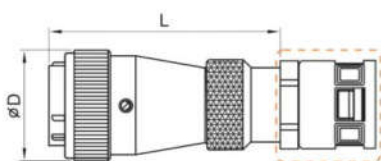

塑料软管接头可选购  
Optional plastic hose adapter

| 尺寸<br>Dimension(mm)  | WS16 | WS20 | WS24 | WS28 | WS32 | WS40 | WS48                     | WS55   |
|----------------------|------|------|------|------|------|------|--------------------------|--------|
| ∅D                   | 21.5 | 26   | 30   | 34   | 39.3 | 49.3 | 57.2                     | 64.5   |
| L                    | 56   | 64.5 | 68.5 | 75   | 88.5 | 95.5 | 105                      | 119    |
| 接头规格<br>Adapter size | PG7  | PG11 | PG11 | PG16 | PG21 | PG29 | I: PG29 (不标)<br>II: PG36 | PG36   |
| 管规<br>Hose size      | 1/4" | 3/8" | 3/8" | 1/2" | 3/4" | 1"   | I: 1" (不标)<br>II: 1 1/4" | 1 1/4" |



● 弯式金属软管插头: TR Plug with angled back shell for metal-hose: TR

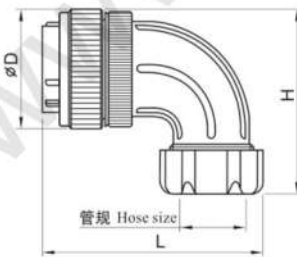

| 尺寸<br>Dimension(mm) |   | WS20 | WS24 | WS28 | WS32 | WS40 | WS48 | WS55   |
|---------------------|---|------|------|------|------|------|------|--------|
| øD                  | — | 25.6 | 30   | 33.8 | 38.2 | 49.3 | 55.8 | 63     |
| H                   | — | 48   | 51   | 52   | 58   | 70   | 82   | 90     |
| L                   | — | 60   | 60   | 63   | 81   | 88   | 96   | 107    |
| 管规<br>Hose size     | — | 3/8" | 3/8" | 1/2" | 3/4" | 1"   | 1"   | 1 1/4" |

● 弯式双压板电缆插头: TS Plug with angled back shell with cable clamping plates: TS

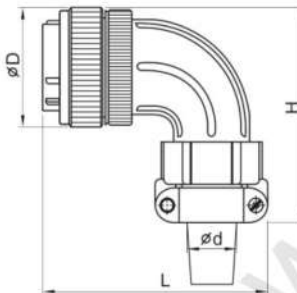

| 尺寸<br>Dimension(mm) |   | WS20 | WS24 | WS28 | WS32 | WS40 | WS48 | WS55 |
|---------------------|---|------|------|------|------|------|------|------|
| øD                  | — | 27.3 | 30   | 33.8 | 38.2 | 49.3 | 55.8 | 63   |
| H                   | — | 53   | 57   | 61   | 66   | 78   | 91   | 100  |
| L                   | — | 60   | 61   | 64   | 80   | 88   | 96   | 107  |
| ød max              | — | 11.6 | 12.4 | 15.7 | 19.5 | 24   | 24   | 30   |

电缆护套尺寸见第93页 PVC sleeve dimension see P93

● 弯式塑料软管插头: TC Plug with right angle back shell for plastic-hose: TC

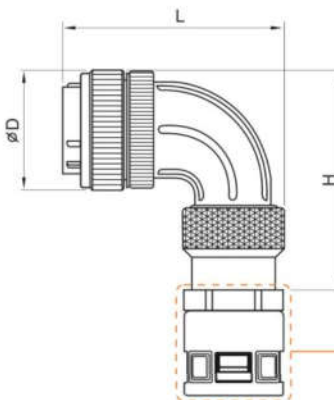

| 尺寸<br>Dimension(mm)  |   | WS20 | WS24 | WS28 | WS32 | WS40 | WS48 | WS55   |
|----------------------|---|------|------|------|------|------|------|--------|
| øD                   | — | 27.5 | 31   | 35   | 39   | 49.3 | 57   | 65     |
| H                    | — | 57   | 62   | 65   | 71.5 | 82   | 96   | 107    |
| L                    | — | 59.5 | 60   | 63   | 80.5 | 88   | 94   | 112    |
| 接头规格<br>Adapter size | — | PG11 | PG11 | PG16 | PG21 | PG29 | PG29 | PG36   |
| 管规<br>Hose size      | — | 3/8" | 3/8" | 1/2" | 3/4" | 1"   | 1"   | 1 1/4" |

Optional plastic hose adapter  
塑料软管接头可选购



## X-ON Electronics

Largest Supplier of Electrical and Electronic Components

*Click to view similar products for [Standard Circular Connector](#) category:*

*Click to view products by [Weipu](#) manufacturer:*

Other Similar products are found below :

[C015 10F006 001 1](#) [5M2530B10P](#) [600247N007](#) [600259N006](#) [600273N007](#) [600432N009](#) [6280-2PG-519](#) [6280-3PG-311](#) [6280-3SG-311](#)  
[6280-7SG-3DC](#) [6280-7SG-522](#) [6282-5PG-311](#) [6282-6PG-519](#) [6282-8SG-311](#) [6283-11](#) [6283-15](#) [6290](#) [6293](#) [6382-2PG-311](#) [6382-2PG-3DC](#)  
[6382-2SG-321](#) [6382-2SG-3DC](#) [6382-4SG-516](#) [67-03E20-37P](#) [681-PMG](#) [CXS3102A14S2P](#) [CXS3102A181S](#) [CXS3106A14S6S](#)  
[D38999/20FC8SA L/C](#) [MB12P-1](#) [MB12R-6](#) [7251-2PG-300](#) [7251-2SG-300](#) [7251-4PG-300](#) [7251-4SG-300](#) [7251-5PG-300](#) [7251-5SG-300](#)  
[7251-6SG-300](#) [7251-7PG-300](#) [7251-8PG-300](#) [7271-6SG-300](#) [7282-3PG-300-CH3](#) [73000005663](#) [75-190011-03P](#) [75-190216-08S](#) [75-190218-](#)  
[10P](#) [75-214636-52P](#) [75-474118-10P](#) [75-474211-03P](#) [75-474218-19S](#)