



1-Line Low Capacitance Bi-directional TVS Diode

SOD323

Schematic & Pin configuration

Simplified outline



Graphic symbol

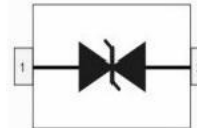

General description

GBLC12C a 12V bi-directional TVS diode,utilizing leading monolithic silicon technology to provide fast response time and low ESD clamping voltage,making his device an ideal solution for protecting voltage sensitive high-speed data lines.The GBLC12C has a low capacitance with a typical value at 1.0pF,and complies with the IEC61000-4-2(ESD) standard with $\pm 30KV$ air and $\pm 30KV$ contact discharge.It is assembled into a leadfree SOD-323 package.The small size,low capacitance and high ESD surge protection make GBLC12C an idea choice to protect cell phone,wireless systems,and communication equipment.

Features and benefits

- Ultra Low Capacitance 0.6 pF(Typ)
- 400W peak pulse power (8/20 μ s)
- Working Voltage 12V
- Low leakage current:nA Level
- Complies with following standards:
 - IEC 61000-4-2 (ESD)immunity test
Air discharge: $\pm 30KV$
Contact discharge: $\pm 30KV$
 - IEC61000-4-5(Lightning)15A(8/20 μ s)
 - IEC61000-4-4 (EFT)80A (5/50ns)
- RoHS compliant

Application information

- High-speed data lines
- Smart phones
- USB Ports
- Wireless Systems
- Ethernet 10/100/1000 Base T

Ordering information

| Par Number | Package | Packaging | Reel Size |
|------------|---------|-----------------|-----------|
| GBLC12C | SOD323 | 3000/Tape &Reel | 7 inch |

Maximum Ratings (T₄=25°C, unless otherwise specified)

| Parameter | Symbol | Value | Unit |
|---|------------------|-------------|------|
| Peak Pulse Power (t _p =8/20 μs) | P _{pk} | 400 | W |
| Peak Pulse Current (t _p =8/20 μs) | I _{pp} | 15 | A |
| ESD voltage IEC 61000-4-2 (air discharge) | VESD | 30 | KV |
| ESD voltage IEC 61000-4-2 (contact discharge) | VESD | 30 | KV |
| Storage Temperature Range | T _{stg} | -55 to +150 | °C |
| Operating Temperature Range | T _{op} | -40 to +85 | °C |

Electrical Characteristics (T_A=25 °C, unless otherwise specified)

| Parameter | Symbol | Min | Typ | Max | Unit | Condition |
|-----------------------------------|------------------|------|------|------|------|---|
| Reverse Working Voltage | VR _{WM} | | | 12 | V | |
| Breakdown Voltage | V _{BR} | 14.0 | 15.0 | 16.5 | V | I _r =1mA |
| Leakage Current I _{Leak} | I _{lg} | | | 0.2 | μA | VR _{WM} =12V |
| Clamping Voltage | V _c | | 16.5 | | V | I _{pp} =1A, T _p =8/20 μs |
| Clamping Voltage | V _c | | 26.0 | 30.0 | V | I _{pp} =15A, T _p =8/20 μs |
| Junction Capacitance | C _j | | 0.6 | 1.0 | pF | V _r =0V, f=1MHz |

Portion Electronics Parameter

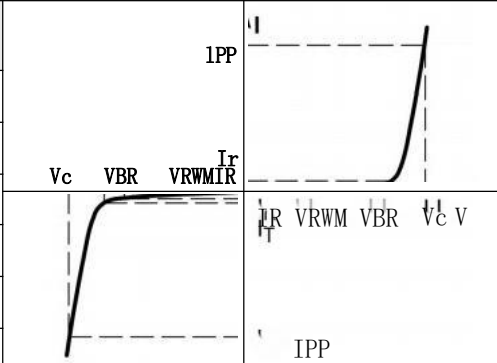
| Symbol | Parameter | Diagram | |
|------------------|---|--|---|
| I _{pp} | Reverse Peak Pulse Current |  | <p>IPP</p> <p>V_c V_{BR} VR_{WM} I_r</p> <p>I_r VR_{WM} V_{BR} V_c V</p> <p>IPP</p> |
| V _c | Clamping Voltage @IPP | | |
| VR _{WM} | Working Peak Reverse Voltage | | |
| I _r | Reverse Leakage Current @VR _{WM} | | |
| V _{BR} | Breakdown Voltage @I _T | | |
| I _r | V _{BR} Test Current | | |

Typical Performance Characteristics (TA=25° C unless otherwise Specified)

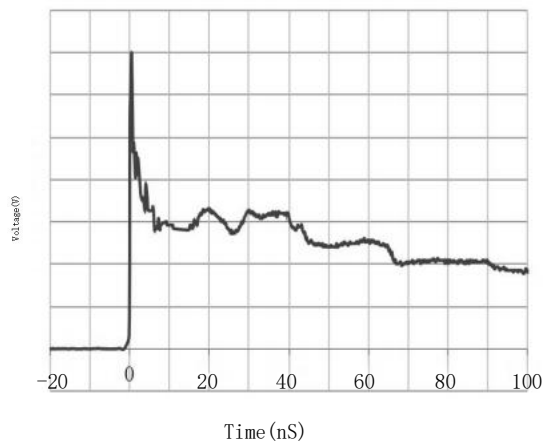

IEC61000-4-2 Pulse Waveform

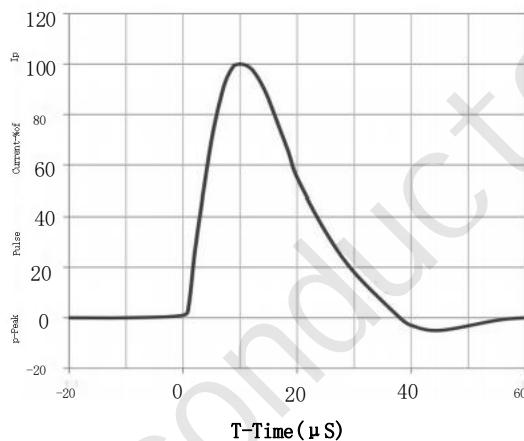

IEC61000-4-58X20 μs Pulse Waveform

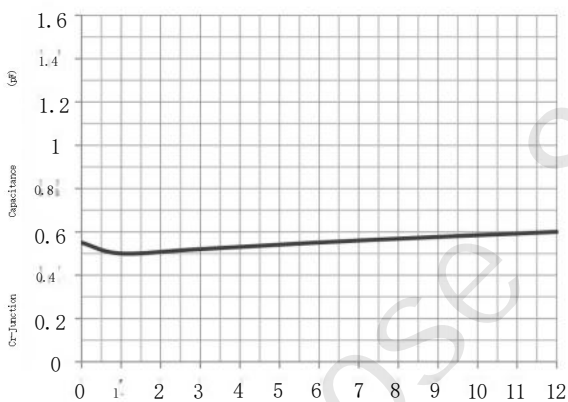

Junction Capacitance vs. Reverse Voltage

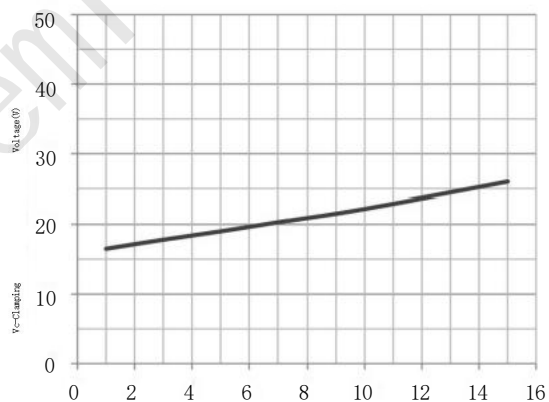

Clamping Voltage vs. Peak Pulse Current

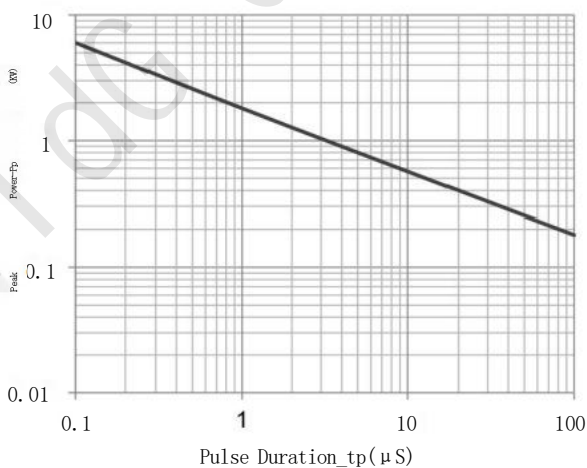

Peak Pulse Power vs. Pulse Time

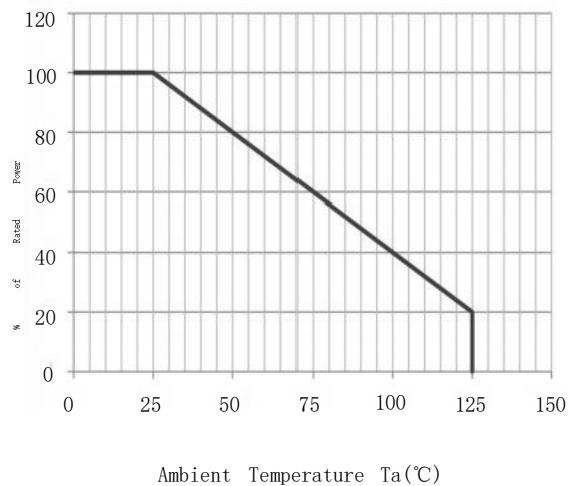

Power Derating Curve

Package Outline Dimensions (mm)

SOD323

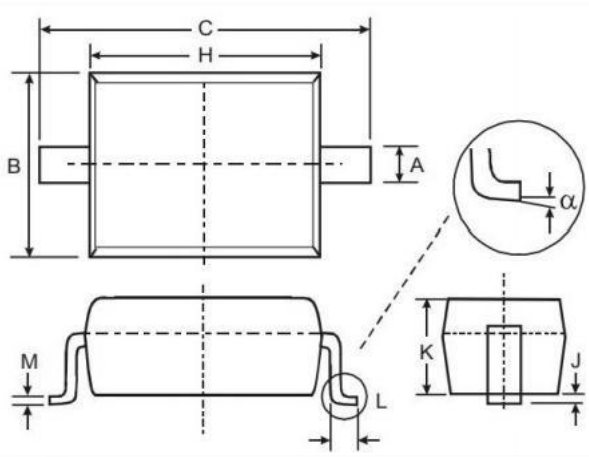

| SYMBOL | DIMENSIONS | |
|--------|------------|------|
| | MIN | MAX |
| A | 0.25 | 0.40 |
| B | 1.20 | 1.40 |
| C | 2.35 | 2.75 |
| H | 1.50 | 1.80 |
| J | 0.01 | 0.15 |
| K | 0.75 | 1.05 |
| L | 0.20 | 0.40 |
| M | 0.08 | 0.25 |
| a | 0° | 8° |

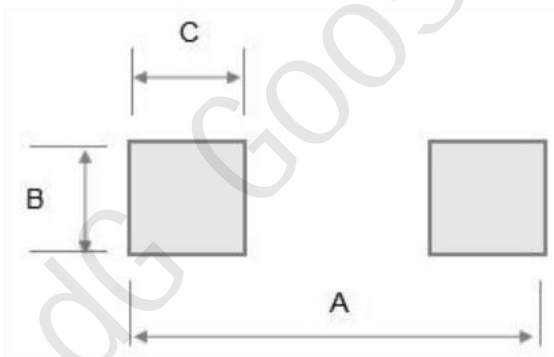
Soldering Footprint (mm)

| SYMBOL | DIMENSIONS |
|--------|------------|
| A | 3.20 |
| B | 0.80 |
| C | 0.80 |

X-ON Electronics

Largest Supplier of Electrical and Electronic Components

Click to view similar products for [ESD Suppressors / TVS Diodes](#) category:

Click to view products by [Wild Goose](#) manufacturer:

Other Similar products are found below :

[60KS200C](#) [D18V0L1B2LP-7B](#) [D5V0F4U5P5-7](#) [NTE4902](#) [P4KE27CA](#) [P6KE11CA](#) [P6KE8.2A](#) [SA60CA](#) [SA64CA](#) [SMBJ12CATR](#)
[SMBJ33CATR](#) [SMBJ6.5A](#) [SMBJ8.0A](#) [ESD101-B1-02ELS](#) [E6327](#) [ESD112-B1-02EL](#) [E6327](#) [ESD7451N2T5G](#) [19180-510](#) [CPDT-5V0USP-](#)
[HF](#) [3.0SMCJ33CA-F](#) [3.0SMCJ36A-F](#) [HSPC16701B02TP](#) [JANTX1N6126A](#) [D3V3Q1B2DLP3-7](#) [D55V0M1B2WS-7](#) [SCM1293A-04SO](#)
[ESD200-B1-CSP0201](#) [E6327](#) [SM12-7](#) [CEN955](#) [W/DATA](#) [VESD12A1A-HD1-GS08](#) [CPDQC5V0-HF](#) [D1213A-01LP4-7B](#) [ESD101-B1-02EL](#)
[E6327](#) [AOZ8808DI-03](#) [5KP15A](#) [5KP48A](#) [5KP90A](#) [ESD3V3D7-TP](#) [15KPA36A-LF](#) [P4KE56CA](#) [P4KE68A](#) [P4KE91CATR](#) [P6KE120A](#)
[P6KE13CA](#) [P6KE43CA](#) [P6KE6.8CA](#) [P6KE8.2](#) [P6SMBJ20CA](#) [JANTX1N6072A](#) [SR2835ESKG](#) [SA90CA](#)