

REV.	SPECIFICATION	ECN NO.	APPD.
R5		ECN210406	

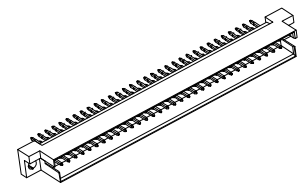
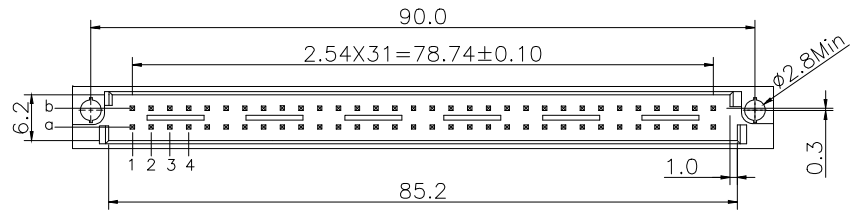

Material and Plating:

Housing: PBT, UL94V-0, Beige
 Contacts: Brass
 Gold Plated on Contact Area and 80u" Min Tin or Gold
 Flash Plated on Solder Tail over 50u" Min Nickel.

Electrical Characteristics:

Current Rating: 2 AMP.
 Dielectric Withstanding Voltage: AC 1000V For 1 minute.
 Insulator Resistance: 1000MΩ min. at DC 500V.
 Contact Resistance: 20mΩ max. at DC 100mA.
 Operating Temperature: -55°C~+125°C.

***RoHS Compliant**

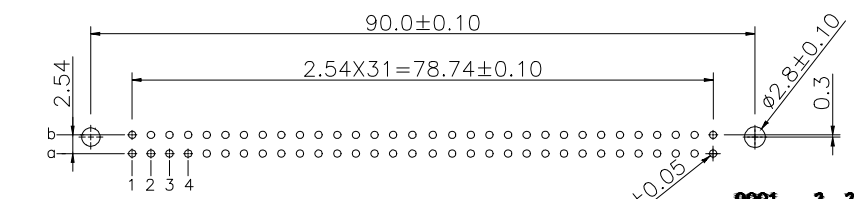
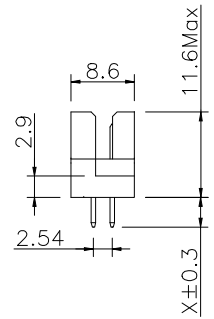
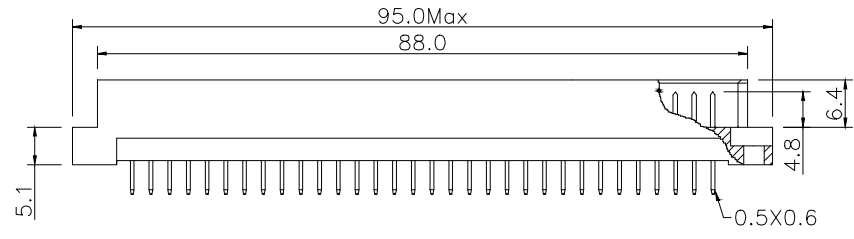

P.C. Board Layout
 (Tolerance: ±0.05)

9001- 3 3 xx x C xx A

Series: 3: 2.54mm, 4: 5.08mm, 3: Male

Position: 1: Dip Length, 2: Dip Length, W1: Dip Length, W2: Dip Length

A: Tray Package
 00: G/F, 10: 10u", 15: 15u", 30: 30u"

C: Dip Tin
 Contact Gold, G: Gold Plated

Pitch	Position	Rows with Contacts	Contact Arrange	P/N	X length			
					1	2	W1	W2
2.54mm	64	a b		9001-3364xCxxA	4.0	2.5	13	17
	32	a -		9001-3332xCxxA				
5.08mm	32	a b		9001-4332xCxxA				
	16	a -		9001-4316xCxxA				

Tolerances	Dwg No.	9001D33001	
x = ±0.5	Projection		
.x = ±0.25	Unit	mm	Scale 1:1
.xx = ±0.15	Drawn By	ZY 04/14'21	

Title: 9001 Series
 DIN41612 Q Type Male

深圳市格林柏电子技术开发有限公司			
P/N: 9001-3(4)3xxxCxxA			
SHEET	1/1	Ver.No.	R5

X-ON Electronics

Largest Supplier of Electrical and Electronic Components

Click to view similar products for [Board to Board & Mezzanine Connectors](#) category:

Click to view products by [WingTAT](#) manufacturer:

Other Similar products are found below :

[589158040000018](#) [MDF7C-18P-2.54DSA\(55\)](#) [FCN-268F036-G/BD](#) [FCN-268M012-G/0D](#) [FCN-268M024-G/1D](#) [MIS-048-01-F-D-DP-K](#)
[832-10-034-10-001000](#) [FX4C-80S-1.27DSA](#) [93696-330](#) [224393](#) [FCN-235D050-G/C](#) [210-93-314-41-105000](#) [MDF7-40DP-2.54DSA\(55\)](#)
[55323-1519](#) [069159702701000](#) [101A10019X](#) [105061100000861+](#) [75140-7012](#) [87471-650](#) [1744382-4](#) [063209](#) [10124054-515LF](#) [68685-603](#)
[8-1616154-3](#) [541371078](#) [IL-WX-10PB-HF-B-E1000E](#) [FX23-40P-0.5SV15B](#) [FCN-214J100-G/0](#) [354184](#) [P50-028-DDS-TG](#) [53309-2471](#)
[54546-2071](#) [1586617-1](#) [504248-1210](#) [504248-2010](#) [1-1437355-2](#) [9159005551906](#) [NDS100-004-BF](#) [93696-730LF](#) [91922-31141LF](#) [505274-](#)
[3440](#) [501493-2410](#) [504208-3410](#) [505006-0811](#) [505274-2040](#) [202436-1600](#) [202477-0414](#) [71660-7580](#) [73420-5192](#) [360-10-107-00-001000](#)