

REV.	SPECIFICATION	ECN NO.	APPD.
R5		ECN220120	

**Material and Plating:**  
Housing: PBT, UL94V-0, Beige.  
Contacts: Copper Alloy.  
Lock: Phosphor Bronze.  
Gold Plated on contact Area and 80u"Min Tin or Gold Flash plated on solder tail over 50u"Min Nickel.

**Electrical Characteristics:**  
Current Rating: 2 AMP.  
Dielectric Withstanding Voltage: AC 1000V For 1 minute.  
Insulator Resistance: 1000MQ min. at DC 500V.  
Contact Resistance: 20mΩ max. at DC 100mA.  
Operating Temperature: -55°C ~+125°C .  
**\*RoHS Compliant**

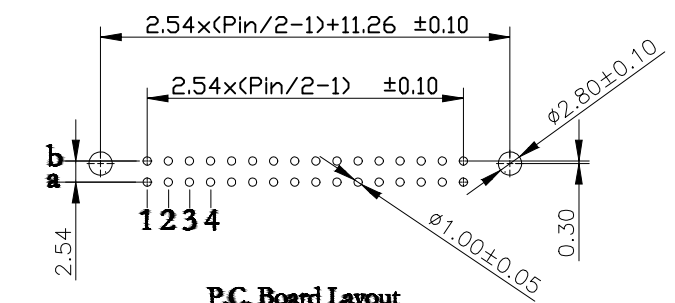
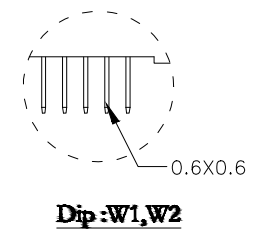
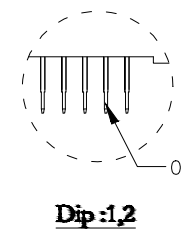
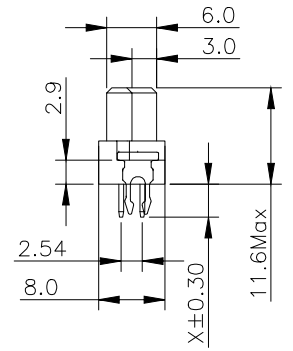
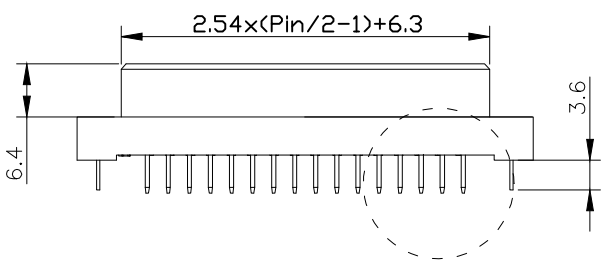
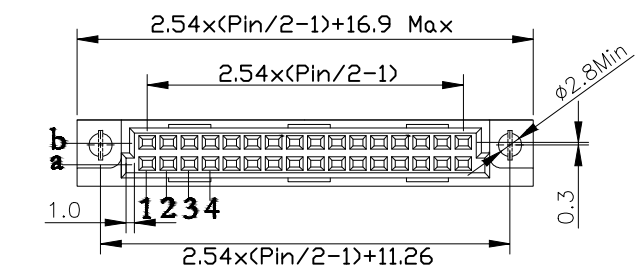
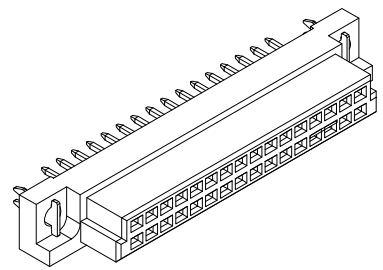

**P.C. Board Layout**  
(Tolerance: ±0.05)

**9001- 3 6 xx x C xx xx A**

Series  
3: 2.54mm  
4: 5.08mm  
6: Female

Position  
1: Dip Length  
2: Dip Length  
W1: Dip Length  
W2: Dip Length

A: Tray Package  
Blank: W/O Lock  
L1: With Lock  
00: G/F  
10: 10u"  
15: 15u"  
30: 30u"

C: Dip Tin Contact Gold Plated  
G: Gold Plated

Pitch	Position	Rows with Contacts	Contact Arrange	x length											
				1 4.0	2 2.5	W1 13	W2 17								
2.54mm	8 10 12 16	a b	b 1234	9001-3608xCxxA 9001-3610xCxxA 9001-3612xCxxA 9001-3616xCxxA											
				2.54mm	32 44 48 50	a b	b 1234	9001-3632xCxxA 9001-3644xCxxA 9001-3648xCxxA 9001-3650xCxxA							
								2.54mm	4 5 6 8	a -	b 1234	9001-3604xCxxA 9001-3605xCxxA 9001-3606xCxxA 9001-3608xCxxA			
												2.54mm	16 22 24 25	a -	b 1234

Tolerances	Dwg. No.	9001D36001	Title:		 深圳市格林柏电子技术开发有限公司 P/N: 9001-36xxx CxxA SHEET 1/1 Ver.No. R5			
x = ±0.5	Projection		9001 Series					
.x = ±0.25	Unit	mm	Scale	1:1				
.xx = ±0.15	Drawn By	ZY 1/12'22	DIN41612 Half B Type Female					

## X-ON Electronics

Largest Supplier of Electrical and Electronic Components

*Click to view similar products for [Board to Board & Mezzanine Connectors](#) category:*

*Click to view products by [WingTAT](#) manufacturer:*

Other Similar products are found below :

[589158040000018](#) [MDF7C-18P-2.54DSA\(55\)](#) [FCN-268F036-G/BD](#) [FCN-268M012-G/0D](#) [FCN-268M024-G/1D](#) [MIS-048-01-F-D-DP-K](#)  
[832-10-034-10-001000](#) [FX4C-80S-1.27DSA](#) [93696-330](#) [224393](#) [FCN-235D050-G/C](#) [210-93-314-41-105000](#) [MDF7-40DP-2.54DSA\(55\)](#)  
[55323-1519](#) [069159702701000](#) [101A10019X](#) [105061100000861+](#) [75140-7012](#) [87471-650](#) [1744382-4](#) [063209](#) [10124054-515LF](#) [68685-603](#)  
[8-1616154-3](#) [541371078](#) [IL-WX-10PB-HF-B-E1000E](#) [FX23-40P-0.5SV15B](#) [FCN-214J100-G/0](#) [354184](#) [P50-028-DDS-TG](#) [53309-2471](#)  
[54546-2071](#) [1586617-1](#) [504248-1210](#) [504248-2010](#) [1-1437355-2](#) [9159005551906](#) [NDS100-004-BF](#) [93696-730LF](#) [91922-31141LF](#) [505274-](#)  
[3440](#) [501493-2410](#) [504208-3410](#) [505006-0811](#) [505274-2040](#) [202436-1600](#) [202477-0414](#) [71660-7580](#) [73420-5192](#) [360-10-107-00-001000](#)