

General Description

WSR22N50F the silicon N-channel Enhanced VDMOSFETs, is obtained by the self-aligned planar Technology which reduce the conduction loss, improve switching performance and enhance the avalanche energy. The transistor can be used in various power switching circuit for system miniaturization and higher efficiency. The package form is TO-220F, which accords with the RoHS standard.

Features

- Low gate charge
- Low Crss
- Fast switching
- 100% avalanche tested
- Improved dv/dt capability
- RoHS product

Product Summary

BV_{DSS}	R_{DSON}	I_D
500V	250mΩ	20A

Applications

- Switching application.
- Power Management for Inverter Systems.

TO-220F Pin Configuration

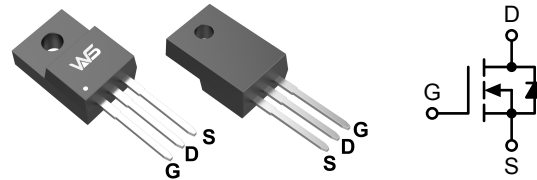

5 Vgc`i hY`AU]a i a `FUhb[gÁV, MG »Ô,ÁV |^••ÁU@!, ã^Á [c`ãD

Symbol	Parameter	Rating	Units
V_{DS}	Drain-Source Voltage	500	V
V_{GS}	Gate-Source Voltage	± 30	V
I_D	Continuous Drain Current	20	A
	Continuous Drain Current TC = 100 °C	13	A
I_{DM}	Pulsed Drain Current ^a	80	A
E_{AS}	Single Pulse Avalanche Energy ^b	1500	mJ
E_{AR}	Avalanche Energy ,Repetitive	90	A
P_D	Power Dissipation	113	W
	Derating Factor above 25°C	1.84	W/°C
T_{STG}	Storage Temperature Range	-55 to 150	°C
T_J	Operating Junction Temperature Range	150	°C

Thermal Data

Symbol	Parameter	Typ.	Max.	Unit
$R_{\theta JA}$	Junction-to-Ambient	---	62.5	°C/W
$R_{\theta JC}$	Junction-to-Case	---	1.1	°C/W

Electrical Characteristics

Symbol	Parameter	Conditions	Min.	Typ.	Max.	Unit
BV_{DSS}	Drain-Source Breakdown Voltage	$V_{GS}=0V, I_D=250\mu A$	—	—	—	V
$\Delta BV_{DSS}/\Delta T_J$	BV_{DSS} Temperature Coefficient	$I_D=250\mu A, \text{Reference } 25^\circ C$	—	0.55	—	V/°C
$R_{DS(ON)}$	Drain-to-Source On-Resistance	$V_{GS}=10V, I_D=10A$	—	250	300	mΩ
$V_{GS(th)}$	Gate Threshold Voltage	$V_{GS}=V_{DS}, I_D=250\mu A$	2.0	—	4.0	V
$\Delta V_{GS(th)}$	$V_{GS(th)}$ Temperature Coefficient		—	-5.5	—	mV/°C
I_{DSS}	Drain-Source Leakage Current	$V_{DS}=500V, V_{GS}=0V, T_J=25^\circ C$	—	—	1	μA
		$V_{DS}=500V, V_{GS}=0V, T_J=55^\circ C$	—	—	10	
I_{GSS}	Gate-Source Leakage Current	$V_{GS}=\pm 30V, V_{DS}=0V$	—	—	±100	nA
Q_g	Total Gate Charge (10V)	$V_{DS}=250V, V_{GS}=10V, I_D=10A$	—	63	—	nC
Q_{gs}	Gate-Source Charge		—	15	—	
Q_{gd}	Gate-Drain Charge		—	22	—	
$T_{d(on)}$	Turn-On Delay Time	$V_{DD}=250V, V_{GS}=10V, R_G=25\Omega, I_D=10A$	—	30	—	ns
T_r	Rise Time		—	71	—	
$T_{d(off)}$	Turn-Off Delay Time		—	170	—	
T_f	Fall Time		—	80	—	
C_{iss}	Input Capacitance	$V_{DS}=25V, V_{GS}=0V, f=1MHz$	—	2800	—	pF
C_{oss}	Output Capacitance		—	285	—	
C_{rss}	Reverse Transfer Capacitance		—	25	—	

Diode Characteristics

Symbol	Parameter	Conditions	Min.	Typ.	Max.	Unit
I_S^c	Continuous Source Current (Body Diode)	$V_G=V_D=0V, \text{Force Current}$	—	—	20	A
I_{SM}	Maximum Pulsed Current (Body Diode)		—	—	80	A
V_{SD}	Diode Forward Voltage ²	$V_{GS}=0V, I_S=20A, T_J=25^\circ C$	—	—	1.5	V
t_{rr}	Reverse Recovery Time	$I_F=20A, di/dt=100A/\mu s, T_J=25^\circ C$	—	390	—	ns
Q_{rr}	Reverse Recovery Charge		—	3350	—	nC

a: Repetitive rating; pulse width limited by maximum junction temperature

b: L=10.0mH, $I_D=17.3A$, Start $T_J=25^\circ C$

c: $I_{SD}=20A, di/dt \leq 300A/\mu s, V_{DD} \leq BV_{DS}$, Start $T_J=25^\circ C$

Typical Characteristics

Power Dissipation

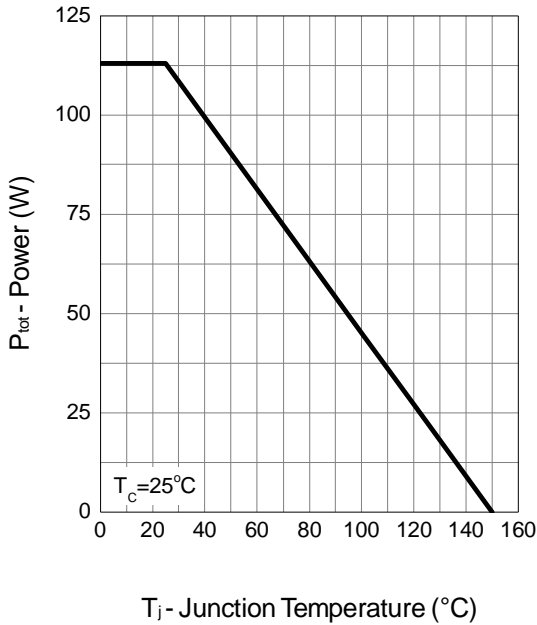

Thermal Transient Impedance

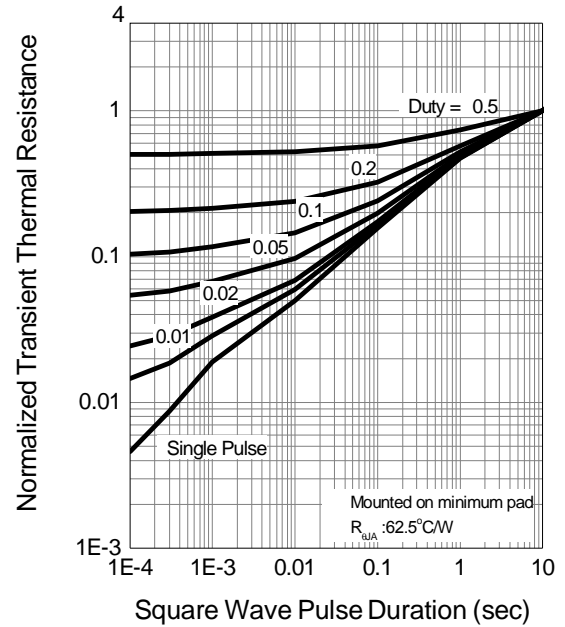

Drain Current

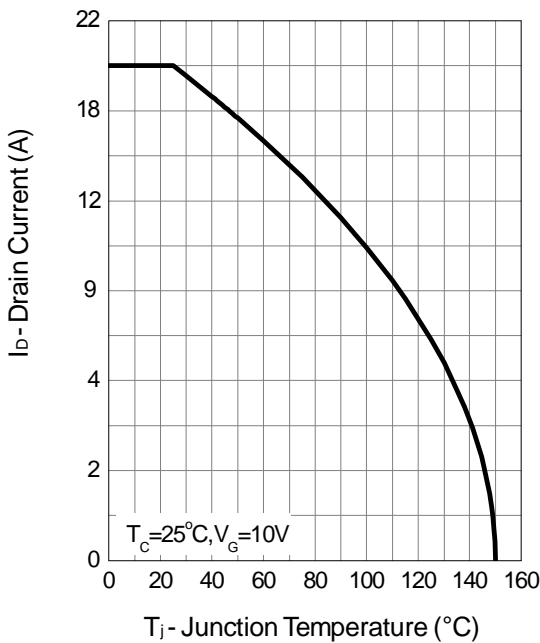

Output Characteristics

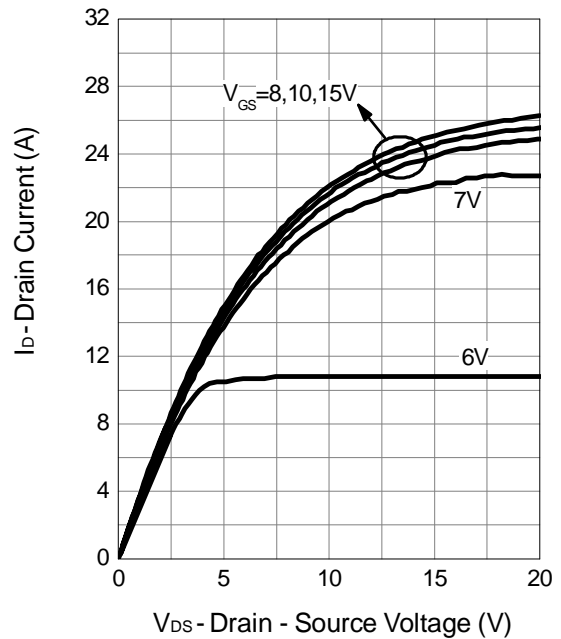

Typical Characteristics (Cont.)

Drain-Source On Resistance

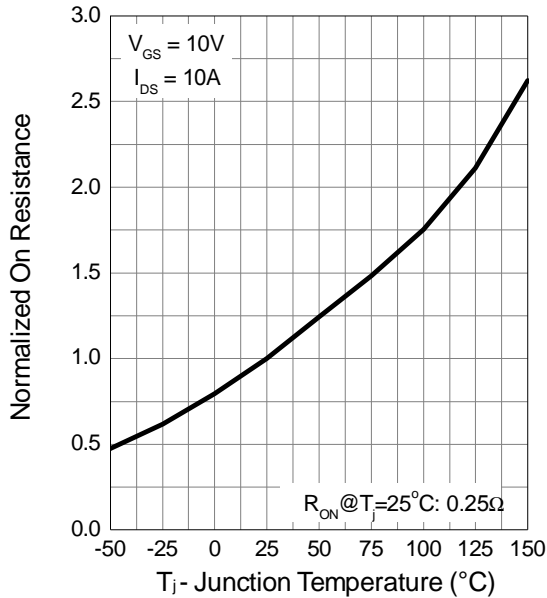

Source-Drain Diode Forward

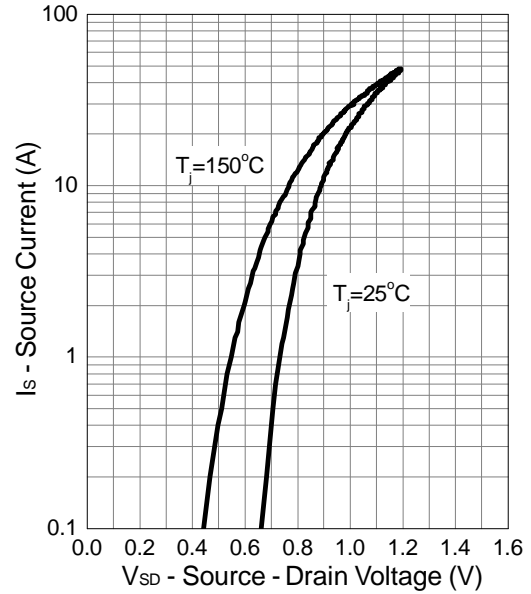

Capacitance

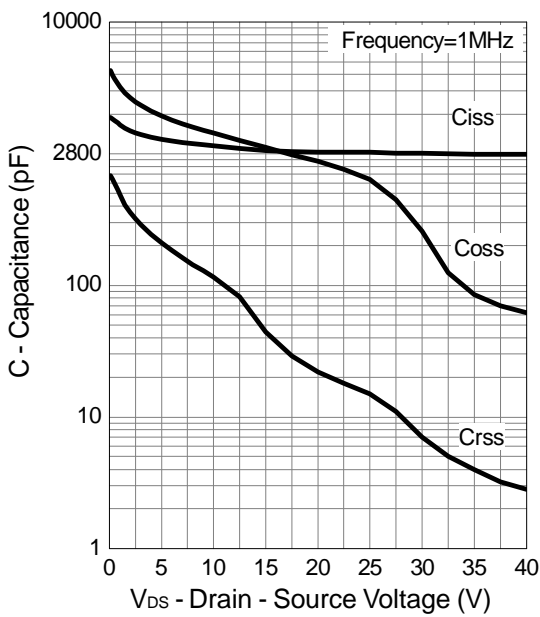

Gate Charge

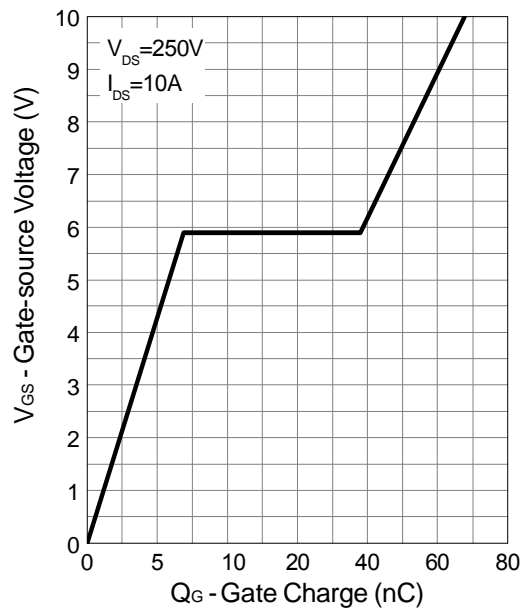

Typical Characteristics (Cont.)

Drain-Source On Resistance

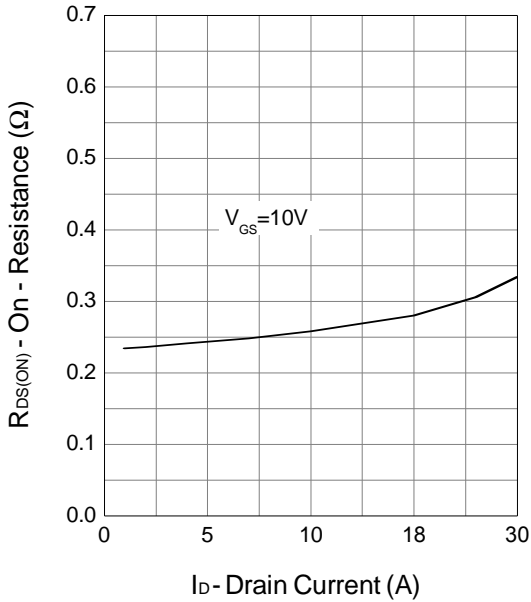

BVDSS vs Junction Temperature

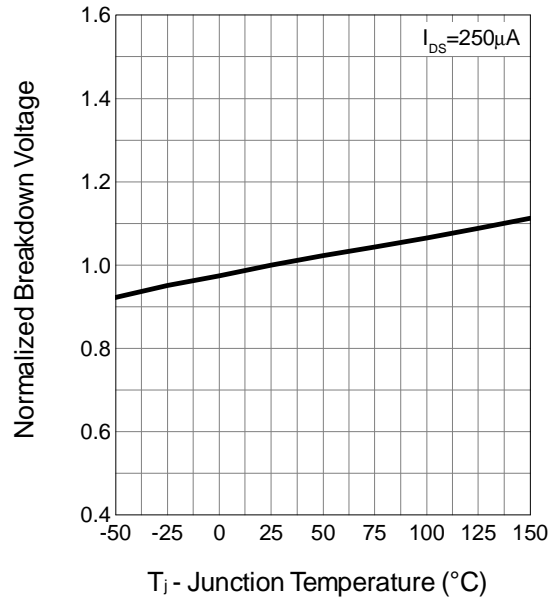

Transfer Characteristics

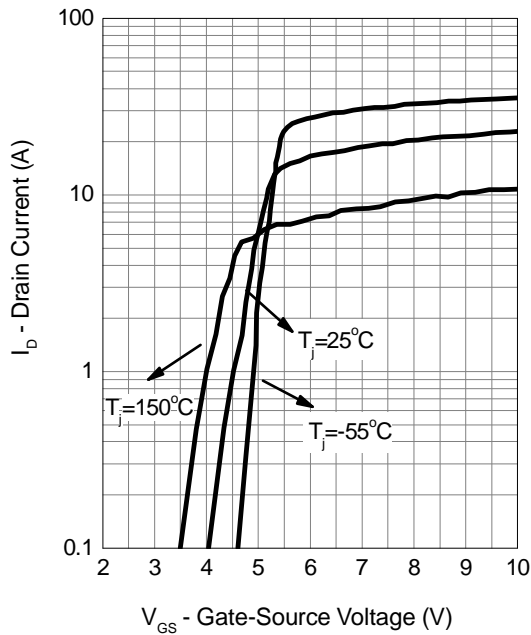

Gate Threshold Voltage

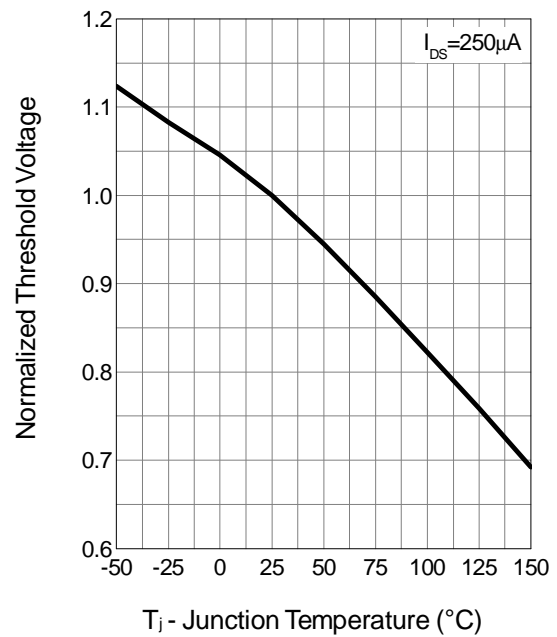

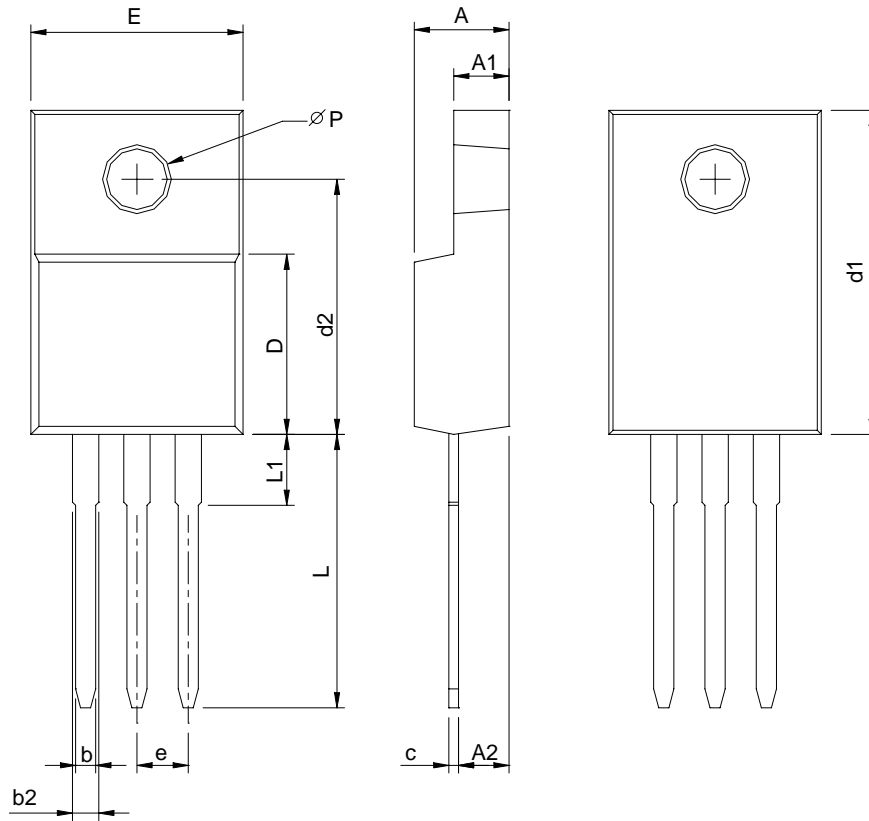
Packaging information

SYMBOL	TO-220F			
	MILLIMETERS		INCHES	
	MIN.	MAX.	MIN.	MAX.
A	4.20	4.80	0.165	0.189
A1	2.34	3.20	0.092	0.126
A2	2.10	2.90	0.083	0.114
b	0.50	0.90	0.020	0.035
b2	0.91	1.90	0.035	0.075
c	0.30	0.80	0.012	0.031
D	8.10	9.40	0.319	0.370
d1	14.50	16.50	0.571	0.650
d2	12.10	12.90	0.476	0.508
E	9.70	10.70	0.382	0.421
e	2.54 BSC		0.100 BSC	
L	13.00	14.50	0.512	0.570
L1	1.60	4.00	0.063	0.157
P	3.00	3.60	0.118	0.142

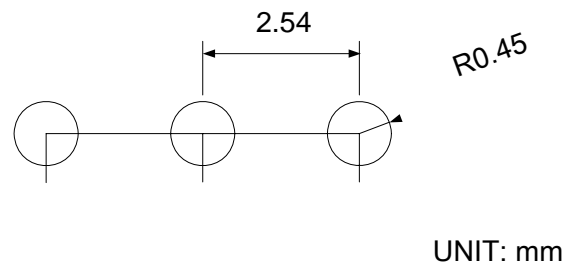
RECOMMENDED LAND PATTERN



Attention

- 1, Any and all Winsok power products described or contained herein do not have specifications that can handle applications that require extremely high levels of reliability, such as life-support systems, aircraft's control systems, or other applications whose failure can be reasonably expected to result in serious physical and/or material damage. Consult with your Winsok power representative nearest you before using any Winsok power products described or contained herein in such applications.
- 2, Winsok power assumes no responsibility for equipment failures that result from using products at values that exceed, even momentarily, rated values (such as maximum ratings, operating condition ranges, or other parameters) listed in products specifications of any and all Winsok power products described or contained herein.
- 3, Specifications of any and all Winsok power products described or contained herein stipulate the performance, characteristics, and functions of the described products in the independent state, and are not guarantees of the performance, characteristics, and functions of the described products as mounted in the customer's products or equipment. To verify symptoms and states that cannot be evaluated in an independent device, the customer should always evaluate and test devices mounted in the customer's products or equipment.
- 4, Winsok power Semiconductor CO., LTD. strives to supply high-quality high-reliability products. However, any and all semiconductor products fail with some probability. It is possible that these probabilistic failures could give rise to accidents or events that could endanger human lives that could give rise to smoke or fire, or that could cause damage to other property. When designing equipment, adopt safety measures so that these kinds of accidents or events cannot occur. Such measures include but are not limited to protective circuits and error prevention circuits for safe design, redundant design, and structural design.
- 5, In the event that any or all Winsok power products (including technical data, services) described or contained herein are controlled under any of applicable local export control laws and regulations, such products must not be exported without obtaining the export license from the authorities concerned in accordance with the above law.
- 6, No part of this publication may be reproduced or transmitted in any form or by any means, electronic or mechanical, including photocopying and recording, or any information storage or retrieval system, or otherwise, without the prior written permission of Winsok power Semiconductor CO., LTD.
- 7, Information (including circuit diagrams and circuit parameters) herein is for example only; it is not guaranteed for volume production. Winsok power believes information herein is accurate and reliable, but no guarantees are made or implied regarding its use or any infringements of intellectual property rights or other rights of third parties.
- 8, Any and all information described or contained herein are subject to change without notice due to product/technology improvement, etc. When designing equipment, refer to the "Delivery Specification" for the Winsok power product that you intend to use.
- 9, this catalog provides information as of Sep. 2014. Specifications and information herein are subject to change without notice.

X-ON Electronics

Largest Supplier of Electrical and Electronic Components

Click to view similar products for [MOSFET](#) category:

Click to view products by [Winsok](#) manufacturer:

Other Similar products are found below :

[IRFD120](#) [JANTX2N5237](#) [BUK455-60A/B](#) [MIC4420CM-TR](#) [VN1206L](#) [NDP4060](#) [SI4482DY](#) [IPS70R2K0CEAKMA1](#) [SQD23N06-31L-GE3](#)
[TK16J60W,S1VQ\(O](#) [2SK2614\(TE16L1,Q\)](#) [DMN1017UCP3-7](#) [DMN1053UCP4-7](#) [SQJ469EP-T1-GE3](#) [NTE2384](#) [DMC2700UDMQ-7](#)
[DMN2080UCB4-7](#) [DMN61D9UWQ-13](#) [US6M2GTR](#) [DMN31D5UDJ-7](#) [DMP22D4UFO-7B](#) [DMN1006UCA6-7](#) [DMN16M9UCA6-7](#)
[STF5N65M6](#) [IRF40H233XTMA1](#) [STU5N65M6](#) [DMN6022SSD-13](#) [DMN13M9UCA6-7](#) [DMTH10H4M6SPS-13](#) [DMN2990UFB-7B](#)
[IPB80P04P405ATMA2](#) [2N7002W-G](#) [MCAC30N06Y-TP](#) [MCQ7328-TP](#) [BXP7N65D](#) [BXP4N65F](#) [AOL1454G](#) [WMJ80N60C4](#) [BXP2N20L](#)
[BXP2N65D](#) [BXT1150N10J](#) [BXT1700P06M](#) [TSM60NB380CP ROG](#) [RQ7L055BGTCR](#) [DMNH15H110SK3-13](#) [SLF10N65ABV2](#)
[BSO203SP](#) [BSO211P](#) [IPA60R230P6](#) [IPA60R460CE](#)