



# **DATASHEET**

## **-Preliminary-**

# **Surface Acoustic Wave Filter**

- **Application : BAND41(120MHz) Tx Filter**
- **Model : SFDG26AA402**
- **Center Frequency : 2595 [MHz]**



**WISOL CO., LTD.**

373-7, GAJANG-DONG, OSAN-SI  
GYUNGGI-DO, KOREA, 447-210

<http://www.wisol.co.kr>

E-mail: [sales@wisol.co.kr](mailto:sales@wisol.co.kr)

### 1. OUTLINE DRAWING & RECOMMENDED PCB

[Unit: mm]

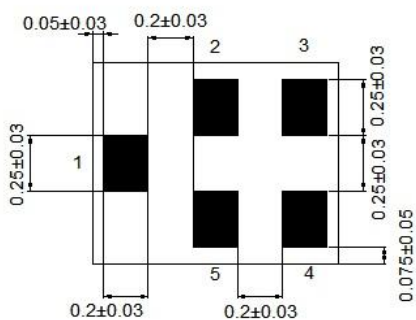
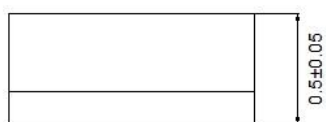
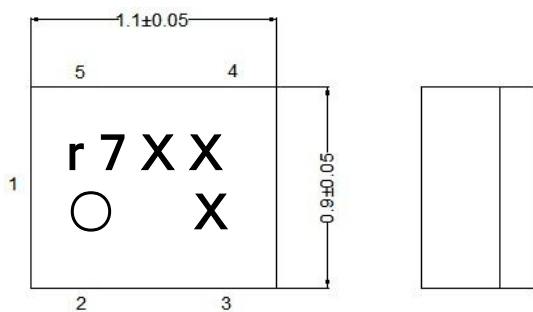

No.	Function
2, 3, 5	Ground
1	Unbalanced Input
4	Unbalanced Output

### 2. TEST FIXTURE

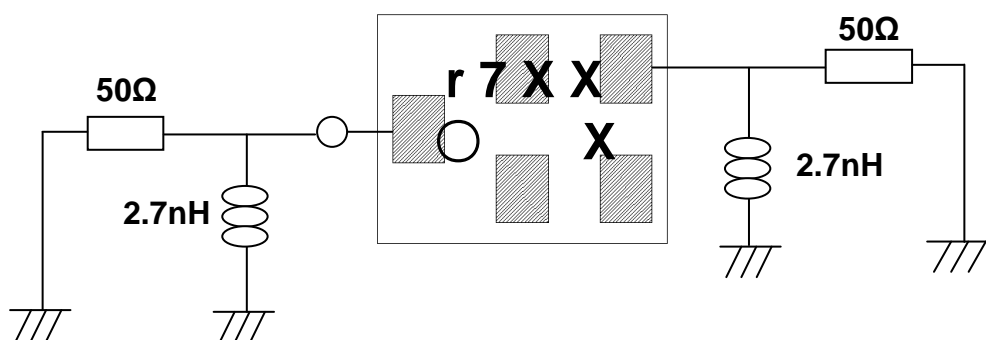

< Top View >

### 3. PERFORMANCE

#### 3-1. MAXIMUM RATINGS

CHARACTERISTICS	RATINGS	UNITS
DC Permissive Voltage	5	V
Maximum Input Power	29	dBm
Operating Temperature Range	- 20 ~ +85	°C
Storage Temperature Range	- 40 ~ +85	°C

#### 3-2. ELECTRICAL CHARACTERISTICS

##### 3-2-1. TABLE

Ta = - 20 ~ + 85°C

\*1.PCB loss is de-embedded

Item	FREQUENCY RANGE [MHz]	UNIT	SPECIFICATION		
			Min.	Typ.(25°C)	Max.
Insertion Loss	2535 ~ 2655	dB		1.5	2.5
Inband Ripple	2535 ~ 2655	dB		0.6	1.6
Input VSWR	2535 ~ 2655	-		1.6	2.2
Output VSWR	2535 ~ 2655	-		1.7	2.2
Absolute Attenuation	10 ~ 2170	dB	20	23	
	2170 ~ 2400	dB	20	23	
	2401 ~ 2438	dB	30	33	
	2421 ~ 2483	dB	35	39	
	2750 ~ 4900	dB	23	26	
	4900 ~ 6000	dB	33	35	
Termination Impedance			Input: Unbalanced 50Ω // 2.7[nH] Output: Unbalanced 50Ω // 2.7[nH]		

3-2-2. GRAPH

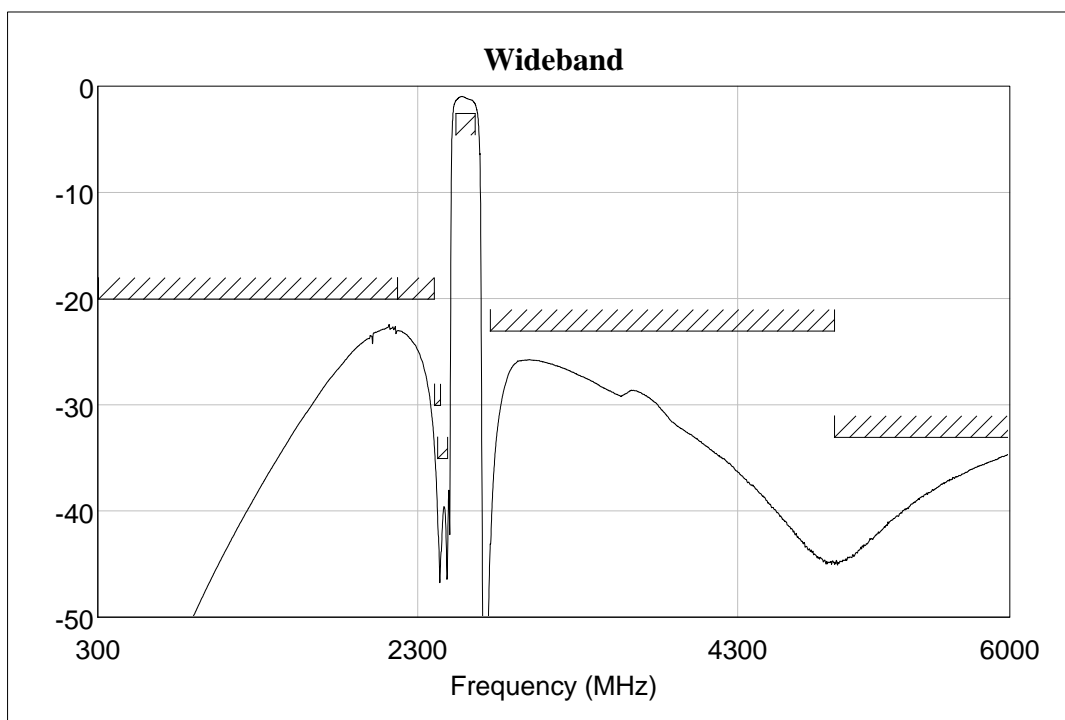
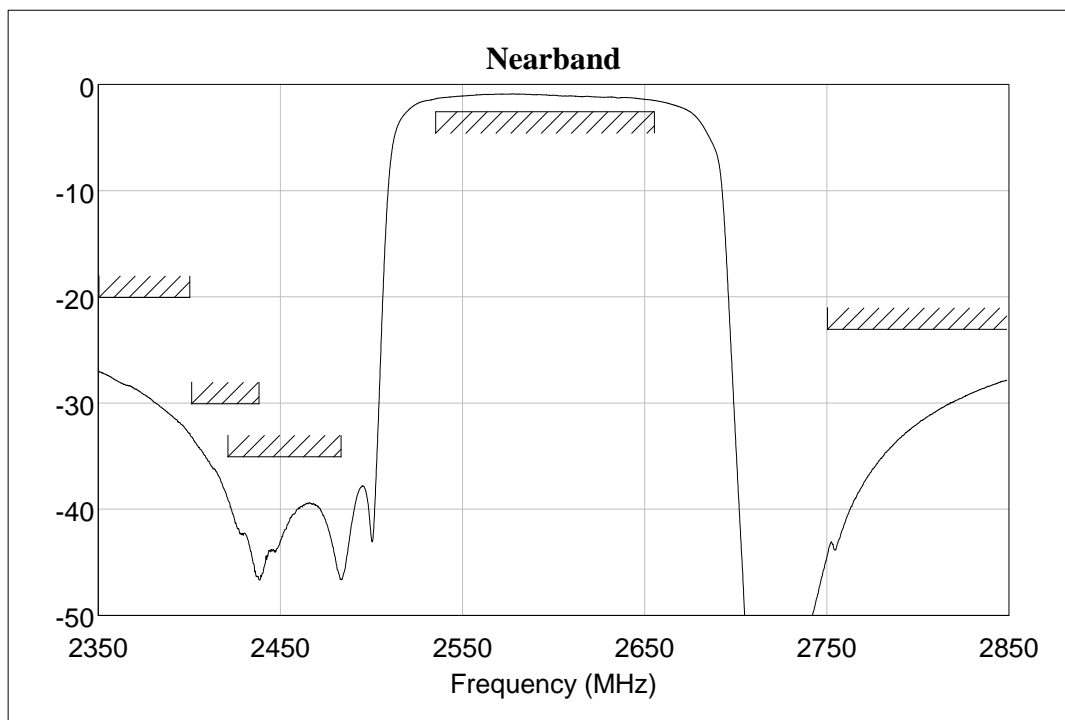

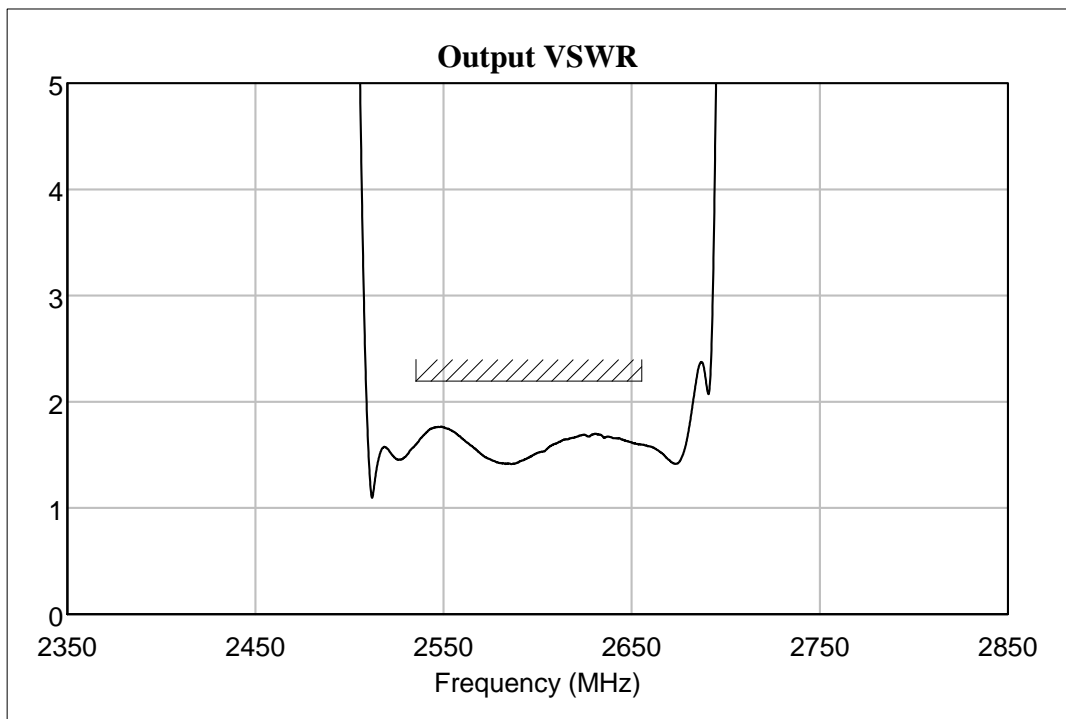
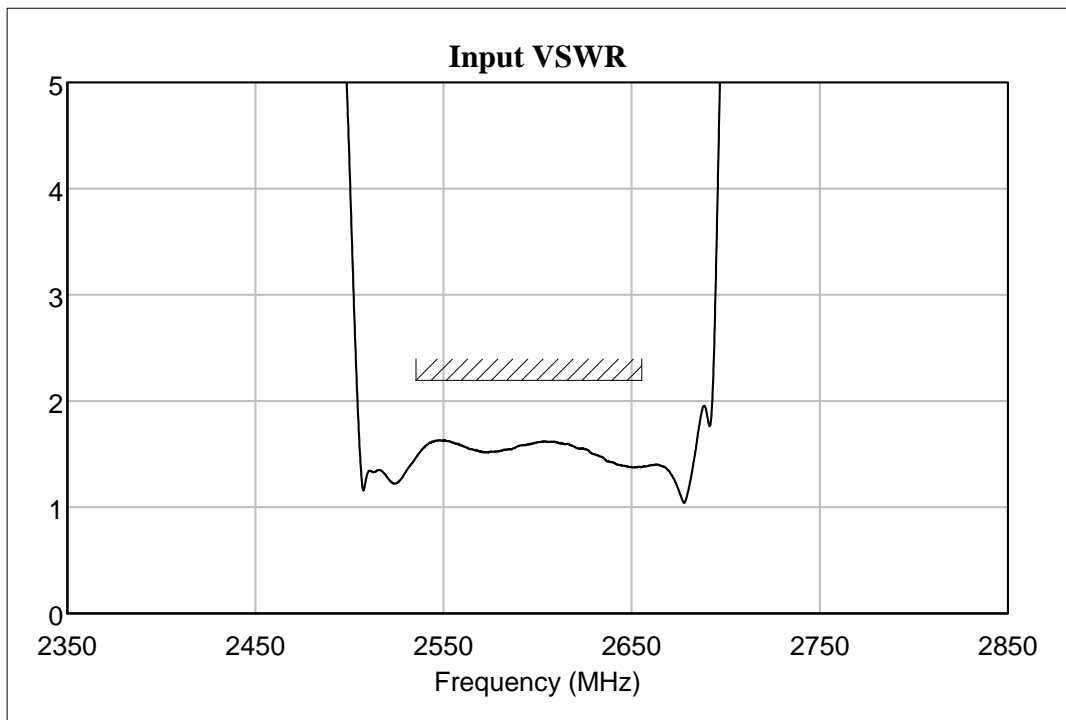

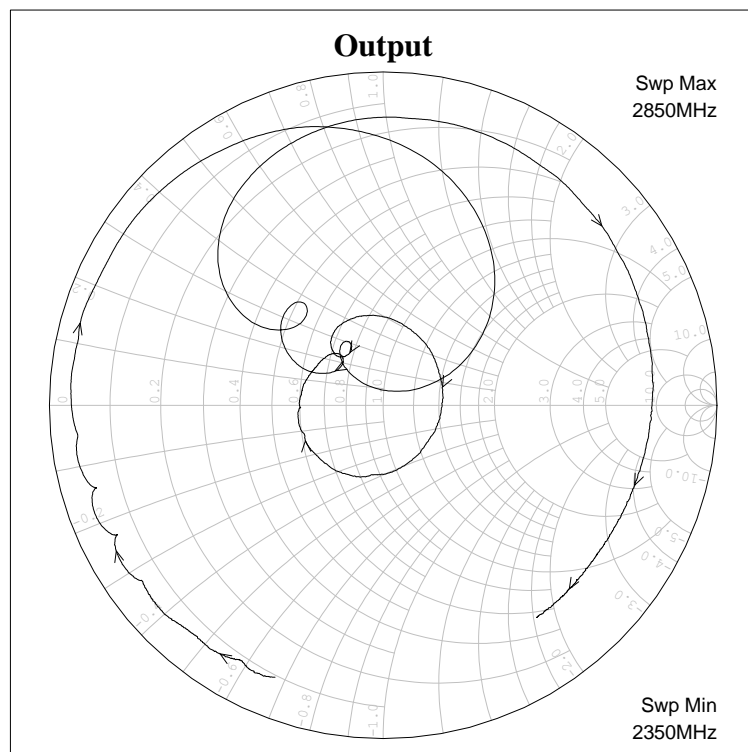
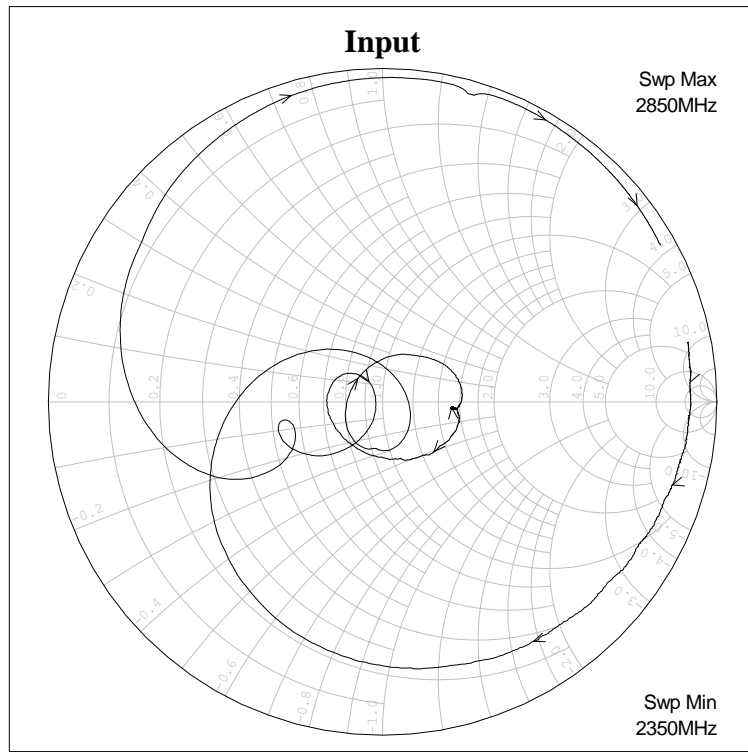

## 4. PACKING

### 4-1. DIMENSIONS

- Carrier Tape [Unit: mm]

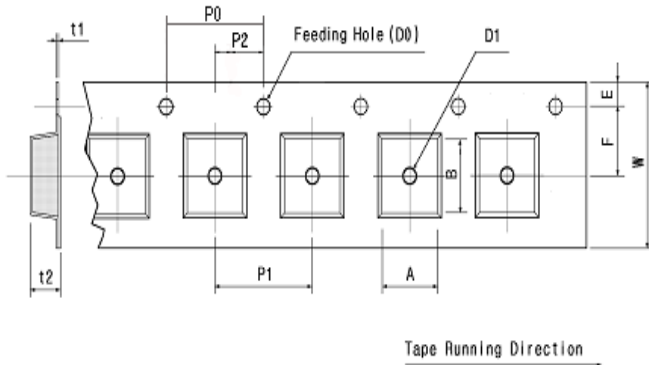

A	B	D0	D1
1.08 + 0.05 - 0.05	1.23 + 0.05 - 0.05	Ø1.50 + 0.10 - 0.00	Ø0.5 MIN
E	F	P0	P1
1.75 + 0.10 - 0.10	3.50 + 0.05 - 0.05	4.00 + 0.10 - 0.10	4.00 + 0.10 - 0.10
P2	t1	t2	W
2.00 + 0.05 - 0.05	0.23 + 0.05 - 0.05	0.70 + 0.05 - 0.05	8.00 + 0.10 - 0.10

- Reel [Unit: mm]

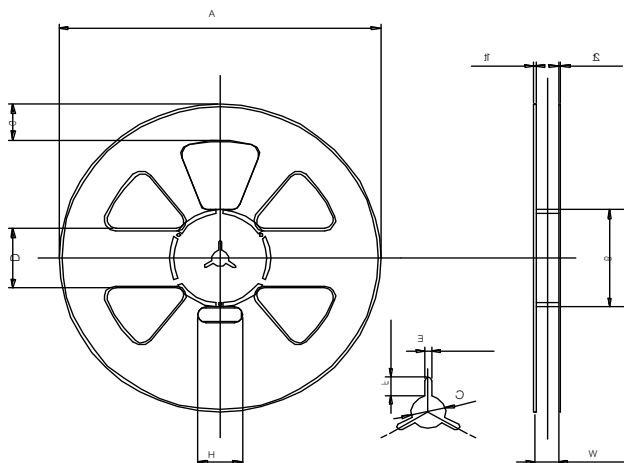

A	B	C	D
Ø258.0 +1.0 -0.5	Ø81.0 +1.0 -1.0	Ø13.0 +0.5 -0.5	50.0 +0.8 -0.8
E	F	G	H
2.2 +0.3 -0.3	7.0 +0.5 -0.5	30.0 +0.8 -0.8	35.0 +1.0 -1.0
t1	t2	W	
1.8 +0.5 -0.5	1.5 +0.5 -0.5	9.0 +1.0 -0.5	

- The product shall be packed properly not to be damaged during transportation and storage.

### 4-2. REELING QUANTITY

10 inch reel: 8,000 pcs/reel

### 4-3. TAPING STRUCTURE

The tape shall be wound around the reel in direction shown below.

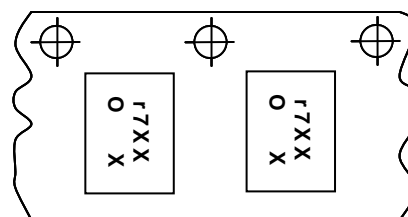
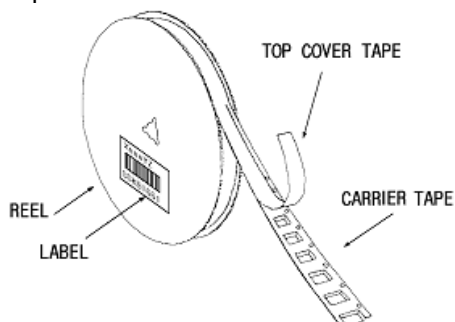

Tape Running direction

## X-ON Electronics

Largest Supplier of Electrical and Electronic Components

*Click to view similar products for [Signal Conditioning](#) category:*

*Click to view products by [WISOL](#) manufacturer:*

Other Similar products are found below :

[MAPDCC0001](#) [MAPDCC0004](#) [PD0409J5050S2HF](#) [HHS-109-PIN](#) [AFS14A30-2185.00-T3](#) [AFS14A35-1591.50-T3](#) [DS-323-PIN](#) [DSS-313-PIN](#) [B39321R801H210](#) [1A0220-3](#) [JP510S](#) [LFB212G45SG8C341](#) [LFB322G45SN1A504](#) [LFL182G45TC3B746](#) [SF2159E](#) [30057](#)  
[AFS1575.42S4-T](#) [FM-104-PIN](#) [CER0813B](#) [MAPDCC0005](#) [3A325](#) [40287](#) [41180](#) [ATB3225-75032NCT](#) [BD0810N50100AHF](#) [JHS-115-PIN](#)  
[DC0710J5005AHF](#) [DC2327J5005AHF](#) [43020](#) [LFB2H2G60BB1C106](#) [LFL15869MTC1B787](#) [X3C19F1-20S](#) [XC3500P-20S](#) [10013-20](#)  
[SF2194E](#) [CDBLB455KCAX39-B0](#) [TGL2208-SM, EVAL](#) [RF1353C](#) [051157-0000](#) [PD0922J5050D2HF](#) [1E1305-3](#) [1F1304-3S](#) [1G1304-30](#)  
[B0922J7575AHF](#) [10017-3](#) [TP-103-PIN](#) [BD1222J50200AHF](#) [BD1722J50100AHF](#) [2450DP39K5400E](#) [BD0810J50150AHF](#)