

# 3528 Series

## 3528 60LED



### CRI Option

- 80+
- 90+

### PCB Thickness

- 2oz
- 3oz
- 4oz-onrequest

### PCB Color

- White
- Black
- Golden

### Color Option

- 2700K
- 3000K
- 4000K
- 5000K
- 6500K
- Red
- Green
- Blue
- Yellow

### Technical Data

Voltage	Code	Color	Watts	Lumen	Efficiency	Pitch	Width
12VDC	D60108-27	2700K	4.8	350	73	50mm	8mm
	D60108-30	3000K	4.8	360	75		8mm
	D60108-40	4000K	4.8	374	78		8mm
	D60108-50	5000K	4.8	374	78		8mm
	D60108-65	6500K	4.8	374	78		8mm
24VDC	D60208-27	2700K	4.8	350	73	100mm	8mm
	D60208-30	3000K	4.8	360	75		8mm
	D60208-40	4000K	4.8	374	78		8mm
	D60208-50	5000K	4.8	374	78		8mm
	D60208-65	6500K	4.8	374	78		8mm

The above measurements are based on IP20.

The above measurements can have a 10% tolerance.

### Dimensions

#### 12VDC

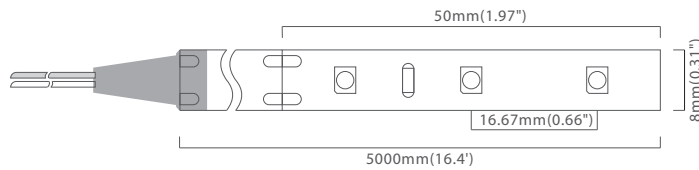

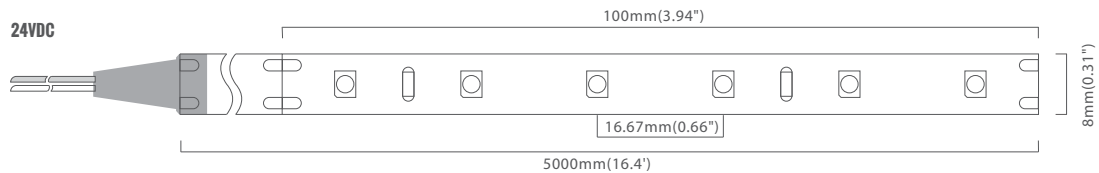

#### 24VDC



### Main Features

- More options on Ra>90.
- LM80 3528SMD with Epistar chip inside.
- 12V or 24V low voltage input for human safety.
- Ideal for office, residential, retail and industry lighting.

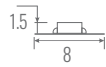
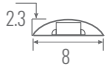
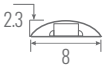
## Available Waterproof Ways

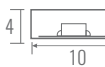
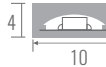
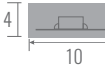
IP Rating	20	54A	54B	65A	65B	67	68
Section							
Material	none	Silicone glue on surface	PU glue on surface	Inject with Heat Shrink tube	Inject with silicone tube	Silicone extrusion	Silicone extrusion

### Accessory | More Options on P332



HH-1616



HH-1707D

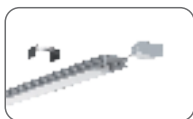

HH-1707

### Accessory | Connector



020101001



020101002



020101003

## X-ON Electronics

Largest Supplier of Electrical and Electronic Components

*Click to view similar products for [LED Lighting Bars and Strips](#) category:*

*Click to view products by [WISVA OPTOELECTRONICS](#) manufacturer:*

Other Similar products are found below :

[LFBLL-SW823-24V-8S125-20](#) [LFBHL-SW927-24V-8S63-20](#) [RF-G30HI3510-241202081-A0 IP20](#) [RF-GW2H39W19-2406020I1-A1 IP20](#)  
[HH-SX144F008W24 -2835 WW WHITE PCB IP20](#) [HH-SRGB840F010W24-COB](#) [N004120BB1LZ \(6000K\)](#) [N004120BC1LZ \(3000K\)](#)  
[N008120BB1LZ \(BLUE\)](#) [N008120BC1LZ \(4000K\)](#) [S008144CA4SA1/C1 \(RGB+4000K IP20\)](#) [S0121134ZC3PZ](#) [COB-480-CW-24-10W](#)  
[HQS-14.4W-60LED-RGB-WP-12V-5M](#) [N013060CA3SA1](#) [HQS-12W-60LED-W-WP-24V-5M](#) [UQS-COB-12W-NW-24V-5M](#) [HH-](#)  
[SNW480F208W24-COB-R](#) [HQS-12W-60LED-NW-WP-12V-5M](#) [S012120BC1HZ \(WARM WHITE\)](#) [HQS-6W-60LED-WW-WP-24V-5M](#)  
[S020240BC1DC0/C3](#) [S012060CB4SA1/C2](#) [HQS-12W-60LED-WW-WP-24V-5M](#) [HH-SW480F008W24-COB-R](#) [UQS-COB-8W-WW-12V-](#)  
[5M](#) [HH-SWW480F008W24-COB-R](#) [COB-480-WW-24-10W](#) [HQS-6W-60LED-NW-WP-12V-5M](#) [S012060CC4DC0/C3](#) [S012048CB4PZ](#)  
[\(RGB+W:3000K\)](#) [HQS-9.6W-120LED-NW-WP-12V-5M](#) [S012480ZB1SF \(WARM WHITE IP20\)](#) [HQS-6W-60LED-WW-12V-5M](#)  
[S012120BC1HZ \(COLD WHITE\)](#) [HQS-6W-60LED-W-WP-12V-5M](#) [HQS-6W-60LED-W-12V-5M](#) [HQS-9.6W-120LED-NW-24V-5M](#) [HQS-](#)  
[9.6W-120LED-NW-12V-5M](#) [UQS-COB-8W-NW-24V-5M](#) [HQS-12W-60LED-WW-12V-5M](#) [S012480ZB1SF \(COLD WHITE IP20\)](#) [HH-](#)  
[SRGB60F310W12-5050 WHITE PCB IP65A](#) [S010120BC3SM/C1](#) [UQS-COB-12W-W-24V-5M](#) [HH-SRGB60F010W12-5050 WHITE PCB](#)  
[IP20](#) [HQS-6W-60LED-NW-12V-5M](#) [HH-SW60F008W12-3528 CW WHITE PCB IP20](#) [HQS-6W-60LED-NW-24V-5M](#) [S004060BB3PZ/C2](#)