

RECOMMENDED PC BOARD LAYOUT  
(ALL TOLERANCE ARE ±0.05)

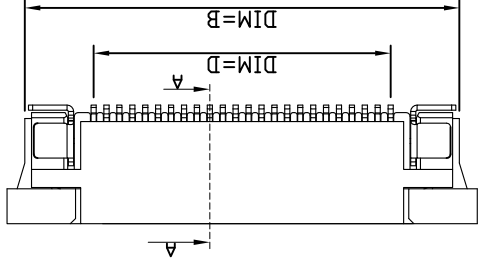
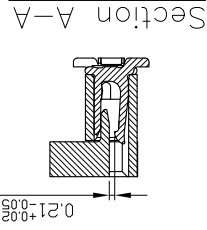
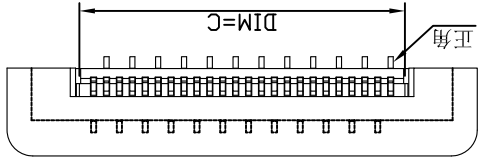
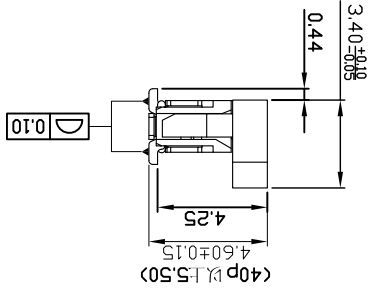
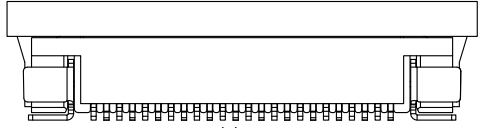

NO.	DESCRIPTION	MATERIAL	COLOR	REMARK
1	HOUSING	THERMOPLASTIC	NATURAL	UL 94V-0
2	ACTUATOR	THERMOPLASTIC	BROWN	UL 94V-0
3	CONTACT	COPPER ALLOY		PLATED TN
4	GASKET	COPPER ALLOY		PLATED TN

品番	DIM-A	DIM-B	DIM-C	DIM-D
4	8.20	6.80	2.60	1.50
5	8.70	7.30	3.10	2.00
6	9.20	7.80	3.60	2.50
7	9.70	8.30	4.10	3.00
8	10.20	8.80	4.60	3.50
9	10.70	9.30	5.10	4.00
10	11.20	9.80	5.60	4.50
11	11.70	10.30	6.10	5.00
12	12.20	10.80	6.60	5.50
13	12.70	11.30	7.10	6.00
14	13.20	11.80	7.60	6.50
15	13.70	12.30	8.10	7.00
16	14.20	12.80	8.60	7.50
17	14.70	13.30	9.10	8.00
18	15.20	13.80	9.60	8.50
19	15.70	14.30	10.10	9.00
20	16.20	14.80	10.60	9.50
21	16.70	15.30	11.10	10.00
22	17.20	15.80	11.60	10.50
23	17.70	16.30	12.10	11.00
24	18.20	16.80	12.60	11.50
25	18.70	17.30	13.10	12.00
26	19.20	17.80	13.60	12.50
27	19.70	18.30	14.10	13.00
28	20.20	18.80	14.60	13.50
29	20.70	19.30	15.10	14.00
30	21.20	19.80	15.60	14.50
31	21.70	20.30	16.10	15.00
32	22.20	20.80	16.60	15.50
33	22.70	21.30	17.10	16.00
34	23.20	21.80	17.60	16.50
35	23.70	22.30	18.10	17.00
36	24.20	22.80	18.60	17.50
37	24.70	23.30	19.10	18.00
38	25.20	23.80	19.60	18.50
39	25.70	24.30	20.10	19.00
40	26.20	24.80	20.60	19.50
41	26.70	25.30	21.10	20.00
42	27.20	25.80	21.60	20.50
43	27.70	26.30	22.10	21.00
44	28.20	26.80	22.60	21.50
45	28.70	27.30	23.10	22.00
46	29.20	27.80	23.60	22.50
47	29.70	28.30	24.10	23.00
48	30.20	28.80	24.60	23.50
49	30.70	29.30	25.10	24.00
50	31.20	29.80	25.60	24.50
51	31.70	30.30	26.10	25.00
52	32.20	30.80	26.60	25.50
53	32.70	31.30	27.10	26.00
54	33.20	31.80	27.60	26.50
55	33.70	32.30	28.10	27.00

Electrical Characteristics:  
 Current rating: 0.4A AC/DC  
 Voltage rating: 50V AC/DC  
 Temperature range: -25°C~+85°C  
 Withstand Voltage: 200V AC/Minute  
 Contact Resistance: ≤ 20mΩ  
 Insulation resistance: 500mΩ  
 Relative Humidity: 93%+40°C

适用FPC寸法

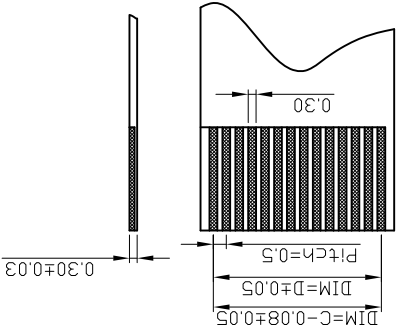

XFCN 兴飞连接器有限公司  
 CONNECTORS XFCN CONNECTORS CO., LTD.

SHEET 1/1  
 DATE 2010.4.12

UNITS mm

SCALE 1:1

DWG NO. 009

TOLERANCE UNLESS OTHERWISE SPECIFIED  
 DRAWN CK tan

CHKD  
 APPD

VIEW  
 PART. NO.

PRODUCT NAME  
 FPC 0.50mm Connectors

MODIFICATION

DATE

XXX ±0.03  
 .XX ±0.08  
 .X ±0.20  
 X ±0.30

±0.5°  
 .XXX°  
 .XX°  
 .X°  
 X°

VIEW  
 PART. NO.

PRODUCT NAME  
 FPC 0.50mm Connectors

DWG NO. 009

VER A0

A B C D E F G

10 9 8 7 6 5 4 3 2 1

## X-ON Electronics

Largest Supplier of Electrical and Electronic Components

*Click to view similar products for [FFC & FPC Connectors](#) category:*

*Click to view products by [XFCN](#) manufacturer:*

Other Similar products are found below :

[HFW11R-1STE1H1LF](#) [FA5B016HP1](#) [FH29B-100S-0.2SHW\(99\)](#) [FA5S008HP1](#) [FH29B-120S-0.2SHW\(99\)](#) [FH29B-80S-0.2SHW\(99\)](#) [FHS-16](#) [FPH-2022G](#) [52610-1075](#) [52610-1275](#) [52610-1934](#) [XF3M\(1\)-1415-1B-R100](#) [501951-3200](#) [0525594033](#) [086210010340800](#)  
[086222026001800](#) [62674-201121DLF](#) [62684-36210E9ALF](#) [52610-1675](#) [52746-1671-TR250](#) [10051922-2810EHLF](#) [6-520415-9](#) [BD021-09A-A1-0350-0200-0550-LD](#) [SFV6R-1STE9HLF](#) [XF3M-2915-1B-R100](#) [1658549-1](#) [62674-221121ALF](#) [46214008010800](#) [046298003000883](#)  
[151660622](#) [842-816-2630-035](#) [AYF331135A](#) [AYF530665TA](#) [AYF351525](#) [046296011930846+](#) [AYF352325A](#) [046254020000800+](#) [FH19C-13S-0.5SH\(99\)](#) [FH39J-51S-0.3SHW\(99\)](#) [AYF355125A](#) [AYF530365TA](#) [FH29B-44S-0.2SHW\(99\)](#) [SFW5R-2STAE9LF](#) [AYF351125A](#)  
[AYF350725A](#) [62684-502100AHLF](#) [FH39-61S-0.3SHW\(99\)](#) [AYF414035A](#) [10064555-172520HLF](#) [AYF212335A](#)