

环保物料

TEL: 0769-82001899

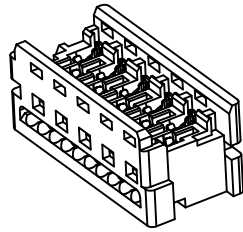

电气性能：
 额定电流：1.0Amp
 最大耐受电压：AC 250V/1Minute
 绝缘电阻：1000M Min/DC 500V
 接触电阻：20m Max
 工作温度：-20 °C +105 °C

MATERIAL & FINISH

Insulator: PBT Glass Fiber(UL94V-0)
 COLOUR WHITE.

Contact : Phosphor Bronze
 Contact : Nickel.

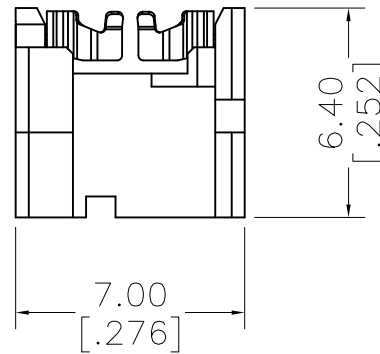
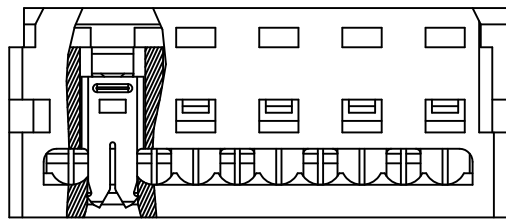

1.27 mm Ribbon Cable

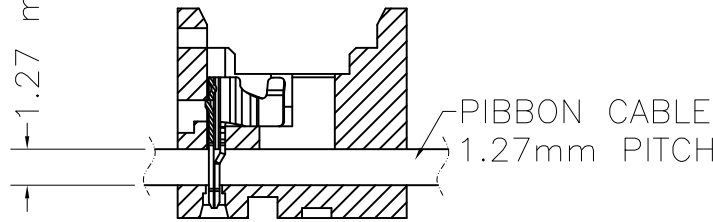

SECTION SHOWING

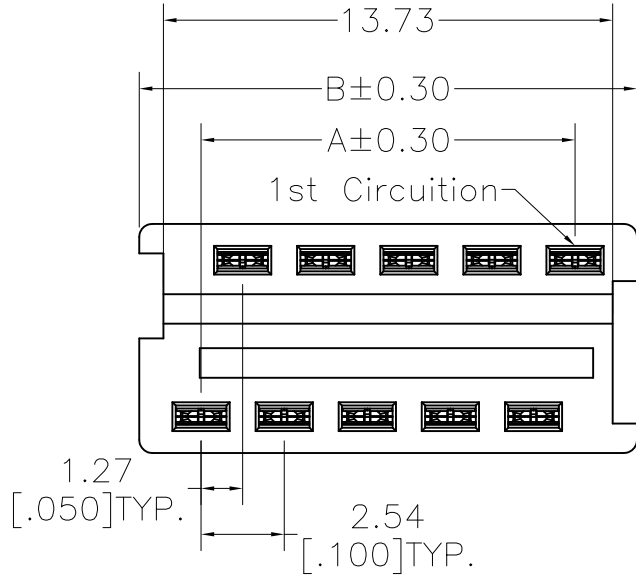

CCT SIZE	DIMENSION A	DIMENSION B
26	(31.75)/1.250	(35.53)/1.399
24	(29.21)/1.150	(32.99)/1.299
22	(26.67)/1.050	(30.45)/1.199
20	(24.13)/.950	(27.91)/1.099
18	(21.59)/.850	(25.37)/.999
16	(19.05)/.750	(22.83)/.899
14	(16.51)/.650	(20.29)/.799
12	(13.97)/.550	(17.75)/.699
10	(11.43)/.450	(15.21)/.599
8	(8.89)/.350	(12.67)/.499
6	(6.35)/.250	(10.13)/.399
4	(3.81)/.150	(7.59)/.299

				TOLERANCE UNLESS OTHERWISE		DRAWN	CK tan	XFCN 兴飞连接器有限公司 CONNECTORS XFCN CONNECTORS CO., LTD.		SHEET	1/1	
				X.	±0.30	X°	±5°			CHKD	DATE	2010. 4. 12
				.X	±0.20	.X°	±2°	APPD	PRODUCT NAME	1.27mm IDC Style Connectors		
				.XX	±0.08	.XX°	±1°	VIEW	PART. NO.	I1276-XX-N0	UNITS	mm
				.XXX	±0.03	.XXX°	±0.5°				DWG. NO.	009
AO	MODIFICATION	DRAW	DATE									

X-ON Electronics

Largest Supplier of Electrical and Electronic Components

Click to view similar products for [Headers & Wire Housings](#) category:

Click to view products by [XFCN](#) manufacturer:

Other Similar products are found below :

[95000-104TRLF](#) [10135584-644402LF](#) [DF62W-EP2022PCA](#) [95000-106TRLF](#) [DF62W-2022SCA](#) [DF62W-EP2022PC](#) [2203348](#) [DF62W-2022SC](#) [1084018](#) [1029039](#) [1084017](#) [802-10-012-10-002000](#) [1112640](#) [1112639](#) [891-007-9SS-BST1T](#) [000-34000](#) [0008550134](#) [0009482033](#) [0009507031](#) [57102-F02-18ULF](#) [57102-S06-03LF](#) [57202-S52-04LF](#) [PCN6-15S-2.5E](#) [0039019024](#) [58102-G61-06LF](#) [582553-1](#) [0009485154](#) [0009508121](#) [0022285053](#) [0050291907](#) [018731A](#) [LY20-4P-DT1-P1E-BR](#) [02.125.8002.8](#) [60101931](#) [60598-1 \(Cut Strip\)](#) [M1625-3R/100](#) [61062-3](#) [61082-181009](#) [CSU011177004](#) [636-1427](#) [638009-1](#) [641938-9](#) [641991-4](#) [644168-1](#) [644827-2](#) [647662-1](#) [65039-019ELF](#) [65692-001LF](#) [65781-018](#) [65781-047](#)