

环保物料

TEL:0769-82001899

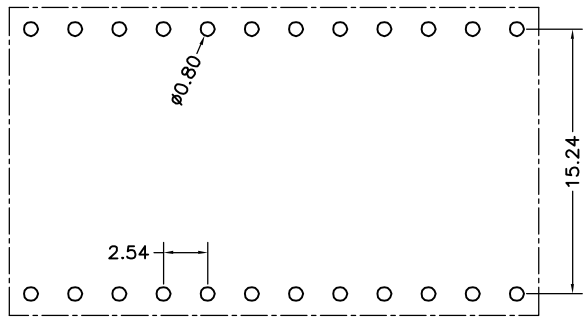
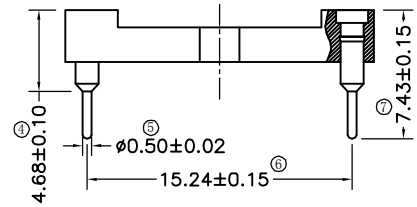
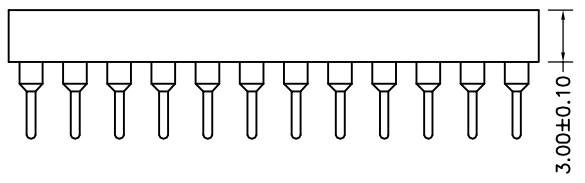
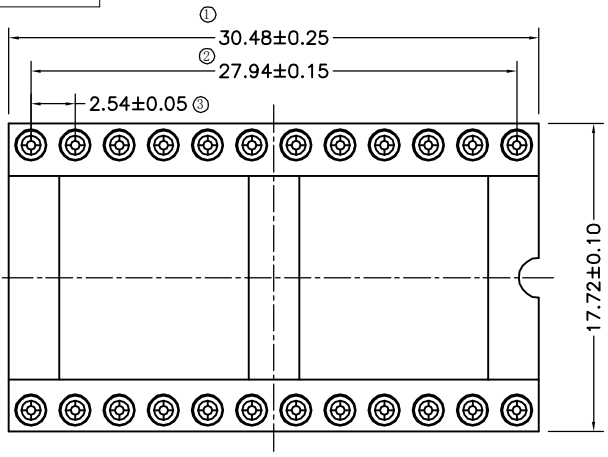

P. C. B LAYOUT

Technical Data
 Material:
 Pin(outer sleeve):Brass,machined CuZn38Pb2
 Plating(outer sleeve):
 Tin Plated:2μm/80μ"NI, 5μm/200μ"Sn
 Gold Plated:2μm"/80μ"Ni, 0.8μ" gold
 Plating(Contact):2μm/80μ"NI, gold or Tin plated
 Insuiator:PPS UL94V-0
 ClIp(Contact 4 Flnger):Beryllium copper,heat teated

Electrical:
 Current rating:3Amps/contact max.
 Contact resistance:≤4mΩ/contact
 Insuiation resistance:≥1000MΩ at V=100V
 Operaing voltage:60VAC/DC

Mechanical:
 Average Insertion force with steel pin of ∅0.432:<250g
 Average withdrawal force with steel pin of ∅0.432:>70g
 Mechanical lige cycle:min 200
 Operaling temperature:-40° C to+105° C
 Soldering temperature:+255° C
 Critical Dimensions:⊗

| | | | | | | | | | | | |
|----|--------------|--|--|----------------------------|-------|-------|--------|---|-------|---------|------------|
| | | | | TOLERANCE UNLESS OTHERWISE | | DRAWN | CK tan | XFCN 兴飞连接器有限公司 XFCN CONNECTORS CO.,LTD. | SHEET | 1/1 | |
| | | | | X. | ±0.30 | X° | ±5° | | CHKD | DATE | 2020.04.12 |
| | | | | .X | ±0.20 | .X° | ±2° | | APPD | UNITS | mm |
| | | | | .XX | ±0.08 | .XX° | ±1° | | VIEW | SCALE | 1:1 |
| AO | MODIFICATION | | | DRAW | DATE | .XXX | ±0.03 | .XXX° | ±0.5° | DWG NO. | 009 |

X-ON Electronics

Largest Supplier of Electrical and Electronic Components

Click to view similar products for [IC & Component Sockets](#) category:

Click to view products by [XFCN](#) manufacturer:

Other Similar products are found below :

[614-DG5](#) [670](#) [672](#) [673](#) [712-93-120-41-001000](#) [714-93-104-31-018000](#) [8-1437531-4](#) [8150-6P10](#) [835-43-014-10-001000](#) [851-41-006-10-001000](#) [851-43-008-20-001000](#) [851-43-014-20-001000](#) [851-93-006-20-001000](#) [851-93-010-20-001000](#) [853-43-020-10-001000](#) [86.010.0053.0](#) [116-43-308-41-007000](#) [121-13-318-41-001000](#) [121-13-320-41-001000](#) [121-13-308-41-001000](#) [123-43-314-41-801000](#) [123-43-420-41-001000](#) [122-13-316-41-001000](#) [123-13-624-41-001000](#) [123-43-306-41-001000](#) [12-3513-11](#) [123-91-320-41-001000](#) [126-43-310-41-002000](#) [AKSUN](#) [37V-T](#) [1437503-9](#) [1437504-1](#) [APA-640-G-P](#) [146-44-308-41-013000](#) [146-43-308-41-012000](#) [160-10-308-00-001000](#) [160-40-320-00-001000](#) [214-99-306-01-670800](#) [2-382761-4](#) [2-5331677-4](#) [2-640360-3](#) [2801-3-00-44-00-00-07-0](#) [940-44-052-17-400004](#) [299-83-314-11-001101](#) [1986000-2](#) [2103331641101000](#) [210-43-320-41-001000](#) [210-99-628-41-001000](#) [2-1437504-6](#) [2-1437515-5](#) [2-1437531-2](#)