

**SPECIFICATIONS**

- 1. Voltage rating: 150V AC, DC
  - 2. Current rating: 3A, AC, DC
  - 3. Withstanding Voltage: 500V AC/minute
  - 4. Insulation resistance: 1000M min
  - 5. Temperature range: -25 °C - +85 °C
  - 6. Contact resistance: 20m max
- WAFER
- Housing Material: PA4T UL 94V0
- Pin Material: Phosphor Bronze or Brass
- Contact Area Plating: Plated Tin or Plated Gold
- Mates with :P1503 series Housing
- Poles: 02-12P
- Part No.: M1503RS-xx-BK

Pin位数

| Poles | Dimensions(mm) |       |       |       |
|-------|----------------|-------|-------|-------|
|       | A              | B     | C     | D     |
| 02    | 1.50           | 6.75  | 2.85  |       |
| 03    | 3.00           | 8.25  | 4.35  |       |
| 04    | 4.50           | 9.75  | 5.85  |       |
| 05    | 6.00           | 11.25 | 7.35  | 3.00  |
| 06    | 7.50           | 12.75 | 8.85  | 3.00  |
| 07    | 9.00           | 14.25 | 10.35 | 4.50  |
| 08    | 10.50          | 15.75 | 11.85 | 6.00  |
| 09    | 12.00          | 17.25 | 13.35 | 7.50  |
| 10    | 13.50          | 18.75 | 14.85 | 9.00  |
| 11    | 15.00          | 20.25 | 16.35 | 10.50 |
| 12    | 16.50          | 21.75 | 17.85 | 12.00 |

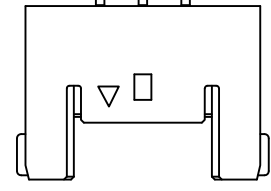
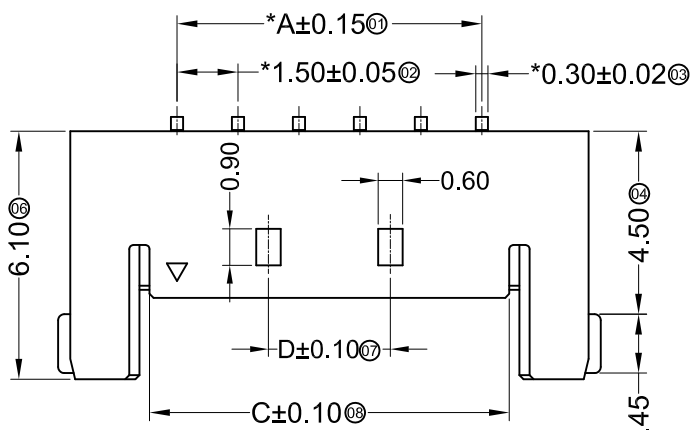

02P~04P Single Hole  
Scale 1:0.7

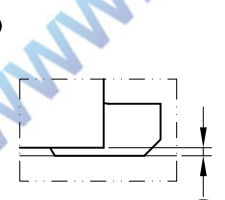
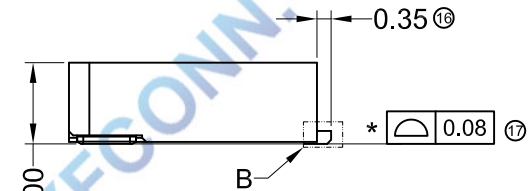

DETAIL B  
SCALE 1:1

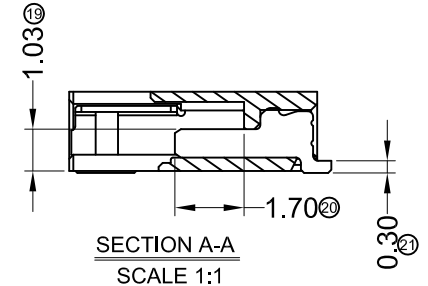

SECTION A-A  
SCALE 1:1

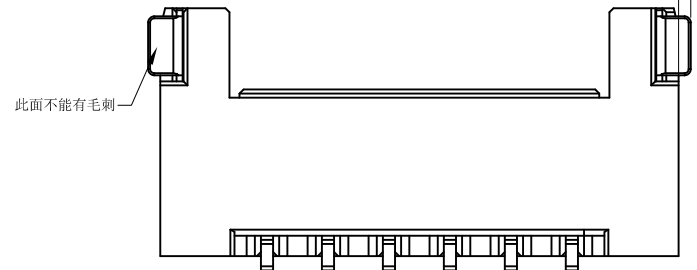

|    |              |      |      |                            |       |       |        |   |              |                               |         |             |
|----|--------------|------|------|----------------------------|-------|-------|--------|---|--------------|-------------------------------|---------|-------------|
|    |              |      |      | TOLERANCE UNLESS OTHERWISE |       | DRAWN | CK tan | XFCN兴飞连接器有限公司<br>CONNECTORS XFCN CONNECTORS CO., LTD. |              | SHEET                         | 1/1     |             |
|    |              |      |      | X.                         | ±0.30 | X°    | ±5°    |   |              | CHKD                          | DATE    | 2010. 4. 12 |
|    |              |      |      | .X                         | ±0.20 | .X°   | ±2°    | APPD  | PRODUCT NAME | 1.50mm Crimp Style Connectors | UNITS   | mm          |
|    |              |      |      | .XX                        | ±0.08 | .XX°  | ±1°    | VIEW  | PART. NO.    | M1503RS-xx-BK                 | SCALE   | 1:1         |
|    |              |      |      | .XXX                       | ±0.03 | .XXX° | ±0.5°  |   |              |                               | DWG NO. | 009         |
| A0 | MODIFICATION | DRAW | DATE |                            |       |       |        |   |              |                               |         |             |

## X-ON Electronics

Largest Supplier of Electrical and Electronic Components

*Click to view similar products for [Headers & Wire Housings](#) category:*

*Click to view products by [XFCN](#) manufacturer:*

Other Similar products are found below :

[57102-F02-18ULF](#) [58102-G61-06LF](#) [0009485154](#) [009176003701906](#) [0050291907](#) [02.125.8002.8](#) [609-3404](#) [61062-3](#) [622-0430](#) [622-3653LF](#)  
[63453-116](#) [636-1030](#) [636-1427](#) [636-3427](#) [636-4007](#) [641938-9](#) [644827-2](#) [65495-038](#) [65692-001LF](#) [65781-018](#) [65781-047](#) [65817-010LF](#)  
[65817-015LF](#) [66207-023LF](#) [67016-026LF](#) [67095-007LF](#) [68631-112](#) [68645-018](#) [68648-049](#) [699319-000](#) [70.362.1628.0](#) [70-4210](#) [70-4226B](#)  
[70-4853B](#) [707-5020](#) [707-5028](#) [71.350.2428.0](#) [71961-016LF](#) [733-134](#) [754199-000](#) [760-3052](#) [787-8014-00](#) [FCN-367T-T012/H](#) [80.063.4001.1](#)  
[800-90-010-10-002000](#) [801-43-002-10-013000](#) [801-43-006-10-002000](#) [803-41-018-10-001000](#) [803-43-014-20-001000](#) [803-43-024-10-001000](#)