

Poles	DIM.A	DIM.B	Poles	DIM.A	DIM.B
2P	2.0	8.0	10P	18.0	24.0
3P	4.0	10.0	11P	20.0	26.0
4P	6.0	12.0	12P	22.0	28.0
5P	8.0	14.0	13P	24.0	30.0
6P	10.0	16.0	14P	26.0	32.0
7P	12.0	18.0	15P	28.0	34.0
8P	14.0	20.0	16P	30.0	36.0
9P	16.0	22.0	-	-	-

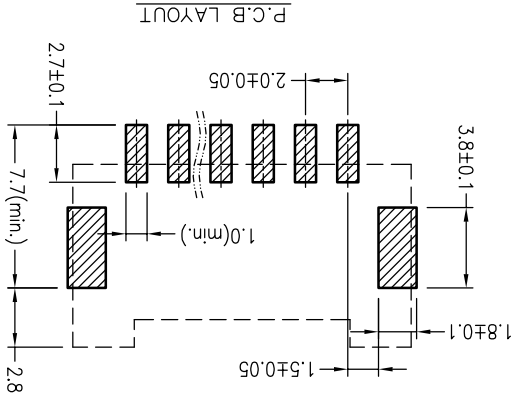
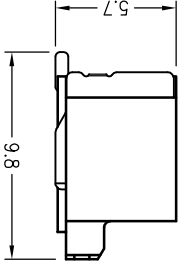
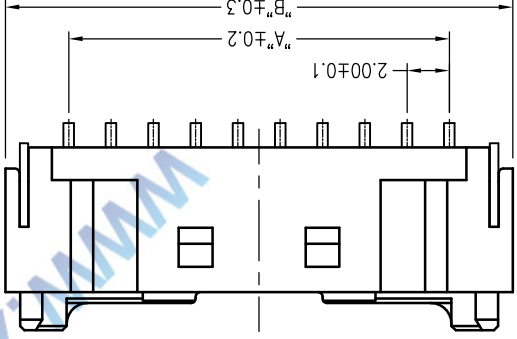
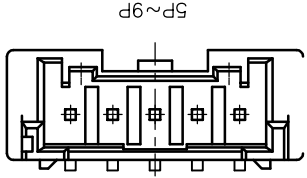
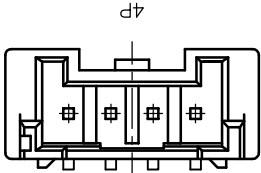
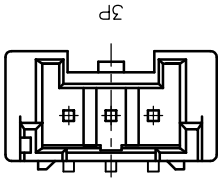
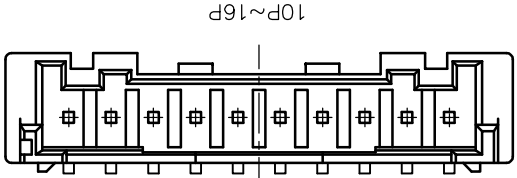
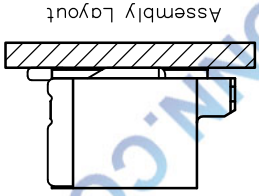
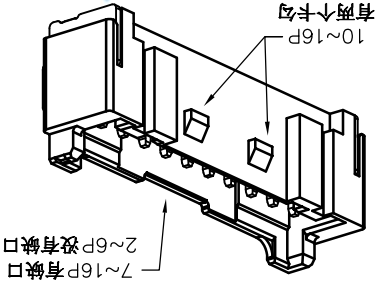

**SPECIFICATIONS**

- Voltage rating: 250V AC, DC
- Current rating: 3A, AC, DC
- Withstanding Voltage: 1000V AC/minute
- Insulation resistance: 800M min
- Temperature range: -25 °C +85 °C
- Contact resistance: 20m max

WAFER  
Housing Material: PA9T UL94V-0  
Pin Material: Phosphor Bronze or Brass  
Contact Area Plating: Plated Tin or Plated Gold  
Mates with: P2029 series Housing  
Poles: 02-16P  
Part No.: M2029RS-xx-9T-R  
R=卷装 无=管装  
Pin位数

VER	MODIFICATION		DATE	TOLERANCE UNLESS OTHERWISE	DRAWN	CK tan	DRAWN	CHKD	APPD	VIEW	PART. NO.	PRODUCT NAME	UNITS	SCALE	Dwg. NO.
	A0														
XFCN 兴飞连接器有限公司															
CONNECTORS XFCN CONNECTORS CO., LTD.															
2.00mm Crimp Style Connectors															
M2029RS-xx-9T-R															
CONNECTION DIAGRAM															
TOLERANCE UNLESS OTHERWISE															
DRAWN															
CHKD															
APPD															
VIEW															
PART. NO.															
PRODUCT NAME															
UNITS															
SCALE															
Dwg. NO.															
DATE															
SHEET															
1/1															
2010.4.12															
mm															
1:1															
009															

## X-ON Electronics

Largest Supplier of Electrical and Electronic Components

*Click to view similar products for [Headers & Wire Housings](#) category:*

*Click to view products by [XFCN](#) manufacturer:*

Other Similar products are found below :

[95000-104TRLF](#) [10135584-644402LF](#) [DF62W-EP2022PCA](#) [95000-106TRLF](#) [DF62W-2022SCA](#) [DF62W-EP2022PC](#) [2203348](#) [DF62W-2022SC](#) [1084018](#) [1029039](#) [1084017](#) [802-10-012-10-002000](#) [1112640](#) [1112639](#) [891-007-9SS-BST1T](#) [000-34000](#) [0008550134](#) [0009482033](#) [0009507031](#) [57102-F02-18ULF](#) [57102-S06-03LF](#) [57202-S52-04LF](#) [PCN6-15S-2.5E](#) [0039019024](#) [58102-G61-06LF](#) [582553-1](#) [0009485154](#) [0009508121](#) [0022285053](#) [0050291907](#) [018731A](#) [LY20-4P-DT1-P1E-BR](#) [02.125.8002.8](#) [60101931](#) [60598-1 \(Cut Strip\)](#) [M1625-3R/100](#) [61062-3](#) [61082-181009](#) [CSU011177004](#) [636-1427](#) [638009-1](#) [641938-9](#) [641991-4](#) [644168-1](#) [644827-2](#) [647662-1](#) [65039-019ELF](#) [65692-001LF](#) [65781-018](#) [65781-047](#)