

2PIN

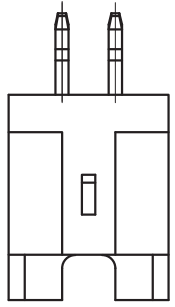

3PIN

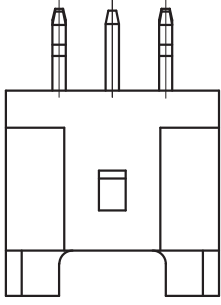

4-9PIN

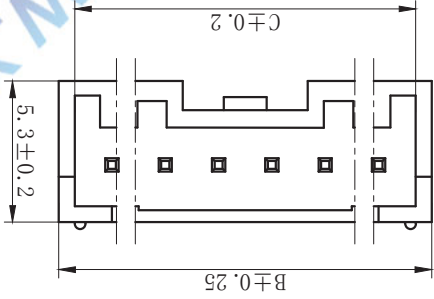
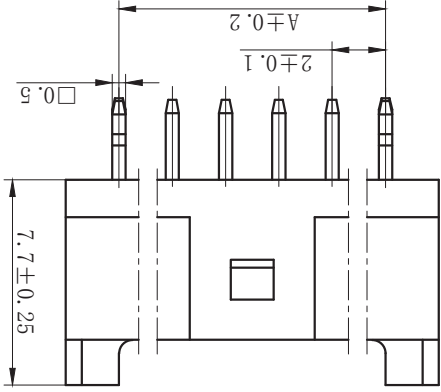

10PIN以上

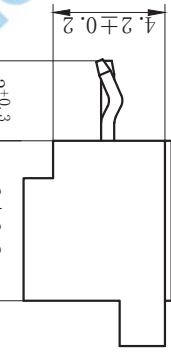
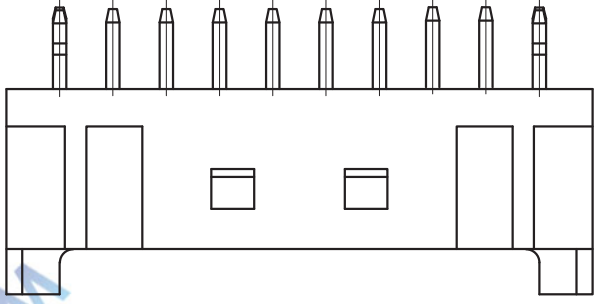

CONN. TYPE

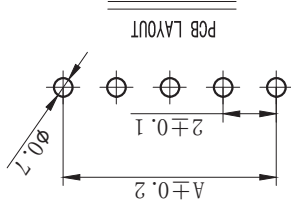

P/N	DIM A	DIM B	DIM C
2	2.0	6.0	4.8
3	4.0	8.0	6.8
4	6.0	10.0	8.8
5	8.0	12.0	10.8
6	10.0	14.0	12.8
7	12.0	16.0	14.8
8	14.0	18.0	16.8
9	16.0	20.0	18.8
10	18.0	22.0	20.8
11	20.0	24.0	22.8
12	22.0	26.0	24.8
13	24.0	28.0	26.8
14	26.0	30.0	28.8
15	28.0	32.0	30.8
16	30.0	34.0	32.8

Pin位数

Part No.: M2029V-xx-N0

Poles:02-16P

Mates with :P2029 series Housing

Contact Area Plating: Plated Tin or Plated Gold

Pin Material: Phosphor Bronze or Brass

Housing Material: Nylon UL94V-0

WAFER

6.Contact resistance: 20m max

5.Temperature range: -25 ° C+85 ° C

4.insulation resistance:800M min

3.Withstanding Voltage: 1000V AC/minute

2.Current rating: 3A, AC, DC

1.Voltage rating: 250V AC, DC

SPECIFICATIONS

VER	MODIFICATION		DRAW	DATE	TOLERANCE UNLESS OTHERWISE		DRAWN	CK tan
A0					X. ±0.30 X° ±5°			
					.X ±0.20 X° ±2°			
					.XX ±0.08 XX° ±1°			
					.XXX ±0.03 .XXX° ±0.5°			
						VIEW	VIEW	VIEW
						APPD	APPD	APPD
						CHKD	CHKD	CHKD
						DRAWN	DRAWN	DRAWN
						DATE	DATE	DATE
						UNITS	UNITS	UNITS
						SCALE	SCALE	SCALE
						DWG NO.	DWG NO.	DWG NO.

XFCN 兴飞连接器有限公司
CONNECTORS XFCN CONNECTORS CO., LTD.

PRODUCT NAME: 2.00mm Crimp Style Connectors

PART. NO. M2029V-xx-N0

DATE: 2010.4.12

SHEET: 1/1

UNITS: mm

SCALE: 1:1

DWG NO.: 009

X-ON Electronics

Largest Supplier of Electrical and Electronic Components

Click to view similar products for [Headers & Wire Housings](#) category:

Click to view products by [XFCN](#) manufacturer:

Other Similar products are found below :

[95000-104TRLF](#) [10135584-644402LF](#) [DF62W-EP2022PCA](#) [95000-106TRLF](#) [DF62W-2022SCA](#) [DF62W-EP2022PC](#) [2203348](#) [DF62W-2022SC](#) [1084018](#) [1029039](#) [1084017](#) [802-10-012-10-002000](#) [1112640](#) [1112639](#) [891-007-9SS-BST1T](#) [000-34000](#) [0008550134](#) [0009482033](#) [0009507031](#) [57102-F02-18ULF](#) [57102-S06-03LF](#) [57202-S52-04LF](#) [PCN6-15S-2.5E](#) [0039019024](#) [58102-G61-06LF](#) [582553-1](#) [0009485154](#) [0009508121](#) [0022285053](#) [0050291907](#) [018731A](#) [LY20-4P-DT1-P1E-BR](#) [02.125.8002.8](#) [60101931](#) [60598-1 \(Cut Strip\)](#) [M1625-3R/100](#) [61062-3](#) [61082-181009](#) [CSU011177004](#) [636-1427](#) [638009-1](#) [641938-9](#) [641991-4](#) [644168-1](#) [644827-2](#) [647662-1](#) [65039-019ELF](#) [65692-001LF](#) [65781-018](#) [65781-047](#)