

SPECIFICATIONS

- 1. Voltage rating: 250V AC, DC
- 2. Current rating: 3A, AC, DC
- 3. Withstanding Voltage: 1000V AC/minute
- 4. Insulation resistance: 800M min
- 5. Temperature range: -25 °C +85 °C
- 6. Contact resistance: 20m max

WAFER

Housing Material: Nylon UL94V-0

Pin Material: Phosphor Bronze or Brass

Contact Area Plating: Plated Tin or Plated Gold

Mates with: P2029 series Housing

Poles: 02-16P

Part No.: M2029V-xx-N0

Pin位数

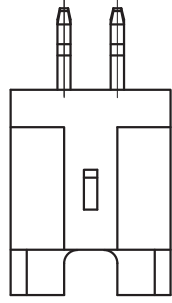
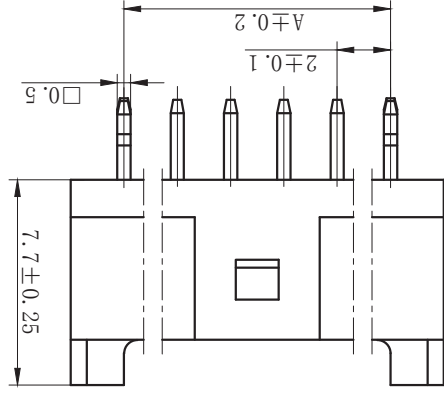
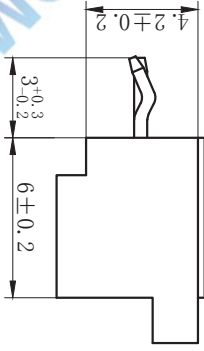

2PIN

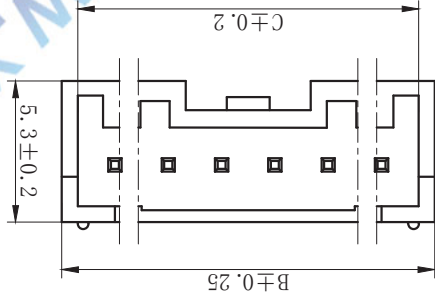

3PIN

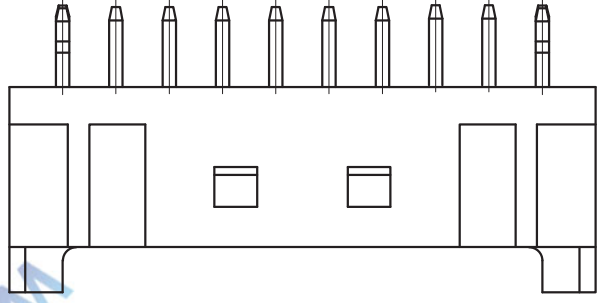
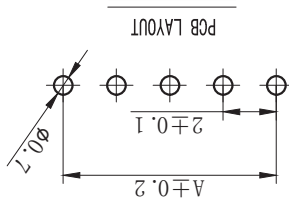
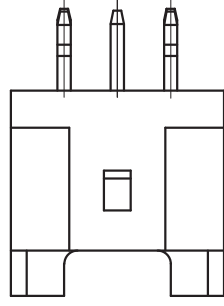

10PIN以上

A0	VER	MODIFICATION		DRAW	DATE	X.XXX	±0.03	.XXX°	±0.5°	VIEW	⊙	PART. NO.	M2029V-xx-N0	DWG NO.	009	
						.XX	±0.08	.XX°	±1°	APPD		PRODUCT NAME	2.00mm Crimp Style Connectors	UNITS	mm	
						.X	±0.20	.X°	±2°	CHKD		CONNECTORS XFCN CONNECTORS CO., LTD.	DATE	2010.4.12	SCALE	1:1
						X.	±0.30	X°	±5°	DRAWN	CK tan	XFCN 兴飞连接器有限公司	SHEET	1/1		
						TOLERANCE UNLESS OTHERWISE										

P/N	DIM A	DIM B	DIM C
2	2.0	6.0	4.8
3	4.0	8.0	6.8
4	6.0	10.0	8.8
5	8.0	12.0	10.8
6	10.0	14.0	12.8
7	12.0	16.0	14.8
8	14.0	18.0	16.8
9	16.0	20.0	18.8
10	18.0	22.0	20.8
11	20.0	24.0	22.8
12	22.0	26.0	24.8
13	24.0	28.0	26.8
14	26.0	30.0	28.8
15	28.0	32.0	30.8
16	30.0	34.0	32.8

X-ON Electronics

Largest Supplier of Electrical and Electronic Components

Click to view similar products for [Headers & Wire Housings](#) category:

Click to view products by [XFCN](#) manufacturer:

Other Similar products are found below :

[95000-104TRLF](#) [10135584-644402LF](#) [DF62W-EP2022PCA](#) [95000-106TRLF](#) [DF62W-2022SCA](#) [DF62W-EP2022PC](#) [2203348](#) [DF62W-2022SC](#) [1084018](#) [1029039](#) [1084017](#) [802-10-012-10-002000](#) [1112640](#) [1112639](#) [891-007-9SS-BST1T](#) [000-34000](#) [0008550134](#) [0009482033](#) [0009507031](#) [57102-F02-18ULF](#) [57102-S06-03LF](#) [57202-S52-04LF](#) [PCN6-15S-2.5E](#) [0039019024](#) [58102-G61-06LF](#) [582553-1](#) [0009485154](#) [0009508121](#) [0022285053](#) [0050291907](#) [018731A](#) [LY20-4P-DT1-P1E-BR](#) [02.125.8002.8](#) [60101931](#) [60598-1 \(Cut Strip\)](#) [M1625-3R/100](#) [61062-3](#) [61082-181009](#) [CSU011177004](#) [636-1427](#) [638009-1](#) [641938-9](#) [641991-4](#) [644168-1](#) [644827-2](#) [647662-1](#) [65039-019ELF](#) [65692-001LF](#) [65781-018](#) [65781-047](#)