

TEL: 0769-82001899

环保物料

■ SPECIFICATIONS

- Voltage rating: 250V AC, DC
- Current rating: 5A, AC, DC
- Withstanding Voltage: 1500V AC/minute
- Insulation resistance: 100M Ω min
- Temperature range: -25 $^{\circ}$ C~+85 $^{\circ}$ C
- Contact resistance: 20m Ω max

■ WAFER

- Poles : 02-12P
- Housing Material: Nylon66 15%GF UL94V-0 Black
- Pin Material: Brass
- Contact Area Plating: Tin-Plated
- The Dimension Marked "▲" Must Be Recorded

CIRCUIT SIZE LAYOUT

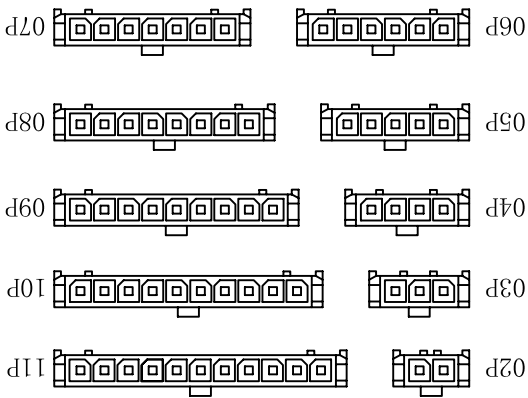

PART NO.	Dimensions (mm)	
	A	B
02	3.00	9.65
03	6.00	12.65
04	9.00	15.65
05	12.00	18.65
06	15.00	21.65
07	18.00	24.65
08	21.00	27.65
09	24.00	30.65
10	27.00	33.65
11	30.00	36.65
12	33.00	39.65

P. C. B. LAYOUT

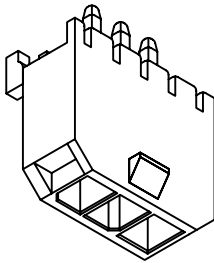
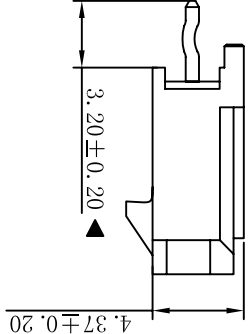
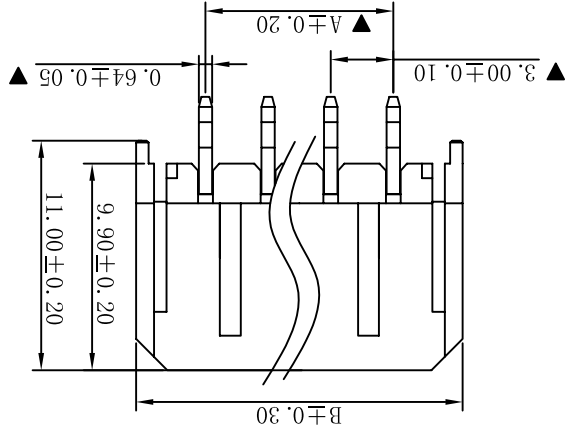
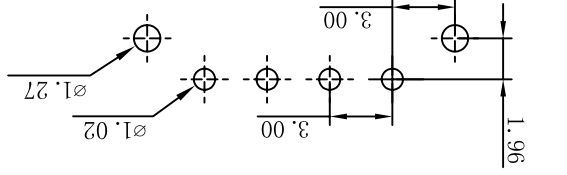

VER	MODIFICATION			DRAW	DATE	TOLERANCE UNLESS OTHERWISE SPECIFIED	DRAWN	CK tan	PART. NO.	PRODUCT NAME	M3025V-1XXX-BK	DWG NO.	009
	A0												
X	± 0.30	X	$\pm 5^{\circ}$	CHKD	APPD	VIEW	VIEW	VIEW	PART. NO.	PRODUCT NAME	M3025V-1XXX-BK	DWG NO.	009
	$\pm 1^{\circ}$.XX	$\pm 1^{\circ}$										
X	± 0.20	.X	$\pm 2^{\circ}$	DATE	DATE	TOLERANCE UNLESS OTHERWISE SPECIFIED	DRAWN	CK tan	PART. NO.	PRODUCT NAME	M3025V-1XXX-BK	DWG NO.	009
.XX	± 0.08	.XX	$\pm 1^{\circ}$										
.XXX	± 0.03	.XXX	$\pm 0.5^{\circ}$										

XFCN 飞连接器有限公司
CONNECTORS XFCN CONNECTORS CO., LTD.

3.00mm Crimp Style Connectors

CONNECTIONS XFCN CONNECTORS CO., LTD.

DATE: 2010.4.12

SHEET: 1/1

UNITS: mm

SCALE: 1:1

DWG NO. 009

X-ON Electronics

Largest Supplier of Electrical and Electronic Components

Click to view similar products for [Headers & Wire Housings](#) category:

Click to view products by [XFCN](#) manufacturer:

Other Similar products are found below :

[95000-104TRLF](#) [10135584-644402LF](#) [DF62W-EP2022PCA](#) [95000-106TRLF](#) [DF62W-2022SCA](#) [DF62W-EP2022PC](#) [2203348](#) [DF62W-2022SC](#) [1084018](#) [1029039](#) [1084017](#) [802-10-012-10-002000](#) [1112640](#) [1112639](#) [891-007-9SS-BST1T](#) [000-34000](#) [0008550134](#) [0009482033](#) [0009507031](#) [57102-F02-18ULF](#) [57102-S06-03LF](#) [57202-S52-04LF](#) [PCN6-15S-2.5E](#) [0039019024](#) [58102-G61-06LF](#) [582553-1](#) [0009485154](#) [0009508121](#) [0022285053](#) [0050291907](#) [018731A](#) [LY20-4P-DT1-P1E-BR](#) [02.125.8002.8](#) [60101931](#) [60598-1 \(Cut Strip\)](#) [M1625-3R/100](#) [61062-3](#) [61082-181009](#) [CSU011177004](#) [636-1427](#) [638009-1](#) [641938-9](#) [641991-4](#) [644168-1](#) [644827-2](#) [647662-1](#) [65039-019ELF](#) [65692-001LF](#) [65781-018](#) [65781-047](#)