

环保物料

TEL:0769-82001899

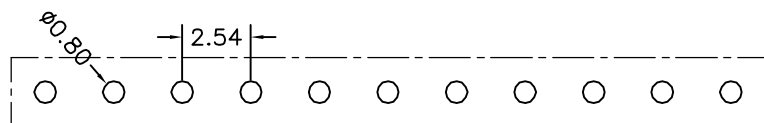
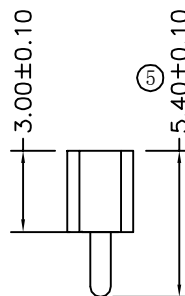
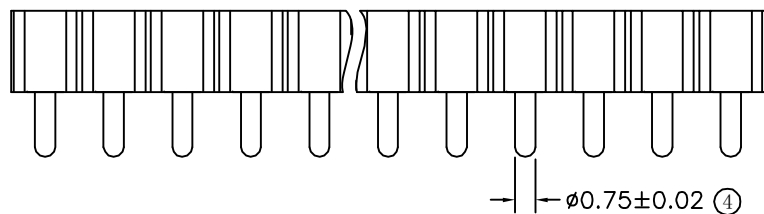
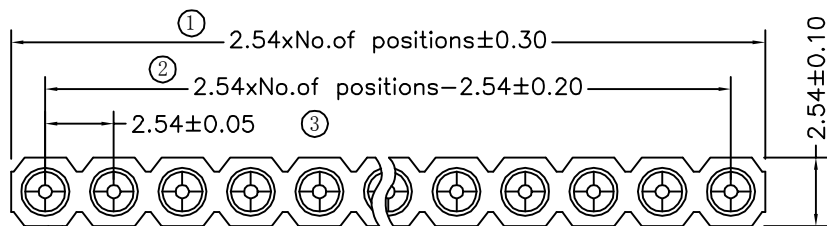

P. C. B LAYOUT

Technical Data

Material:

Pin(outer sleeve):Brass,machined CuZn38Pb2

Plating(outer sleeve):

Tin Plated:2 μ m/80 μ "Ni, 5 μ m/200 μ "Sn

Gold Plated:2 μ m"/80 μ "Ni, 0.8 μ " gold

Plating(Contact):2 μ m/80 μ "Ni, gold or Tin plated

Insuiator:PPS UL94V-0

ClIp(Contact 4 Flnger):Beryllium copper,heat teated

Electrical:

Current rating:3Amps/contact max.

Contact resistance: $\leq 4m\Omega$ /contact

Insuiation resistance: $\geq 1000M\Omega$ at V=100V

Operaing voltage:60VAC/DC

Mechanical:

Average Insertion force with steel pin of $\phi 0.432$:<250g

Average withdrawal force with steel pin of $\phi 0.432$:>70g

Mechanical lige cycle:min 200

Operaling temperature:-40° C to+105° C

Soldering temperature:+255° C

Critical Dimensions:⊗

				TOLERANCE UNLESS OTHERWISE		DRAWN	CK tan	XFCN 兴飞连接器有限公司 XFCN CONNECTORS CO.,LTD.	SHEET	1/1	
				X. ±0.30	X° . ±5°	CHKD			DATE	2020. 04. 12	
				. X ±0.20	. X° ±2°	APPD			UNITS	mm	
				. XX ±0.08	. XX° ±1°	VIEW	⊗ ⊚		SCALE	1:1	
AO				. XXX ±0.03	. XXX° ±0.5°			PRODUCT NAME	2.54mm Machined Female Header	DWG NO.	009
VER	MODIFICATION	DRAW	DATE					PART. NO.	MF254V-11-xx-0540		

X-ON Electronics

Largest Supplier of Electrical and Electronic Components

Click to view similar products for [Headers & Wire Housings](#) category:

Click to view products by [XFCN](#) manufacturer:

Other Similar products are found below :

[57102-F02-18ULF](#) [58102-G61-06LF](#) [0009485154](#) [009176003701906](#) [0050291907](#) [02.125.8002.8](#) [609-3404](#) [61062-3](#) [622-0430](#) [622-3653LF](#)
[63453-116](#) [636-1030](#) [636-1427](#) [636-3427](#) [636-4007](#) [641938-9](#) [644827-2](#) [65495-038](#) [65692-001LF](#) [65781-018](#) [65781-047](#) [65817-010LF](#)
[65817-015LF](#) [66207-023LF](#) [67016-026LF](#) [67095-007LF](#) [68631-112](#) [68645-018](#) [68648-049](#) [699319-000](#) [70.362.1628.0](#) [70-4210](#) [70-4226B](#)
[70-4853B](#) [707-5020](#) [707-5028](#) [71.350.2428.0](#) [71961-016LF](#) [733-134](#) [754199-000](#) [760-3052](#) [787-8014-00](#) [FCN-367T-T012/H](#) [80.063.4001.1](#)
[800-90-001-10-001000](#) [800-90-010-10-002000](#) [801-43-002-10-013000](#) [801-43-006-10-002000](#) [803-41-018-10-001000](#) [803-43-014-20-](#)
[001000](#)