

TEL:0769-82001899

环保物料

Technical Data

Material: Pin(outer sleeve):Brass,machined CuZn38Pb2
 Plating(outer sleeve):
 Tin Plated:2µm/80µm"Ni,5µm/200µ"Sn
 Gold Plated:2µm/80µm"Ni,0.8µ" gold
 Insulator:PPS UL94V-0

Electrical:
 Current rating:3Amps/contact max.
 Contact resistance:≤4mΩ/contact
 Insulation resistance:≥1000MΩ at V=100V
 Dielectric Withstanding Voltage:1000V AV Min

Operating voltage:60VAC/DC

Mechanical:
 Operating temperature:-40° C to+105° C
 Soldering temperature:+255° C

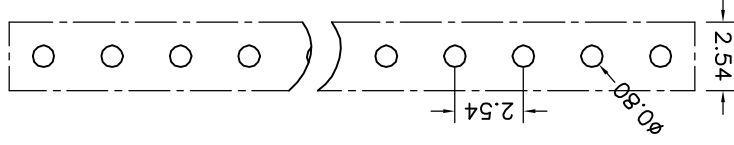
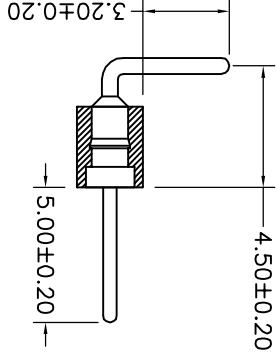
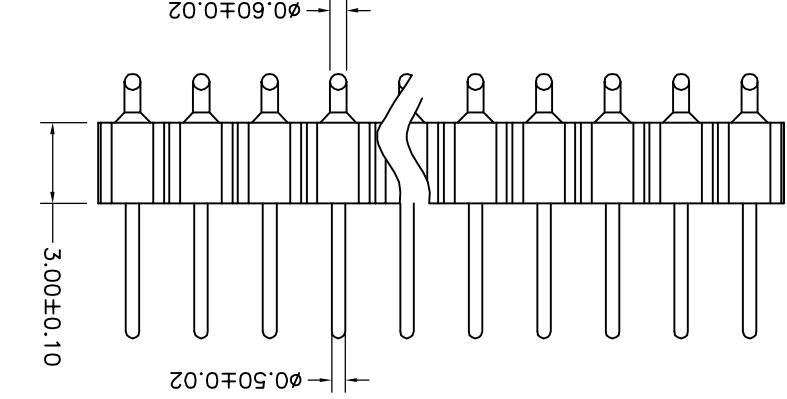
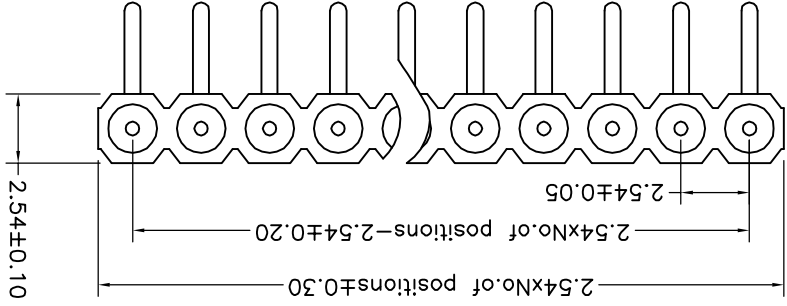

P. C. B LAYOUT

VER	MODIFICATION			DATE	.XXX ±0.03	.XX ±0.08	.X ±0.20	X. ±0.30	TOLERANCE UNLESS OTHERWISE	DRAWN	CK tan	PART. NO.	MH254R-11-XX-1376	Dwg NO.	009
	A0														
												PRODUCT NAME	2.54mm Machined Pin Header	SCALE	1:1
												CONNECTORS XFCN CONNECTORS CO., LTD.	XFCN 飞连接器有限公司	UNITS	mm
														DATE	2010.4.12
														SHEET	1/1

10

9

8

7

6

5

4

3

2

1

G

G

F

F

E

E

D

D

C

C

B

B

A

A

10

9

8

7

6

5

4

3

2

1

X-ON Electronics

Largest Supplier of Electrical and Electronic Components

Click to view similar products for [Headers & Wire Housings](#) category:

Click to view products by [XFCN](#) manufacturer:

Other Similar products are found below :

[95000-104TRLF](#) [10135584-644402LF](#) [DF62W-EP2022PCA](#) [95000-106TRLF](#) [DF62W-2022SCA](#) [DF62W-EP2022PC](#) [2203348](#) [DF62W-2022SC](#) [1084018](#) [1029039](#) [1084017](#) [802-10-012-10-002000](#) [1112640](#) [1112639](#) [891-007-9SS-BST1T](#) [000-34000](#) [0008550134](#) [0009482033](#) [0009507031](#) [57102-F02-18ULF](#) [57102-S06-03LF](#) [57202-S52-04LF](#) [PCN6-15S-2.5E](#) [0039019024](#) [58102-G61-06LF](#) [582553-1](#) [0009485154](#) [0009508121](#) [0022285053](#) [0050291907](#) [018731A](#) [LY20-4P-DT1-P1E-BR](#) [02.125.8002.8](#) [60101931](#) [60598-1 \(Cut Strip\)](#) [M1625-3R/100](#) [61062-3](#) [61082-181009](#) [CSU011177004](#) [636-1427](#) [638009-1](#) [641938-9](#) [641991-4](#) [644168-1](#) [644827-2](#) [647662-1](#) [65039-019ELF](#) [65692-001LF](#) [65781-018](#) [65781-047](#)