

**RoHS**

**MATERIAL LIST**

TEL:0769-82001899

VER	DESCRIBE	NATE	DRAWN
A0	新图框编制	2022/08/29	姜光鸿

NO.	PART	MATERIAL	COATING/COLOR	QTY
1	HOUSING	PPS UL94V-0	BLACK	1
2	TERMINALS	BRASS	PLATING GOLD	N

**NOTE:**

- 1 TECHNICAL PARAMETER:
- 1.1 RATINGS: 3A/250V (DC AC)
- 1.2 CONTACT RESISTANCE: 20MΩ MAX.
- 1.3 INSULATION RESISTANCE: 1000MΩ MIN
- 1.4 WITHSTAND VOLTAGE: 1000V AC/MINUTE
- 1.5 WORKING TEMPERATURE: -40°C TO +105°C
- 1.6 WELDING TEMPERATURE:+255°C

料号释义:		MH		254		V		11		XX		1196		XXX		X		XX	
MH=圆孔排针	127=1.27间距 100=1.00间距 200=2.00间距 254=2.54间距	焊板角度: V:直插 R:弯插 VS:立贴 RS:卧贴	11=单塑单排 12=单塑双排 21=双塑单排 22=双塑双排	XX=Pin位	排针总长: routine=1196 1196=11.96	塑胶高度: routine=3.00 H30=3.00	材质: P=PBT 6=PA6T 9=PA9T L=LCP S=PPS	镀层: routine=GF T1=Tin 150u" T2=Tin 200u" G1=G/F G2=Gold 3u" G3=Gold 10u" G4=Gold 15u" G5=Gold 30u"											

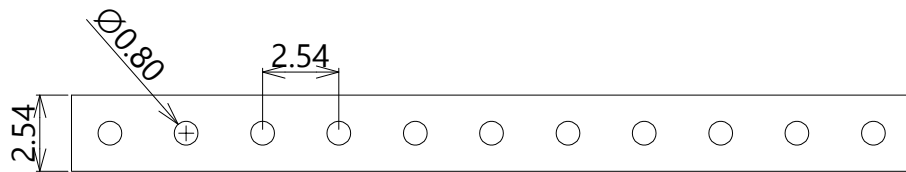
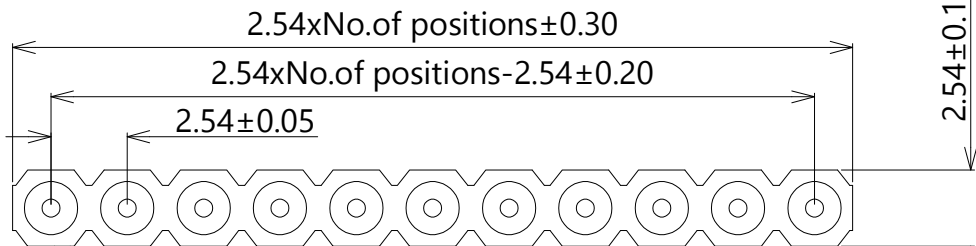

**P.C.B LAYOUT**

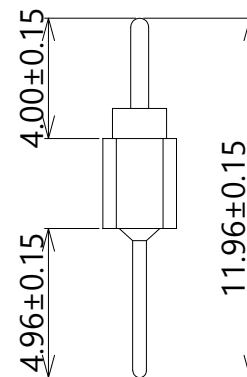
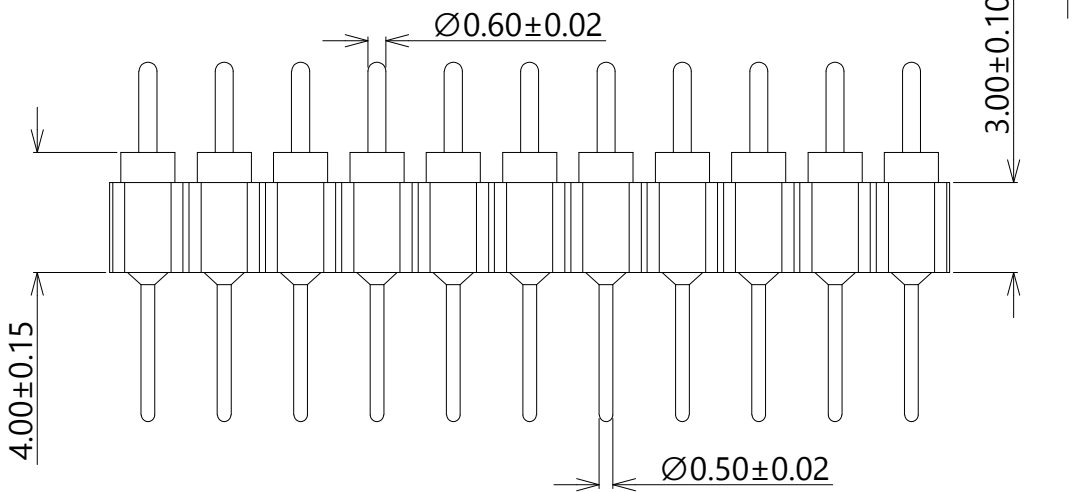

**Product specification:1~40PIN**

TOLERANCE UNLESS OTHERWISE				UNIT	mm	<b>XFCN</b> 兴飞连接器有限公司 XFCN CONNECTORS CO., LTD.	DRAWN	姜光鸿	
X. ±0.30	X° ±5°	VIEW		SCALE	1:1		TYPE	2.54mm Machined Pin Header	CHKD
.X ±0.20	.X° ±2°	NUMBER	XF-MH001	PART.NO.	MH254V-11-XX-1196	DATE	2022/08/29	APPD	
.XX ±0.08	.XX° ±1°								
.XXX ±0.03	.XXX° ±0.5°								

## X-ON Electronics

Largest Supplier of Electrical and Electronic Components

*Click to view similar products for [Headers & Wire Housings](#) category:*

*Click to view products by [XFCN](#) manufacturer:*

Other Similar products are found below :

[0015917161](#) [0022155065](#) [57102-F02-18ULF](#) [58102-G61-06LF](#) [582553-1](#) [01.001.5753.1](#) [0050291907](#) [02.125.8002.8](#) [609-3404](#) [61062-3](#)  
[CSU011177004](#) [622-0430](#) [622-3653LF](#) [63453-116](#) [636-1030](#) [636-1427](#) [636-3427](#) [636-4007](#) [641938-9](#) [65495-038](#) [65692-001LF](#) [65781-018](#)  
[65781-047](#) [65817-010LF](#) [65817-015LF](#) [67095-007LF](#) [67601157](#) [68631-112](#) [68645-018](#) [699319-000](#) [70.362.1628.0](#) [70-4210](#) [70-4226B](#) [70-](#)  
[4853B](#) [71.350.2428.0](#) [733-134](#) [733-162](#) [760-3052](#) [MHR-64-VUAL](#) [80.063.4001.1](#) [800-90-001-10-001000](#) [801-43-002-10-013000](#)  
[801-43-006-10-002000](#) [803-43-024-10-001000](#) [803-93-012-10-001000](#) [8-1437020-4](#) [819-22-004-30-001101](#) [820-22-006-30-001101](#)  
[820-22-008-30-001101](#) [821-22-002-10-001101](#)