

环保物料

TEL:0769-82001899

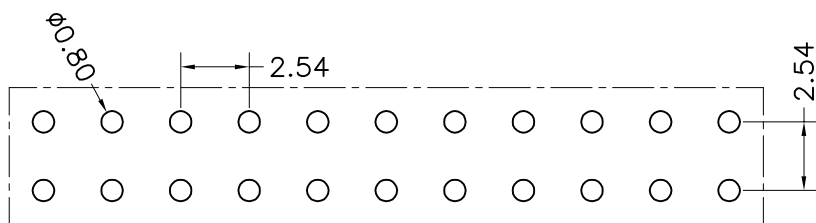
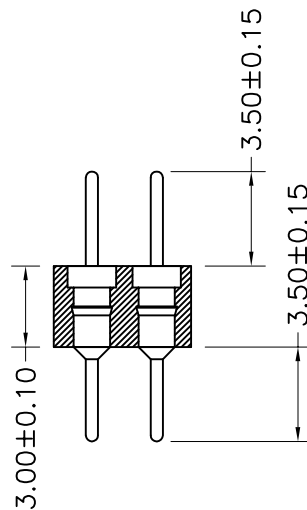
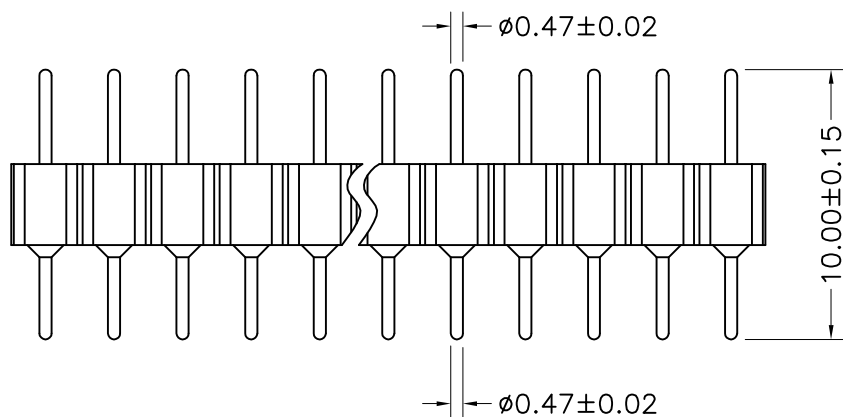
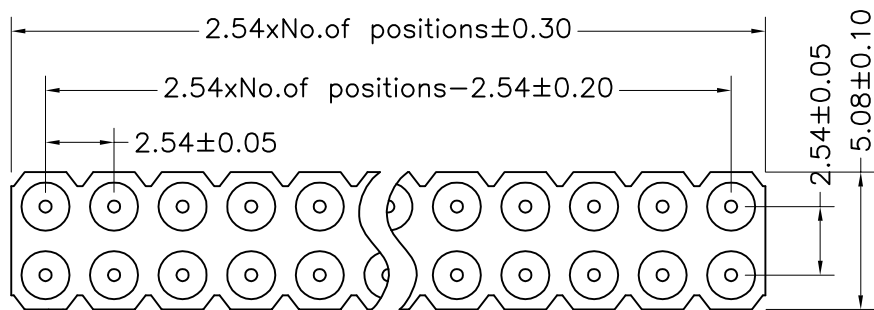

P. C. B LAYOUT

Technical Data

Material:

Pin(outer sleeve):Brass,machined CuZn38Pb2

Plating(outer sleeve):

Tin Plated:2 μ m/80 μ "NI, 5 μ m/200 μ "Sn

Gold Plated:2 μ m"/80 μ "Ni, 0.8 μ " gold

Insuiator:PPS UL94V-0

Electrical:

Current rating:3Amps/contact max.

Contact resistance: $\leq 4m\Omega$ /contact

Insuiation resistance: $\geq 1000M\Omega$ at V=100V

Dlelectric Withstanding Voltage:1000V AV Min

Operaling voitage:60VAC/DC

Mechanical:

Operaling temperature:-40° C to+105° C

Soldering temperature:+255° C

TOLERANCE UNLESS OTHERWISE

| | | | |
|------|------------|-------|-----------------|
| X. | ± 0.30 | X° | $\pm 5^\circ$ |
| .X | ± 0.20 | .X° | $\pm 2^\circ$ |
| .XX | ± 0.08 | .XX° | $\pm 1^\circ$ |
| .XXX | ± 0.03 | .XXX° | $\pm 0.5^\circ$ |

| | |
|-------|--------|
| DRAWN | CK tan |
| CHKD | |
| APPD | |
| VIEW | |

XFCN 兴飞连接器有限公司
XFCN CONNECTORS CO.,LTD.

| | |
|--------------|----------------------------|
| PRODUCT NAME | 2.54mm Machined Pin Header |
| PART. NO. | MH254V-12-xx-1000-047 |

| | |
|----------|------------|
| SHEET | 1/1 |
| DATE | 2020.04.12 |
| UNITS | mm |
| SCALE | 1:1 |
| DWG. NO. | 009 |

AO
VER

MODIFICATION

DRAW

DATE

1 2 3 4 5 6 7 8 9 10

X-ON Electronics

Largest Supplier of Electrical and Electronic Components

Click to view similar products for [Headers & Wire Housings](#) category:

Click to view products by [XFCN](#) manufacturer:

Other Similar products are found below :

[0015917161](#) [0022155065](#) [57102-F02-18ULF](#) [58102-G61-06LF](#) [582553-1](#) [01.001.5753.1](#) [0050291907](#) [02.125.8002.8](#) [609-3404](#) [61062-3](#)
[CSU011177004](#) [622-0430](#) [622-3653LF](#) [63453-116](#) [636-1030](#) [636-1427](#) [636-3427](#) [636-4007](#) [641938-9](#) [65495-038](#) [65692-001LF](#) [65781-018](#)
[65781-047](#) [65817-010LF](#) [65817-015LF](#) [67095-007LF](#) [67601157](#) [68631-112](#) [68645-018](#) [699319-000](#) [70.362.1628.0](#) [70-4210](#) [70-4226B](#) [70-](#)
[4853B](#) [71.350.2428.0](#) [733-134](#) [733-162](#) [760-3052](#) [MHR-64-VUAL](#) [80.063.4001.1](#) [800-90-001-10-001000](#) [801-43-002-10-013000](#)
[801-43-006-10-002000](#) [803-43-024-10-001000](#) [803-93-012-10-001000](#) [8-1437020-4](#) [819-22-004-30-001101](#) [820-22-006-30-001101](#)
[820-22-008-30-001101](#) [821-22-002-10-001101](#)