

- SPECIFICATIONS
- Voltage rating: 250V AC, DC
 - Current rating: 5A, AC, DC
 - Withstanding Voltage: 1500V AC/minute
 - Insulation resistance: 1000M Ω min
 - Temperature range: -25 $^{\circ}$ C+85 $^{\circ}$ C
 - Contact resistance: 20m Ω max
- HOUSING
- Poles : 02-20P
 - Housing Material: Nylon66 15%GF UL94V-0 Black
 - The Dimension Marked "▲" Must Be Recorded

LATCH AND POLARIZATION
RIB LOCATION

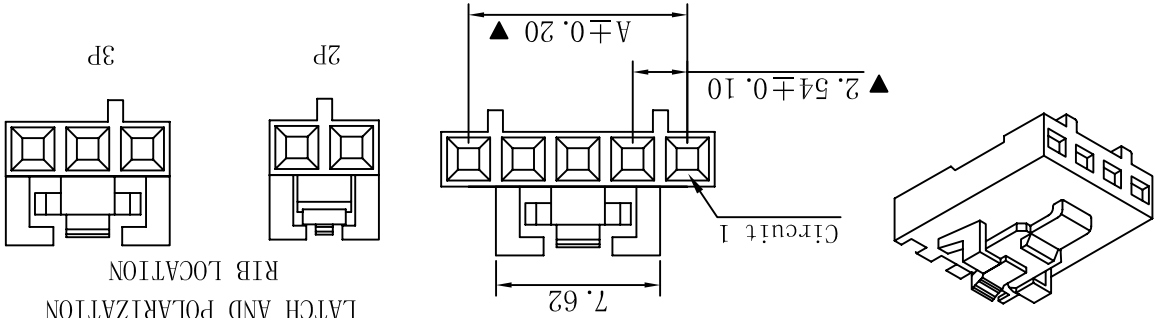

PART NO.	Dimensions (mm)	
	A	B
02	2.54	5.08
03	5.08	7.62
04	7.62	10.16
05	10.16	12.70
06	12.70	15.24
07	15.24	17.78
08	17.78	20.32
09	20.32	22.86
10	22.86	25.40
11	25.40	27.94
12	27.94	30.48
13	30.48	33.02
14	33.02	35.56
15	35.56	38.10
16	38.10	40.64
17	40.64	43.18
18	43.18	45.72
19	45.72	48.26
20	48.26	50.80

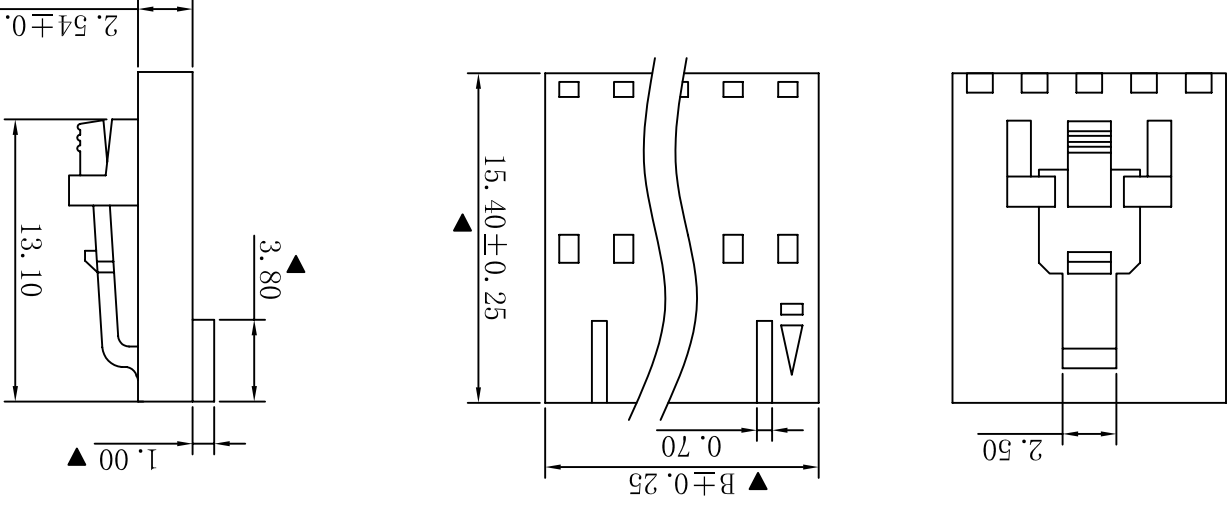

VER A0	MODIFICATION			DATE	XXX ±0.03	.XXX $^{\circ}$ ±0.5 $^{\circ}$	VIEW	VIEW	6
	DRAWN			DATE	.XX ±0.08	.X $^{\circ}$ ±1 $^{\circ}$	APPD	VIEW	5
	DRAWN			DATE	.X ±0.20	.X $^{\circ}$ ±5 $^{\circ}$	CHKD	VIEW	4
	DRAWN			DATE	X ±0.30	.X $^{\circ}$ ±5 $^{\circ}$	CHKD	VIEW	3
	DRAWN			DATE	TOLERANCE UNLESS OTHERWISE		CK tan	VIEW	2
	DRAWN			DATE	TOLERANCE UNLESS OTHERWISE		CK tan	VIEW	1
PART. NO.		PRODUCT NAME		CONNECTIONS XFCN CONNECTORS CO., LTD.		XFCN 兴飞连接器有限公司		SHEET	
P2553-XX-BK		2.54mm Crimp Style Connectors		CONNECTORS XFCN CONNECTORS CO., LTD.		XFCN 兴飞连接器有限公司		1/1	
Dwg. No.		SCALE		UNITS		DATE		SHEET	
009		1:1		mm		2010.4.12		1/1	

X-ON Electronics

Largest Supplier of Electrical and Electronic Components

Click to view similar products for [Headers & Wire Housings](#) category:

Click to view products by [XFCN](#) manufacturer:

Other Similar products are found below :

[95000-104TRLF](#) [10135584-644402LF](#) [DF62W-EP2022PCA](#) [95000-106TRLF](#) [DF62W-2022SCA](#) [DF62W-EP2022PC](#) [2203348](#) [DF62W-2022SC](#) [1084018](#) [1029039](#) [1084017](#) [802-10-012-10-002000](#) [1112640](#) [1112639](#) [891-007-9SS-BST1T](#) [000-34000](#) [0008550134](#) [0009482033](#) [0009507031](#) [57102-F02-18ULF](#) [57102-S06-03LF](#) [57202-S52-04LF](#) [PCN6-15S-2.5E](#) [0039019024](#) [58102-G61-06LF](#) [582553-1](#) [0009485154](#) [0009508121](#) [0022285053](#) [0050291907](#) [018731A](#) [LY20-4P-DT1-P1E-BR](#) [02.125.8002.8](#) [60101931](#) [60598-1 \(Cut Strip\)](#) [M1625-3R/100](#) [61062-3](#) [61082-181009](#) [CSU011177004](#) [636-1427](#) [638009-1](#) [641938-9](#) [641991-4](#) [644168-1](#) [644827-2](#) [647662-1](#) [65039-019ELF](#) [65692-001LF](#) [65781-018](#) [65781-047](#)