

Recommended P.C.B Layout
P.C.B Board Tolerance±0.05

NOTES:

Voltage Rating:250V AC/DC
Current Rating:3.0A AC/DC
Dielectric Withstand Voltage:500V AC/minute
Contact Voltage:20M Max.
Insulation Voltage:1000M Min
Operation temperature:-40 °C to +105 °C
Insulator Material:Polyester.Ul94V-0
Contact Material:Brass
Contact Plating:AuorSn Plated on Nickel Overall

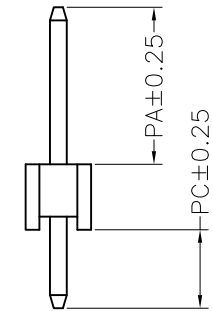
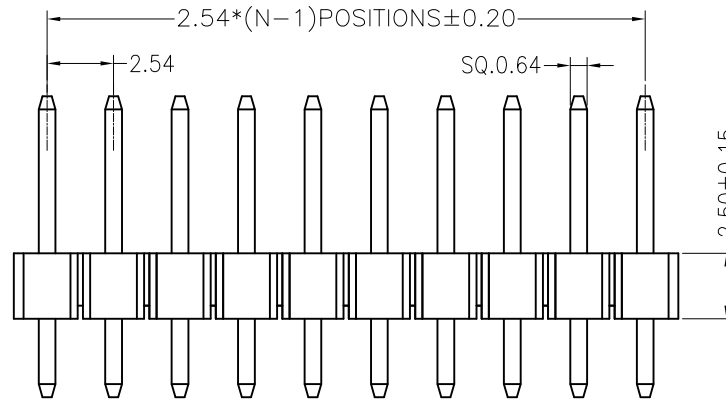
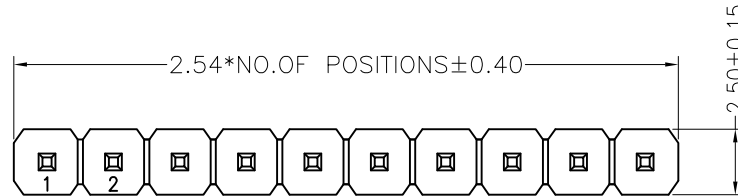
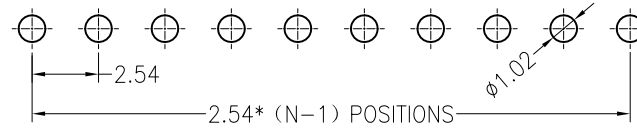

| | | | | |
|-------------|-----|-----|-----|------|
| 塑胶高度可选 (mm) | | | | 常用 |
| H | 1.0 | 1.5 | 2.0 | 2.54 |

| Dimension antitheses list | | | | |
|---------------------------|------|-----|------|-------|
| item | PA | --- | PC | L |
| Standard | 6.00 | --- | 3.00 | 11.50 |
| Alternate | --- | --- | --- | --- |

| | | | | | | | | | | | |
|----|--------------|--|--|----------------------------|------------|-------|---------------|--------------------------------------|------------------------------|---------|-------------|
| | | | | TOLERANCE UNLESS OTHERWISE | | DRAWN | CK tan | XFCN兴飞连接器有限公司 | | SHEET | 1/1 |
| | | | | X. | ± 0.30 | X° | $\pm 5^\circ$ | CONNECTORS XFCN CONNECTORS CO., LTD. | | DATE | 2010. 4. 12 |
| | | | | .X | ± 0.20 | .X° | $\pm 2^\circ$ | PRODUCT NAME | 2.54mm Pin Header Connectors | UNITS | mm |
| | | | | .XX | ± 0.08 | .XX° | $\pm 1^\circ$ | PART. NO. | PZ254V-11-XX | SCALE | 1:1 |
| AO | MODIFICATION | | | DRAW | DATE | .XXX | ± 0.03 | VIEW | | DWG NO. | 009 |

X-ON Electronics

Largest Supplier of Electrical and Electronic Components

Click to view similar products for [Headers & Wire Housings](#) category:

Click to view products by [XFCN](#) manufacturer:

Other Similar products are found below :

[95000-104TRLF](#) [10135584-644402LF](#) [DF62W-EP2022PCA](#) [95000-106TRLF](#) [DF62W-2022SCA](#) [DF62W-EP2022PC](#) [2203348](#) [DF62W-2022SC](#) [1084018](#) [1029039](#) [1084017](#) [802-10-012-10-002000](#) [1112640](#) [1112639](#) [891-007-9SS-BST1T](#) [000-34000](#) [0008550134](#) [0009482033](#) [0009507031](#) [57102-F02-18ULF](#) [57102-S06-03LF](#) [57202-S52-04LF](#) [PCN6-15S-2.5E](#) [0039019024](#) [58102-G61-06LF](#) [582553-1](#) [0009485154](#) [0009508121](#) [009176003701906](#) [0022285053](#) [0050291907](#) [018731A](#) [LY20-4P-DT1-P1E-BR](#) [02.125.8002.8](#) [60101931](#) [60598-1 \(Cut Strip\)](#) [M1625-3R/100](#) [61062-3](#) [61082-181009](#) [CSU011177004](#) [636-1427](#) [638009-1](#) [641938-9](#) [641991-4](#) [644168-1](#) [644827-2](#) [647662-1](#) [65039-019ELF](#) [65692-001LF](#) [65781-018](#)