

1.View and size(视图及尺寸)

| Main technical indicators(主要技术指标) | |
|-----------------------------------|--|
| 1.Mating (插拔次数) | >3000 |
| 2.Working Temperature (温度) | -20~+120 °C |
| 3.IP Rating (防护级别) | IP50 |
| 5.盐雾 | 5% NaCl for 48 hours/5%NaCl雾气中 48小时 |
| 7.Diameter of socket end(插合端直径) | φ0.7 |
| 8.Testing Voltage (测试电压) | 1050V |
| 9.Working Voltage (工作电压) | 850V |
| 10.Rated Current (额定电流) | 6A |
| 11.Shell material(壳体材质) | PC/PSUshell and chuck nut/pin sleeve and middleware/聚碳酸酯/聚砜外壳和夹头螺母/插销套和中间件 |
| 12.Pin Material(插针材料) | Copper alloy gold plating(铜合金镀金) |
| 13.Insulator material(绝缘体材质) | L:PPS,P:PEEEK |
| 14.Nut color(螺帽颜色) | G=灰色/J=黄色/A=蓝色/N=黑色/R=红色/V=绿色/B=白色 |

| Sum up(总结) | |
|-----------------------------|---|
| Series(系列) | 0M |
| Shell style/model (外壳样式/型号) | LZAG: Straight plug, cable collet and nut for fitting a bend relief直塞、电缆夹头和螺母, 用于安装弯曲凸起 |
| Button (按键) | A button(一个按键) |
| Termination type (终止类型) | Male solder(公焊锡) |
| Line diameter awg(线材直径) | 26AWG-0.0AWG |
| Cable diameterφ (电缆直径) | φ6.1-φ6.5MM |
| Matching parts(配件) | PLG.M0.6GL.LX |

| Location pin combination(定位销组合) | | | |
|---------------------------------|-----------------------------------|-----------|---------------------|
| (编号) Number | Number of positioning pins(定位销数量) | Angle(角度) | Series(系列)-0M |
| G | One(1) | | (Zero degrees)0° |
| A | Two(2) | a | Thirty degrees(40°) |
| B | Two(2) | | Sixty degrees(60°) |
| C | Two(2) | | Ninety degrees(80°) |
| H | Two(2) | β | 135 degrees(170°) |
| J | Two(2) | | 145 degrees(205°) |

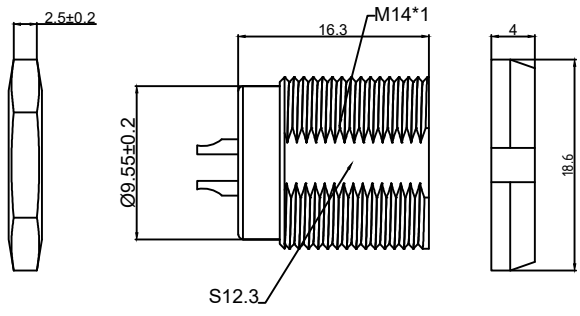

| | A | L | M |
|----|------|------|------|
| MM | 14 | 45.0 | 30 |
| in | 0.55 | 1.77 | 1.18 |

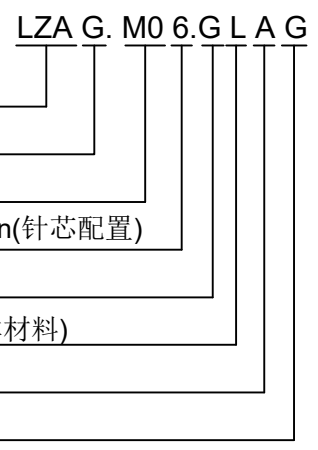
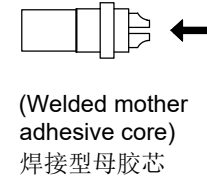
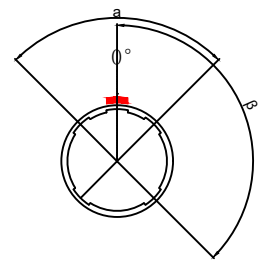
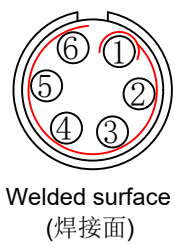

- Model(型号)
- Alignment pins(定位销)
- series(系列)
- Needle core configuration(针芯配置)
- Outer casing(外壳材料)
- Insulator material(绝缘体材料)
- Insulator(绝缘体)
- Nut color(螺帽颜色)

| | | | | |
|----------------------------------|----------|--------------------------------------|----------|--------------------------------------|
| DESIGNED(设计) | DATE(日期) | SCALE(比例) | N/A(不适用) | MODEL TYPE |
| CHECKED(校对) | DATE(日期) | VIEW(视图) | | 型号类型: LZAG. M06.GLAG |
| APPROVED(审核) | DATE(日期) | UNIT(单位) | MM | PART NO. 0M6-core plug 名称: 0M6芯插头 |
| REVISIONS | | MATERIAL (材料) | | DWG NO.: |
| www.helloxkb.com www.helloxkb.cn | | XKB INDUSTRIAL PRECISION CO.,LIMITED | | WEIGHT(重量) SHEET(表) REVISION(修订) |
| | | | | 1/1 A0 |

X-ON Electronics

Largest Supplier of Electrical and Electronic Components

Click to view similar products for [Standard Circular Connector](#) category:

Click to view products by [XKB](#) manufacturer:

Other Similar products are found below :

[600273N007](#) [6134-336-13149](#) [6134-337-11149](#) [6134-337-2390](#) [6134-341-17149](#) [67-02E12-60PX](#) [680-SMG](#) [CXS3102A181S](#)
[D38999/20FC8SA L/C](#) [75-190216-08S](#) [75-190611-03S](#) [75-474014-05S](#) [75-474618-04S](#) [75-474620-07P](#) [799539-000](#) [805-005-07NF11-19PC](#)
[805-005-07NF15-7PA](#) [FMP.2M.310.XLCT](#) [836783-1](#) [862256-1](#) [866857-1](#) [867865-1](#) [PT08P-14-19S](#) [PT08P-14-5S](#) [QCM019PC2DC012B](#)
[121583-0217](#) [121667-0020](#) [RD10A16-19-P6CS051/1](#) [RD16A14-12-S6CS051/2](#) [1301240268](#) [1301240275](#) [1301860906](#) [DCU-08BFEA-](#)
[LL7001](#) [RM15WTP-CP\(5\)\(71\)](#) [14482](#) [16283-18](#) [1877910-1](#) [206039-3](#) [206323-1](#) [207002-2](#) [207682-1](#) [CA06COME14SA7P](#) [211777-1](#) [JL04-](#)
[1012CK\(05\)-R](#) [JL04V-2A28-11PE-R](#) [JL04V-2E10SL-3PE-B-R](#) [JL04V-2E20-15PE-B-R](#) [JL04V-2E20-4PE-B-R](#) [JL04V-2E24-10PE\(G\)-B-R](#)
[JL04V-6A24-11SE-EB-R](#)