

Circuit Diagram □:Terminal No.

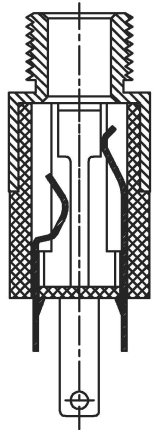

Matching Plug

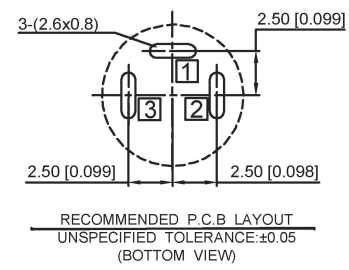
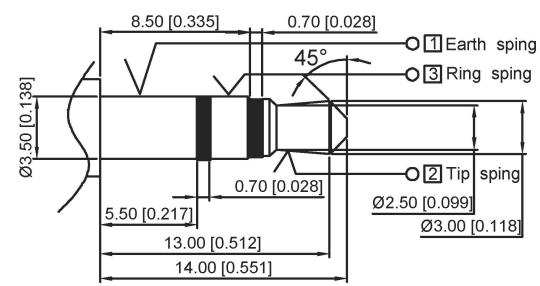

RECOMMENDED P.C.B LAYOUT
UNSPECIFIED TOLERANCE:±0.05
(BOTTOM VIEW)

CODE	PLATING
-B	Bushing&Nut (Ni Plated) Terminal (Ag Plated)
-D	Bushing&Nut (Ni Plated) Terminal (Au Plated)
-F	Bushing&Nut (Au Plated) Terminal (Au Plated)

Specification:

- 1.Rating: DC 30V 0.5A.
2. Contact resistance: ≤30mΩ
After test: ≤50mΩ.
3. Insulation resistance: ≥100mΩ (500VDC).
After test: ≥50mΩ.
4. Withstanding voltage: 500vac.
5. Insertion and extraction force: 3N~30N.
6. life test: 5000cycles min.
7. Operation temperature range: -20℃ + 70℃.
8. Preservative temperature range: -40℃ + 85℃.
9. Significance is importance dimension.

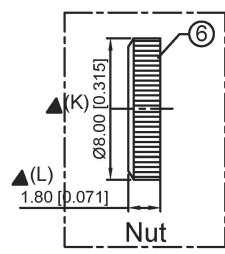

	MATERIAL	PLATING
terminal 1	Phosphor Bronze	tin
terminal 2	Phosphor Bronze	tin
terminal 3	Phosphor Bronze	tin
plastic	Pbt	

广东星坤科技股份有限公司

生	日期
效	日期
Δx	
Δx	
Δx	
MARK	DESCRIPTION
文件	工程

MARK	DESCRIPTION	DATE	REVISED	APPROVED	UNSPECIFIED TOLERANCES
					ANGLAR ±5°
					L ≤ 4 ±0.2
					4 < L ≤ 16 ±0.3
					16 < L ≤ 63 ±0.4
					L > 63 ±0.5

DSND	DATE	SCALE: N/A	MODEL TYPE:
DWN	DATE	VIEW:	3.5 PHONE JACK
CHKD	DATE	UNIT: mm/in	PART NO.:
APPD	DATE	SIZE: A4	DWG NO.: PJ-392W-X
XKB INDUSTRIAL PRECISION CO., LIMITED			WEIGHT 1.0g
			SHEET 1/1
			REVISION A0

X-ON Electronics

Largest Supplier of Electrical and Electronic Components

Click to view similar products for [HDMI, Displayport & DVI Connectors](#) category:

Click to view products by [XKB](#) manufacturer:

Other Similar products are found below :

[30-1231](#) [30-528](#) [30-504](#) [30-519](#) [33DVIR-24S1B](#) [47648-2000](#) [2002-400](#) [TC142X](#) [769-103/021-000](#) [1932649-1](#) [CP30200GM3](#) [67881](#)
[HBLBH](#) [HBLBI](#) [HAFBG](#) [HAFBH](#) [HAGBF](#) [HAGBG](#) [HAGBJ](#) [HBLBJ](#) [AABIE](#) [AABIF](#) [AABIG](#) [AABIH](#) [AABIJ](#) [AABIK](#) [AACBE](#)
[AACBF](#) [AACBG](#) [ABIBF](#) [ABIBG](#) [ABIBH](#) [AACBH](#) [AACBI](#) [AACBJ](#) [AACBK](#) [AACBL](#) [AAIBD](#) [AAIBF](#) [AAIBI](#) [AANBJ](#) [AAQBH](#)
[AAQBI](#) [AARBG](#) [AARBH](#) [AARBI](#) [AAXBD](#) [ABA AF](#) [ABBBF](#) [AIDB0](#)