

RECOMMENDED PCB LAYOUT TOP VIEW
(COMPONENT SIDE TOLERANCE±0.05)

Pin #	INTERNAL NAME	DESCRIPTION	WIRING CONNECTION
1	LVDT	POWER	POWER
2	S	SHIELD PAIR	SHIELD
3	S	DIFFERENTIAL PAIR	DATA
4	SHIELD	GROUND FOR POWER RETURN	GROUND
5	SHIELD	DIFFERENTIAL PAIR	DATA
6	SHIELD	GROUND FOR SIGNAL RETURN	GROUND
7	SHIELD	DIFFERENTIAL PAIR	DATA
8	SHIELD	GROUND FOR SIGNAL RETURN	GROUND
9	SHIELD	DIFFERENTIAL PAIR	DATA
Shield	Shield	CONNECTOR METAL SHELL	FRAME

Material
Housing Material: PBT, UL94V-0, blue
Contact Terminal: Copper Alloy
Metallic Shell: SPCC/BRASS
Plating
Underplating: Nickel
Contact Plating: 1µ" Gold
Solder Tail: 100µ" Min. Tin
Metallic Shell: Nickel

Electrical
Voltage Rating: 100 V AC
Current Rating: 0.25A (Signal pins 2,3,5,6,7,8,9) 1.8A (Power Pins 1,4)
Contact Resistance: 30mΩ Max.
Insulation resistance: 1000MΩ Min.
Dielectric withstanding voltage: 100V AC/minute
Mechanical
Durability: 5000 cycles
Mating Force: 35N (3.57Kgf) Max
Unmating Force: 10N (1.02kgf) Min. initial, 8N min after test
Environmental and Processing
Operating Temperature: -40°C to +85°C

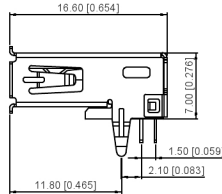
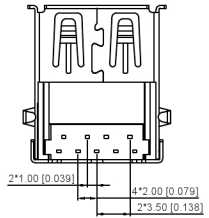
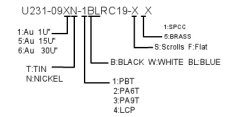

广东星坤科技股份有限公司

生	日期
发	
Δ	
MADE IN CHINA	文件工程章

REVISIONS	DATE	REVISED	APPROVED	UNSPECIFIED TOLERANCES
				ANGULAR ±5° L ≤ 4 ±0.2 4 < L ≤ 16 ±0.3 16 < L ≤ 63 ±0.4 L > 63 ±0.5

DSND	DATE	SCALE: NA	MODEL TYPE: USB 3.0
DWNN	DATE	VIEW:	PART NO.:
CHKD	DATE	UNIT: mm/in	DWG NO.: U231-09XN-1BLRC19-SX
APPD	DATE	SIZE: A4	WEIGHT SHEET REVISION 1.0g 1/1 A0

XKB INDUSTRIAL PRECISION CO., LIMITED

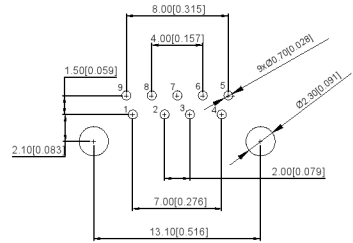
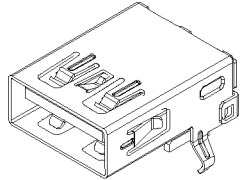
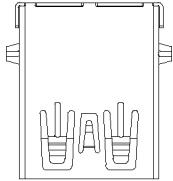

RECOMMENDER PCB LAYOUT TOP VIEW
(COMPONENT SIDE TOLERANCE±0.05)

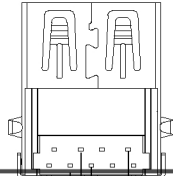
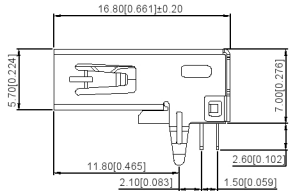
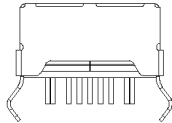
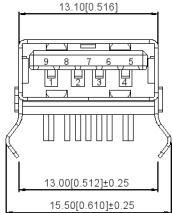

Material
Housing Material: PBT, UL94V-0, blue
Contact Terminal: Copper Alloy
Metalic Shell:SPCC/BRASS
Plating
Underplating: Nickel
Contact Plating: 1µ" Gold
Solder Tail: 100µ" Min. Tin
Metalic Shell: Nickel
Electrical
Voltage Rating: 100 V AC
Current Rating: 0.25A (Signal pins 2,3,5,6,7,8,9) 1.8A (Power Pins 1,4)
Contact Resistance: 30mΩ Max.
Insulation resistance: 1000MΩ Min.
Dielectric withstanding voltage: 100V AC/minute
Mechanical
Durability: 5000 cycles
Mating Force: 35N (3.57Kgf) Max
Unmating Force: 10N (1.02kgf) Min. initial, 8N min after test
Environmental and Processing
Operating Temperature: -40°C to +85°C

Pin #	EXTERNAL NAME	DESCRIPTION	MARKING
1	LEUT	POWER	1SPRC
2	D	DATA 2±	5BRASS
3	DS	DIFFERENTIAL PAIR	S-SCROLLS F-FLAT
4	END	GROUND FOR POWER RETURN	1PBT
5	DMA 15TV	SUPERVISED SIGNAL	2PAET
6	DMA 15TV	DIFFERENTIAL PAIR	3PAET
7	END_GROUND	GROUND FOR SIGNAL RETURN	4LCP
8	DMA 15TV	SUPERVISED TRANSMITTER	
9	DMA 15TV	DIFFERENTIAL PAIR	
Shell	Shell	CONNECTOR METAL SHELL	

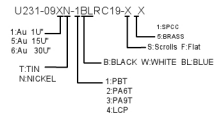

广东星科科技股份有限公司
100000391
4x2.00(0.079)

生	日期
發	
Δ	
MADE IN CHINA	
文件工程章	
REVISIONS	DATE REVISED APPROVED
www.xkpcb.com www.hellixkb.cn	

ANGLAR	±5°
L ≤ 4	±0.2
4 < L ≤ 16	±0.3
16 < L ≤ 63	±0.4
L > 63	±0.5

UNSPECIFIED TOLERANCES

DSND	DATE	SCALE: NA	MODEL TYPE: USB 3.0
DWN	DATE	VIEW:	PART NO.:
CHKD	DATE	UNIT: mm/in	DWG NO.: U231-09(XN)-1BLRC19-FX
APPD	DATE	SIZE: A4	WEIGHT 1.0g
XKB INDUSTRIAL PRECISION CO., LIMITED			SHEET 1/1
			REVISION A0

X-ON Electronics

Largest Supplier of Electrical and Electronic Components

Click to view similar products for [USB Connectors](#) category:

Click to view products by [XKB](#) manufacturer:

Other Similar products are found below :

[950](#) [A-USB B-TOP-C](#) [MUSBA511N5](#) [MUSBC111M5](#) [MUSBD11135](#) [17-200721](#) [217450-1](#) [KMBVX-TH-5S-B30](#) [896-30-004-00-000000](#)
[KUSBX-AS2N-W](#) [KUSBX-SMT2AP1S-W30](#) [935](#) [957](#) [30-498-6](#) [SK-60A-2](#) [1734082-1](#) [30-1574](#) [30-470](#) [30-489](#) [30-541](#) [30-572-3](#) [A-USB](#)
[A-2P-C](#) [MIKROE-1451](#) [USBFTV2PEM2G](#) [USBFTVSCCG](#) [4689-1](#) [1-1734084-2](#) [MUSBC11135](#) [USBF21ZNSCC](#) [USBBFTV6ZC](#)
[MUSBB151341](#) [10135326-001LF](#) [M9177/3-1](#) [TJ-105](#) [USB-A-S-F-B-VT](#) [4198](#) [690-024-633-031](#) [UB-20PMFP-LC7001](#) [USBFTVC6MRG](#)
[UA-20BMFA-SL8001](#) [17-200011](#) [USBFTVC7ZC](#) [UB-20AFMM-LL7A01](#) [USBFTVC2MN](#) [CAP-WCCMLPB1](#) [1310-1031-01](#) [2041386-1](#)
[2274475-3](#) [UB-20BMFA-SL8001](#) [UB-20PMFP-SC8003](#)