

SECT B-B

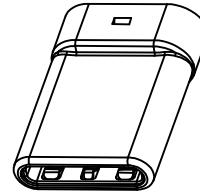

U261-24XN-4BS65-PC-1P

XKB CONNECTIVITY

P/N	R/C
U261-24XN-4BS65-PC-1P	

C TYPE PLUG:

- A1+A12+B1+B12 — GND
- A4+A9+B4+B9 — VCC
- A5 — A5(CC1)
- A6+B6 — A6+B6(D+)
- A7+B7 — A7+B7(D-)
- A8 — A8(SBU1)
- B5 — B5(CC2)
- B8 — B8(SBU2)

PCB:

- 1:Au1u"
- 2:Au3u"
- 4:Au15u"
- 5:Au30u"

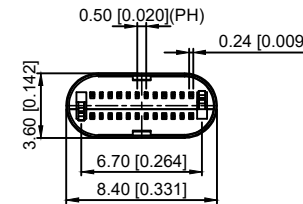
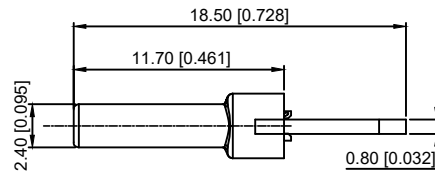
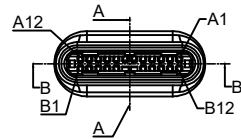

XKB CONNECTIVITY

REMARKS:

1.CONTACT INSERTION AND WITHDRAW FORCE:

- 1.Insertion force: 5N-20N max.
2. Withdrawal force: 8N-20N.
- 3.Durability : 10000Cycles.

2.ELECTRIC PROPERTY:

- 1.Contact current rating: 3A.
- 2.Dielectric Strength: 100V AC(RMS).
- 3.Insulation Resistance: 100 megaohms min.
- 4.Contact resistance: 40m0hms MAX.FOR VBUS,GND AND OTHER CONTACT
50m0hms MAX.AFTER ENVIRONMENT TEST

3.AMBIENT TEMPERATURE:

- 1.Operating temperature: -55°C to +85°C.

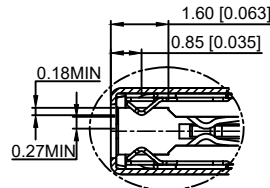
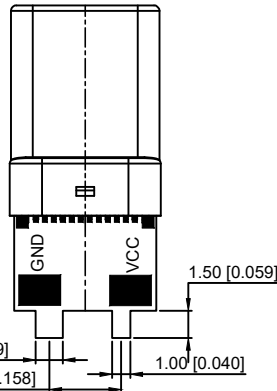

D
2:1

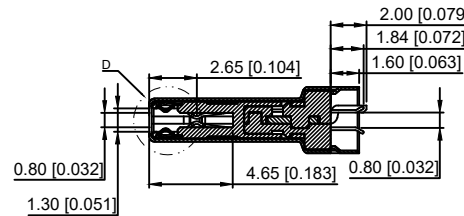

SECT A-A
XKB CONNECTIVITY

A12	A11	A10	A9	A8	A7	A6	A5	A4	A3	A2	A1
GND	RX2+	RX2-	Vbus	SBU1	D-	D+	CC	Vbus	TX1-	TX1+	GND
GND	TX2+	TX2-	Vbus	Vconn			SBU2	Vbus	RX1-	RX1+	GND
B1	B2	B3	B4	B5	B6	B7	B8	B9	B10	B11	B12

6	Shrapnel	SUS T=0.10mm	
5	Shell	SUS T=0.15mm	Ovep-plating: Ni
4	Terminal	C7025 T=0.15mm	Ovep-plating: Au Ni/Sn
3	Latch	SUS T=0.4mm	
2	Housing	LCP	UL94-0
1	Housing Stopper	LCP	UL94-0
ITEM	DESCRIPTION	MATERIAL	REMARKS

				ANGULAR		±5°		DSND		DATE		SCALE: N/A		MODEL TYPE: 3.1 TYPE C	
				L ≤ 4		±0.2		DWN		DATE		VIEW:		PART NO.:	
				4 < L ≤ 16		±0.3		CHKD		DATE		UNIT: mm/in		DWG NO.:	
				16 < L ≤ 63		±0.4		APPD		DATE		SIZE: A4		U261-24XN-4BS65-PC-1P	
				L > 63		±0.5						UNSPECIFIED TOLERANCES		WEIGHT	
								XKB INDUSTRIAL PRECISION CO., LIMITED				SHEET		REVISION	
												1.0g		1/1	
														A0	

X-ON Electronics

Largest Supplier of Electrical and Electronic Components

Click to view similar products for [USB Connectors](#) category:

Click to view products by [XKB](#) manufacturer:

Other Similar products are found below :

[950](#) [MUSBD11135](#) [17-200721](#) [217450-1](#) [KMBVX-TH-5S-B30](#) [KUSBX-AS2N-W](#) [KUSBX-SMT2AP1S-W30](#) [935](#) [957](#) [30-498-6](#) [SK-60A-2](#)
[1734082-1](#) [30-470](#) [30-489](#) [30-541](#) [A-USB A-2P-C](#) [MIKROE-1451](#) [USBFTVSCCG](#) [1-1734084-2](#) [10135326-001LF](#) [4198](#) [USB-A-D-VT](#)
[USB-A-S-RA-TSMT](#) [1310-1023-02](#) [690-024-633-031](#) [UB-20PMFP-LC7001](#) [17-200011](#) [UB-20AFMM-LL7A01](#) [1040870124](#) [CAP-](#)
[WCCMLPB1](#) [CAP-WCCMLPC1](#) [2274475-3](#) [UB-20BMFA-SL8001](#) [914-614A2025S10200](#) [USB3FTV7SAGF059](#) [ZX40-B-5S-1500-](#)
[STDA\(30\)](#) [GSB3116344HR](#) [USB3FTV2SAZNF459](#) [USB3FTV7SAZNF459](#) [U221-041N-1WVS62-F5D](#) [HYCW153-USBD05-500B](#)
[HYCW219-USBD05-075B](#) [HYCW148-USBD05-117B](#) [HYCW149-USBD05-740B](#) [HYCW204-USBD05-108B](#) [HYCW214-USBA04-113B](#)
[HYCW213-USBA04-113B](#) [UB-20AMFM-SL7A01](#) [KMMX-BSMT35S-1-B30TR](#) [2345986-1](#)