

Specifications:
 规格:
 Current rating:5A AC/DC
 额定电流: 5A AC/DC
 Withstanding voltage:500 AC/minute
 耐受电压: ≥500V AC/分钟
 Temperature range:-25℃--+85℃
 温度范围: -55℃--+85℃
 Insulation resistance:1000MΩMIN
 绝缘电阻: ≥1000MΩ
 Contact resistance:30mΩMAN
 接触电阻: ≤30mΩ
 Material:
 材料:
 Contacts:Brass Gold Plated
 接触: 黄铜镀金
 Insulator:PBT+30%
 绝缘体: PBT+30%
 Shell (Fead) :Spcc
 外壳: 铁

X04 XX W X X X X
 ① ② ③ ④ ⑤ ⑥ ⑦

- ① Series NO.
- ② Row No.Pin No.XX-09;15;25;37
- ③ Welding Board Angle :W-male
- ④ T: Tradutional C: Car-pin
- ⑤ Planting Category: 1:1U 2:2U 3:3U 4:5U 5:15U 6:30U 7 : AuSn
- ⑥ B:BLACK W:White BL:Blue Y:Yellow G:Green R:Red
- ⑦ 1:TYPE-1; 2:TYPE-2; 3:TYPE-3; 4:TYPE-4; 5:TYPE-5; 6:TYPE-6

TYPE-2加前铆 (不通孔)

TYPE-3加后铆 (通孔)

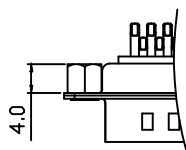
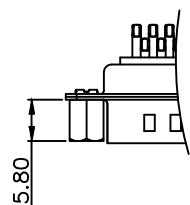

| NO.POS | A | B | C | D | E |
|--------|-------|-------|-------|-------|------|
| 15PIN | 16.92 | 24.99 | 30.80 | 19.00 | 2.29 |
| 26PIN | 25.25 | 33.32 | 39.20 | 27.65 | 2.29 |
| 44PIN | 38.96 | 47.04 | 53.10 | 41.20 | 2.29 |
| 62PIN | 55.42 | 63.50 | 69.40 | 57.44 | 2.29 |

| | | | | | |
|------|--|------|--|--------------------------------------|-------------|
| DSND | | DATE | | SCALE: N/A | MODEL TYPE: |
| DWN | | DATE | | VIEW: | PART NO.: |
| CHKD | | DATE | | UNIT: mm/in | DWG NO.: |
| APPD | | DATE | | SIZE: A4 | X04XXWXXXX |
| | | | | XKB INDUSTRIAL PRECISION CO.,LIMITED | WEIGHT |
| | | | | | SHEET |
| | | | | | REVISION |
| | | | | 1.0g | 1/1 |
| | | | | | A0 |

| MARK | DESCRIPTION | DATE | REVISED | APPROVED | units: mm | tolerance: |
|---|-------------|------|---------|----------|-----------|------------------------|
| Δx | | | | | X.X | ±0.2mm |
| Δx | | | | | X.XX | ±0.1mm |
| Δx | | | | | X.XXX | ±0.05mm |
| REVISIONS | | | | | | UNSPECIFIED TOLERANCES |
| www.xk-dg.cn www.helloxkb.com www.helloxkb.cn | | | | | | |

X-ON Electronics

Largest Supplier of Electrical and Electronic Components

Click to view similar products for [HDMI, Displayport & DVI Connectors](#) category:

Click to view products by [XKB](#) manufacturer:

Other Similar products are found below :

[30-1231](#) [30-528](#) [30-504](#) [30-519](#) [33DVIR-24S1B](#) [47648-2000](#) [2002-400](#) [TC142X](#) [769-103/021-000](#) [1932649-1](#) [CP30200GM3](#) [67881](#)
[HAFBF](#) [HBLBH](#) [HBLBI](#) [HAFBG](#) [HAFBH](#) [HAGBF](#) [HAGBG](#) [HAGBI](#) [HAGBJ](#) [HBLBJ](#) [AABIE](#) [AABIF](#) [AABIG](#) [AABIH](#) [AABII](#) [AABIJ](#)
[AABIK](#) [AABIL](#) [AACBE](#) [AACBF](#) [AACBG](#) [ABIBF](#) [ABIBG](#) [ABIBH](#) [42154](#) [AACBH](#) [AACBI](#) [AACBJ](#) [AACBK](#) [AACBL](#) [AAIBD](#) [AAIBF](#)
[AAIBH](#) [AAIBI](#) [AANBF](#) [AANBG](#) [AANBH](#) [AANBI](#)