

For and on behalf of
KXB INDUSTRIAL PRECISION CO., LIMITED
 香港星坤工業精密有限公司

| MARK | DESCRIPTION | DATE | REVISED | APPROVED | UNSPECIFIED TOLERANCES |
|------|-------------|------|---------|----------|------------------------|
| △ X | | | | | $L > \leq 63$ |
| △ X | | | | | $16 < L \leq 63$ |
| △ X | | | | | $4 < L \leq 16$ |
| △ X | | | | | $L \leq 4$ |
| | | | | | ANGULAR $\pm 5^\circ$ |

| REVISIONS | SIGNATURE(S) | |
|-----------|--------------|--|
| APPD | DATE | |
| CHKD | DATE | |
| DWN | DATE | |
| DSND | DATE | |

| | |
|-------------|------------|
| MODEL TYPE: | SCALE: N/A |
| PART NO.: | VIEW: |
| DWG NO.: | UNIT: mm |
| SIZE: A4 | |
| WEIGHT | 1.0g |
| SHEET | 1/1 |
| REVISION | A0 |

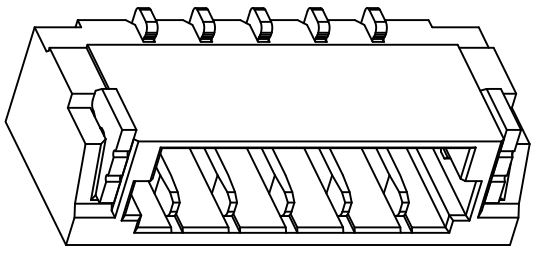
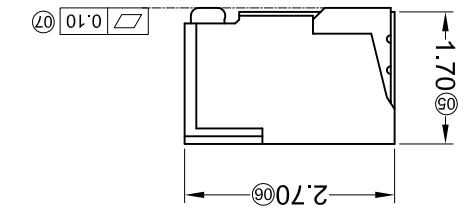
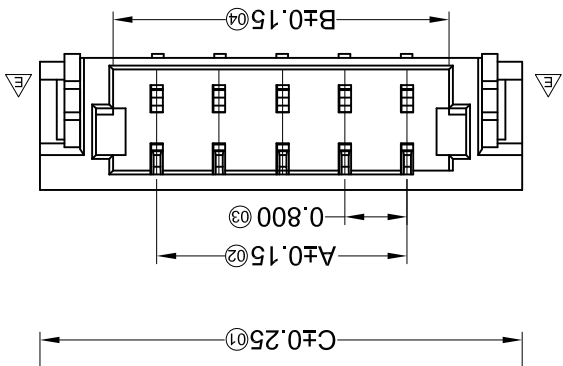
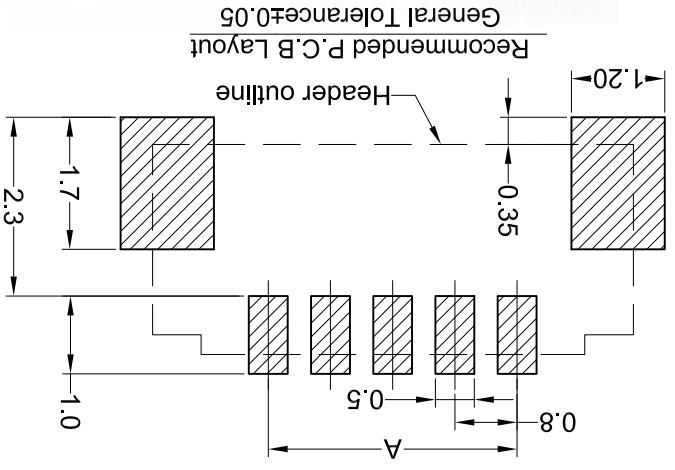

| PART NO | Material | Material(Pin) | Finish(Pin) | Material (Solder Tabs) | Finish (Solder Tabs) | Suitable XKB Terminal |
|-----------------------|----------------|-----------------|-------------|------------------------|----------------------|-----------------------|
| X0800WRS-XXHF-6TV01BK | (Halogen-free) | Phosphor Bronze | Gold-Flash | Brass | Gold-Flash | 0800H |
| X0800WRS-XXHF-6TV01 | (Halogen-free) | Phosphor Bronze | Gold-Flash | Brass | Gold-Flash | |
| X0800WRS-XXHF-LPV01 | Halogen-free | Phosphor Bronze | Gold-Flash | Brass | Tin-Plated | |
| X0800WRS-XXHF-LPSN | Halogen-free | Phosphor Bronze | Gold-Flash | Brass | Tin-Plated | |

| Poles | Dimensions(mm) | | |
|-------|----------------|------|-------|
| | A | B | C |
| 02 | 0.80 | 1.90 | 3.78 |
| 03 | 1.60 | 2.70 | 4.58 |
| 04 | 2.40 | 3.50 | 5.38 |
| 05 | 3.20 | 4.30 | 6.18 |
| 06 | 4.00 | 5.10 | 6.98 |
| 07 | 4.80 | 5.90 | 7.78 |
| 08 | 5.60 | 6.70 | 8.58 |
| 09 | 6.40 | 7.50 | 9.38 |
| 10 | 7.20 | 8.30 | 10.18 |
| 11 | 8.00 | 9.10 | 10.98 |

- Specifications :**
- Voltage rating: 30V AC / DC
 - Current rating: 0.5A AC / DC
 - Withstanding voltage: 200V AC/minute
 - Temperature range: $-25^\circ\text{C} \sim +85^\circ\text{C}$
 - Insulation resistance: $\geq 100\text{M}\Omega$
 - Contact resistance: $\leq 20\text{m}\Omega$
 - After environmental testing: $\leq 30\text{m}\Omega$
- ① Series No.
 ② Category: W-water
 ③ Welding Board Angle: R-90°
 ④ Welding Way: S-SMT
 ⑤ Row No.-Pin No. XX-XX-Single row
 ⑥ Plug the Pin & Special NO.: HF-Halogen free
 ⑦ Material: LP-LCP 94V-0; 6T-PA6T 94V-0
 ⑧ Plating Category: V01: All Gold-Flash;
 SN-Bright tin plating
 ⑨ Color: Blank-natural color; BK-black

X-ON Electronics

Largest Supplier of Electrical and Electronic Components

Click to view similar products for [Headers & Wire Housings](#) category:

Click to view products by [XKB](#) manufacturer:

Other Similar products are found below :

[95000-104TRLF](#) [10135584-644402LF](#) [DF62W-EP2022PCA](#) [95000-106TRLF](#) [DF62W-2022SCA](#) [DF62W-EP2022PC](#) [2203348](#) [DF62W-2022SC](#) [1084018](#) [1029039](#) [1084017](#) [802-10-012-10-002000](#) [1112640](#) [1112639](#) [891-007-9SS-BST1T](#) [000-34000](#) [0008550134](#) [0009482033](#) [0009507031](#) [57102-F02-18ULF](#) [57102-S06-03LF](#) [57202-S52-04LF](#) [PCN6-15S-2.5E](#) [0039019024](#) [58102-G61-06LF](#) [582553-1](#) [0009485154](#) [0009508121](#) [0022285053](#) [0050291907](#) [018731A](#) [LY20-4P-DT1-P1E-BR](#) [02.125.8002.8](#) [60101931](#) [60598-1 \(Cut Strip\)](#) [M1625-3R/100](#) [61062-3](#) [61082-181009](#) [CSU011177004](#) [636-1427](#) [638009-1](#) [641938-9](#) [641991-4](#) [644168-1](#) [644827-2](#) [647662-1](#) [65039-019ELF](#) [65692-001LF](#) [65781-018](#) [65781-047](#)